

GENERAL NOTES & SPECIFICATIONS:

1. ALL PLUMBING WORKS SHOULD BE UNDER THE DIRECT SUPERVISION OF A LICENSED MASTER PLUMBER.
2. ALL PLUMBING INSTALLATION SHOULD BE GOVERNED BY THE NATIONAL PLUMBING CODE OF THE PHILIPPINES AND EXISTING CITY OR LOCAL ORDINANCES.
3. NO SEPTIC VAULT SHALL BE INSTALLED WITHIN OR INSIDE THE BUILDING.
4. TANK MUST BE BUILT WATER TIGHT OF CONCRETE, STONE OR C.H.B..
5. BOTH COMPARTMENTS ARE PROVIDED WITH MANHOLE AND TIGHT COVER FOR CLEANING AND REPAIRS.
6. INLET AND OUTLET ARE SUBMERGED AND ARRANGED IN SUCH A WAY THAT NIETHER SLUDGE NOR SCUM BE UNDULY DISTURBED. BOTTOM OF THE TANK SHOULD HAVE A SLOPE OF 1:10 TOWARDS THE MANHOLE IN THE CENTER TO FACILITATE CLEANING.
7. NOT LESS THAN 0.20M. OF AIRSPACE SHOULD BE LEFT BETWEEN THE TOP OF THE SEWAGE AND THE UNDER PART OF THE TANK.

Plumbing Symbol

	Corner Bathtub		Urinal (Trough-Type)
	Recessed Bathtub		Drinking Fountain (Recessed)
	Sitz Bath		Drinking Fountain (Semi-Recessed)
	Bidet		Drinking Fountain (Projecting-Type)
	Shower Stall		Hot Water Tank
	Shower Head		Water Heater
	Overhead Gang Shower		Meter
	Pedestal Lavatory		Hose Rack
	Wall Lavatory		Hose Bibb
	Corner Lavatory		Gas Outlet
	Handicapped Lavatory		Vacuum Outlet
	Dental Lavatory		Drain
	Standard Kitchen Sink		Grease Separator
	Kitchen Sink, R & L Drain Board		Oil Separator
	Kitchen Sink, L & H Drain Board		Cleanout
	Combination Sink & Dishwasher		Garage Drain
	Combination Sink & Laundry Tray		Floor Drain with Backwater Valve
	Service Sink		Roof Sump
	Wash Sink (Wall-Type)		Shut-off Valve
	Wash Sink		Riser
	Laundry Tray (Single)		Gate Valve
	Laundry Tray (Double)		Check Valve
	Water Closet (Tank-Type)		Hose Bibb
	Water Closet (Integral Tank)		VS / VTW 3" PVC Pipe Series 1000
	Water Closet (Flush Valve, Floor Outlet)		SP 4" PVC Pipe Series 1000
	Water Closet (Flush Valve, Wall-Hung)		Grease Trap
	Urinal (Wall-Hung)		Catch Basin
	Urinal (Stall)		

REPUBLIC OF THE PHILIPPINES
OFFICE OF THE BUILDING OFFICIAL
VILLANUEVA, MISAMIS ORIENTAL

APPROVED BY:

VS	Vent Stack
SS	Soil Stack
WS	Waste Stack
SV	Septic Vault
fd	Floor Drain
GD	Gutter Drain
DD	Deck Drain
wc	Deck Drain
lav	Lavatory
uri	Urinal
ks	Kitchen Sink
cco	Ceiling Cleanout
fco	Floor Cleanout
co	Cleanout

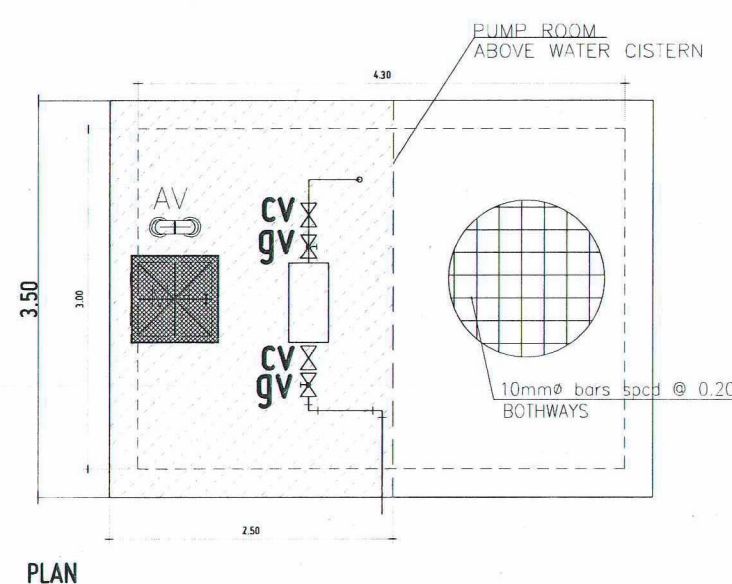

PLAN

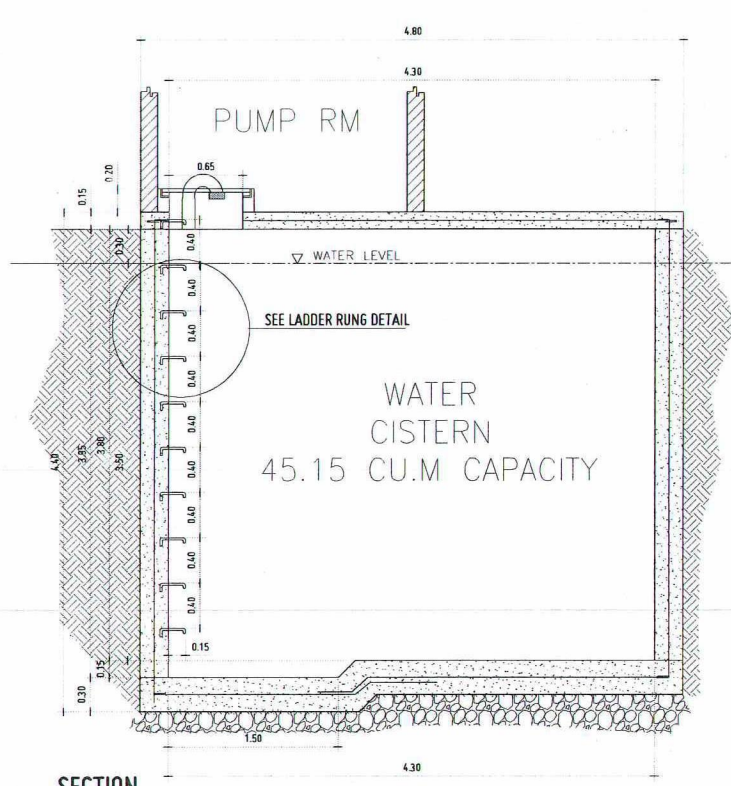

SECTION

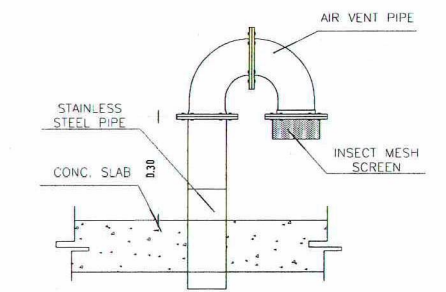

AIR VENT PIPE DETAIL
SCALE: 1:10 MTS

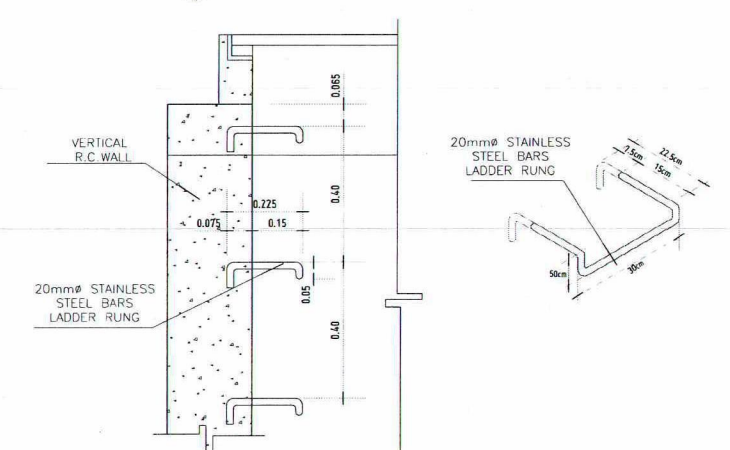

LADDER RUNG DETAIL
SCALE: 1:10 MTS



VICINITY MAP
SCALE: NTS

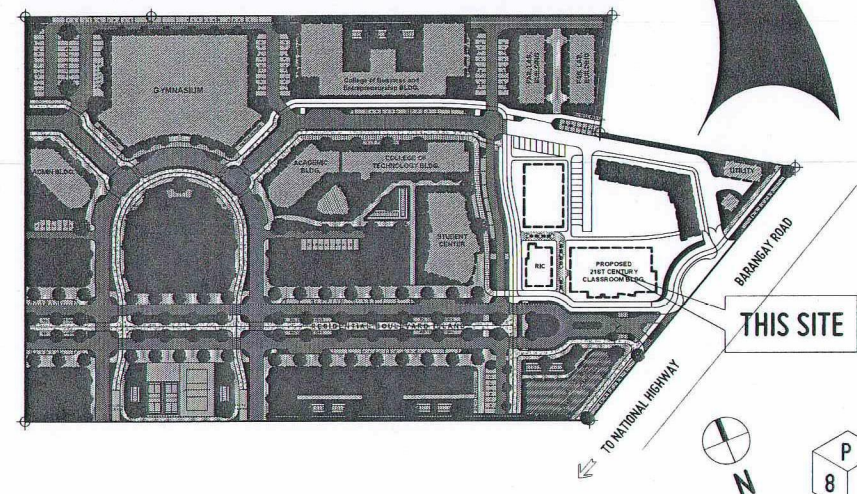

LOCATION PLAN
SCALE: 1:1500 MTS

WATER CISTERN DETAIL
SCALE: 1:30 MTS

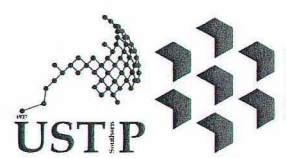

REPUBLIC OF THE PHILIPPINES
UNIVERSITY OF SCIENCE AND TECHNOLOGY OF SOUTHERN PHILIPPINES
CAGAYAN DE ORO CAMPUS
INFRASTRUCTURE PLANNING AND FACILITY DEVELOPMENT UNIT
CLARO M. RECTO AVENUE, LAPASAN, CAGAYAN DE ORO CITY 9000
TELEPHONE N (0822) 72-66-65 / (080) 856-1738 / 856-1739 | TELE FAX (080) 856-4896
WEBSITE: www.ustp.edu.ph

MASTER PLUMBER	
PRC NO.:	FTR NO.:
DATE:	PLACE:
TIN NO.:	

PROJECT	CONSTRUCTION OF 21ST CENTURY CLASSROOM BUILDINGS PHASE III, VILLANUEVA CAMPUS
LOCATION	USTP VILLANUEVA CAMPUS, MISAMIS ORIENTAL
OWNER	UNIVERSITY OF SCIENCE AND TECHNOLOGY OF SOUTHERN PHILIPPINES

RECOMMENDING APPROVAL:
ENGR. GRACE C. BABA
DIRECTOR, IPFDO

RECOMMENDING APPROVAL:
ATTY. ERWIN B. BUCIO
VP FOR ADMINISTRATION & LEGAL AFFAIRS

APPROVED BY:
DR. AMBROSIO B. CULTURA II
PRESIDENT, USTP SYSTEM

SHEET CONTENTS:
VICINITY MAP
LOCATION PLAN
WATER CISTERN DETAILS
AIRVENT DETAILS
LADDER RUNG DETAILS

DRAWN BY:
DATE DRAWN:
FNT:

P8

APPROVED BY:

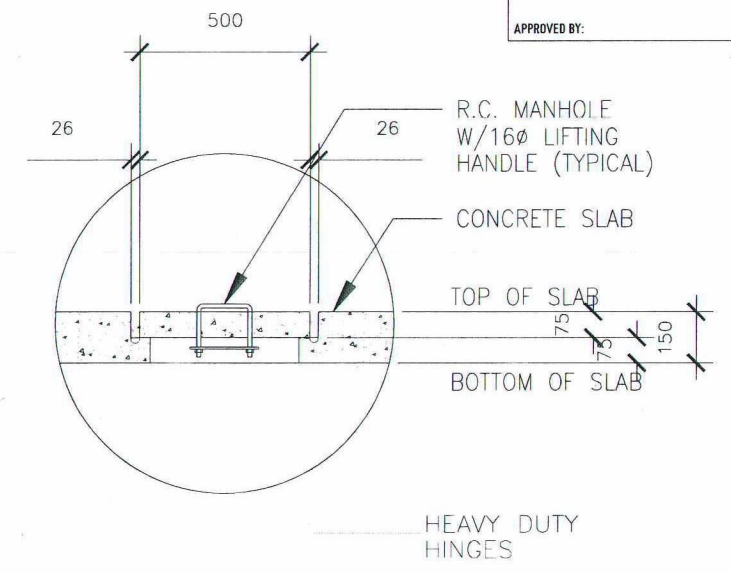

P 9 2 **BLOW-UP DETAIL MANHOLE**
SCALE: 1:10 MTS

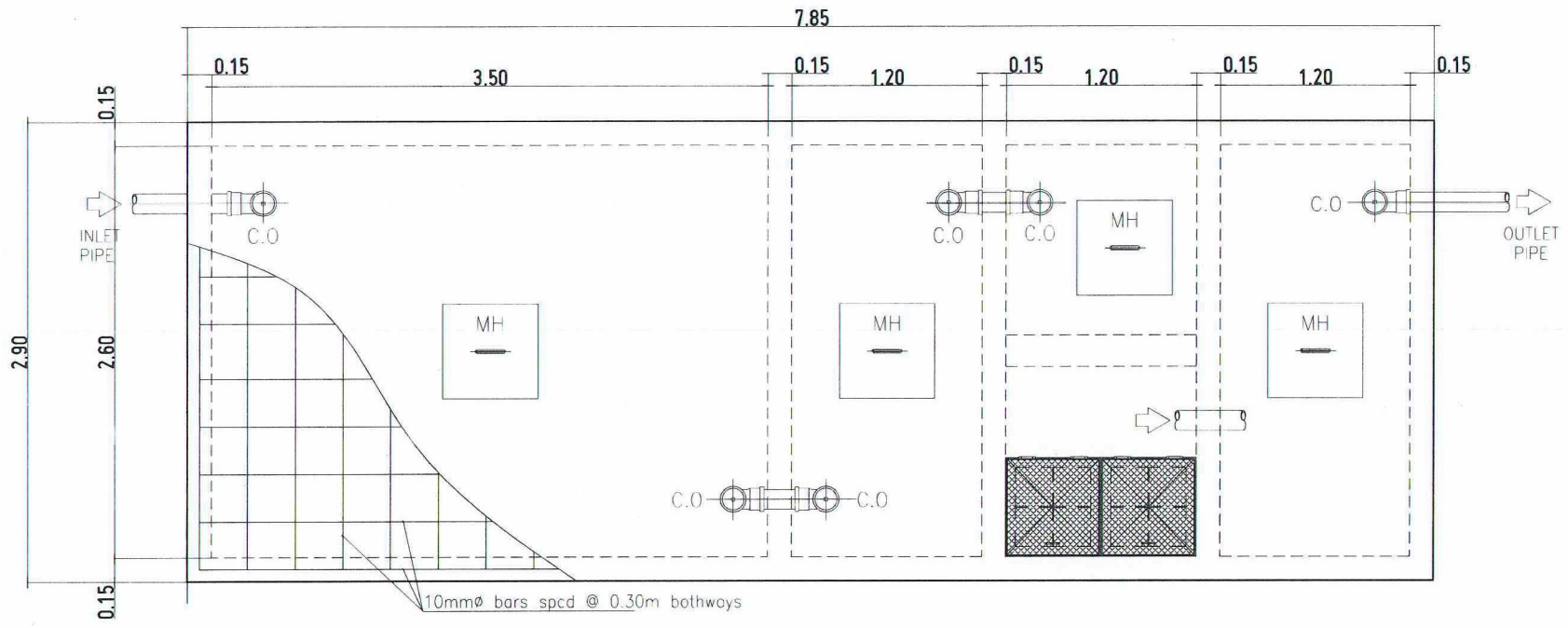

PLAN

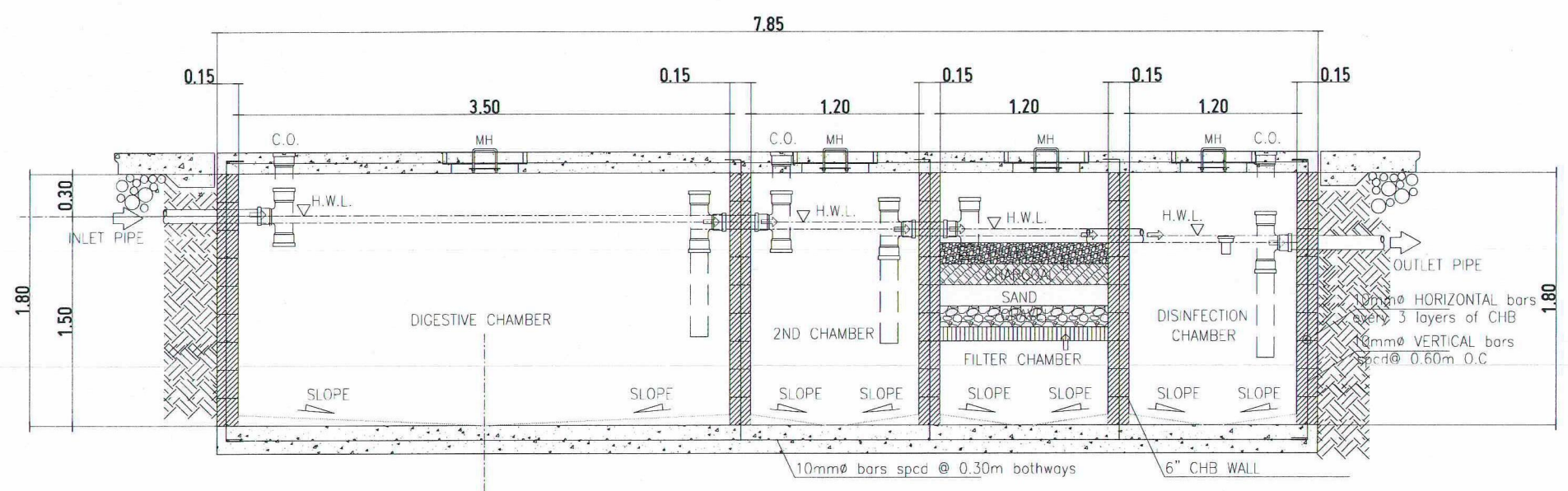

LONGITUDINAL SECTION

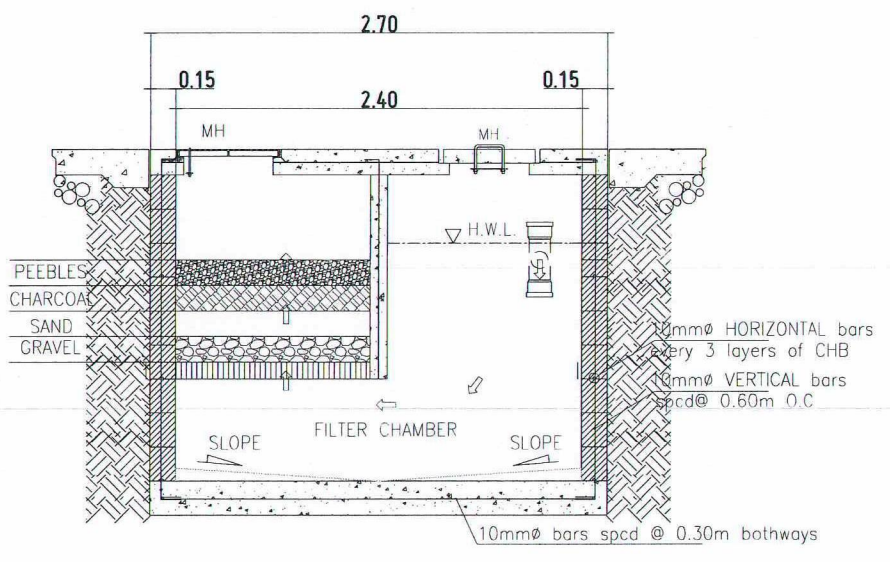

CROSS SECTION

P 9 1 **SEPTIC VAULT DETAIL**
SCALE: 1:20 MTS

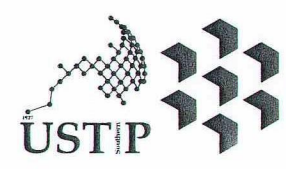

REPUBLIC OF THE PHILIPPINES
UNIVERSITY OF SCIENCE AND TECHNOLOGY OF SOUTHERN PHILIPPINES
CAGAYAN DE ORO CAMPUS
INFRASTRUCTURE PLANNING AND FACILITY DEVELOPMENT UNIT
CLARO M. RECTO AVENUE, LAPASAN, CAGAYAN DE ORO CITY 9000
TELEPHONE # (08222) 72-69-65 / (088) 856-1738 / 856-1739 | TELE FAX (088) 856-4696
WEBSITE: www.ustp.edu.ph

MASTER PLUMBER	
PRE NO.:	PTR NO.:
DATE:	PLACE:
TIN NO.:	

PROJECT	CONSTRUCTION OF 21ST CENTURY CLASSROOM BUILDINGS PHASE III, VILLANUEVA CAMPUS
LOCATION	USTP VILLANUEVA CAMPUS, MISAMIS ORIENTAL
OWNER	UNIVERSITY OF SCIENCE AND TECHNOLOGY OF SOUTHERN PHILIPPINES

RECOMMENDING APPROVAL:
Grace C. Baba
ENGR. GRACE C. BABA
DIRECTOR, IPFDO

RECOMMENDING APPROVAL:
Erwin B. Bucio
ATTY. ERWIN B. BUCIO
VP FOR ADMINISTRATION & LEGAL AFFAIRS

APPROVED BY:
Ambrosio B. Cultura II
DR. AMBROSIO B. CULTURA II
PRESIDENT, USTP SYSTEM

SHEET CONTENTS:
SEPTIC VAULT DETAILS
FLOOR PLAN
LONGITUDINAL SECTION DETAIL
CROSS SECTION DETAIL
MANHOLE BLOW-UP DETAIL

DRAWN BY:
DATE DRAWN:
PNT:

APPROVED BY:

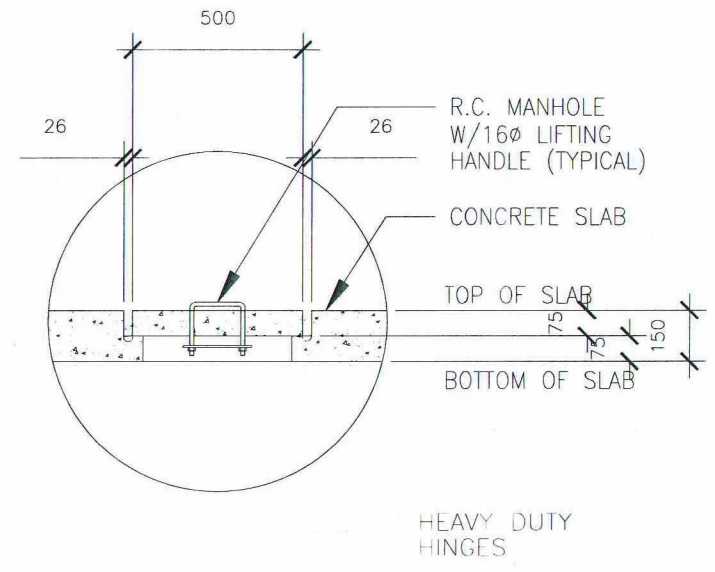
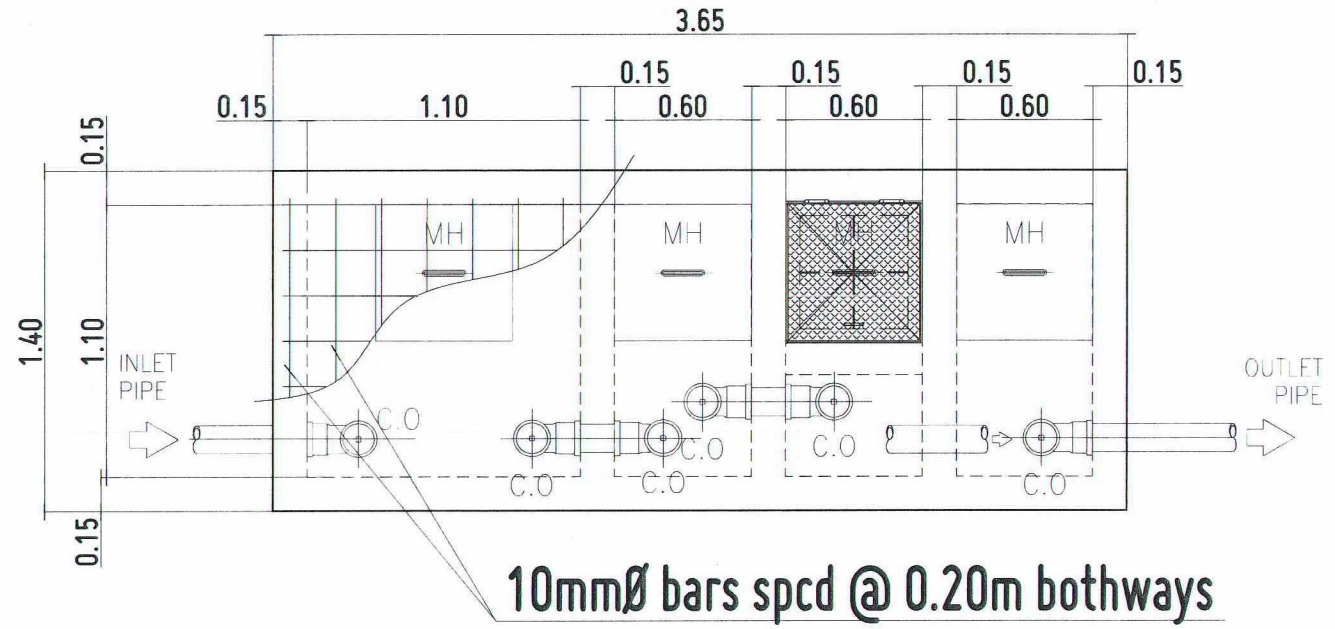

P
9 2

BLOW-UP DETAIL MANHOLE

SCALE: 1:10 MTS

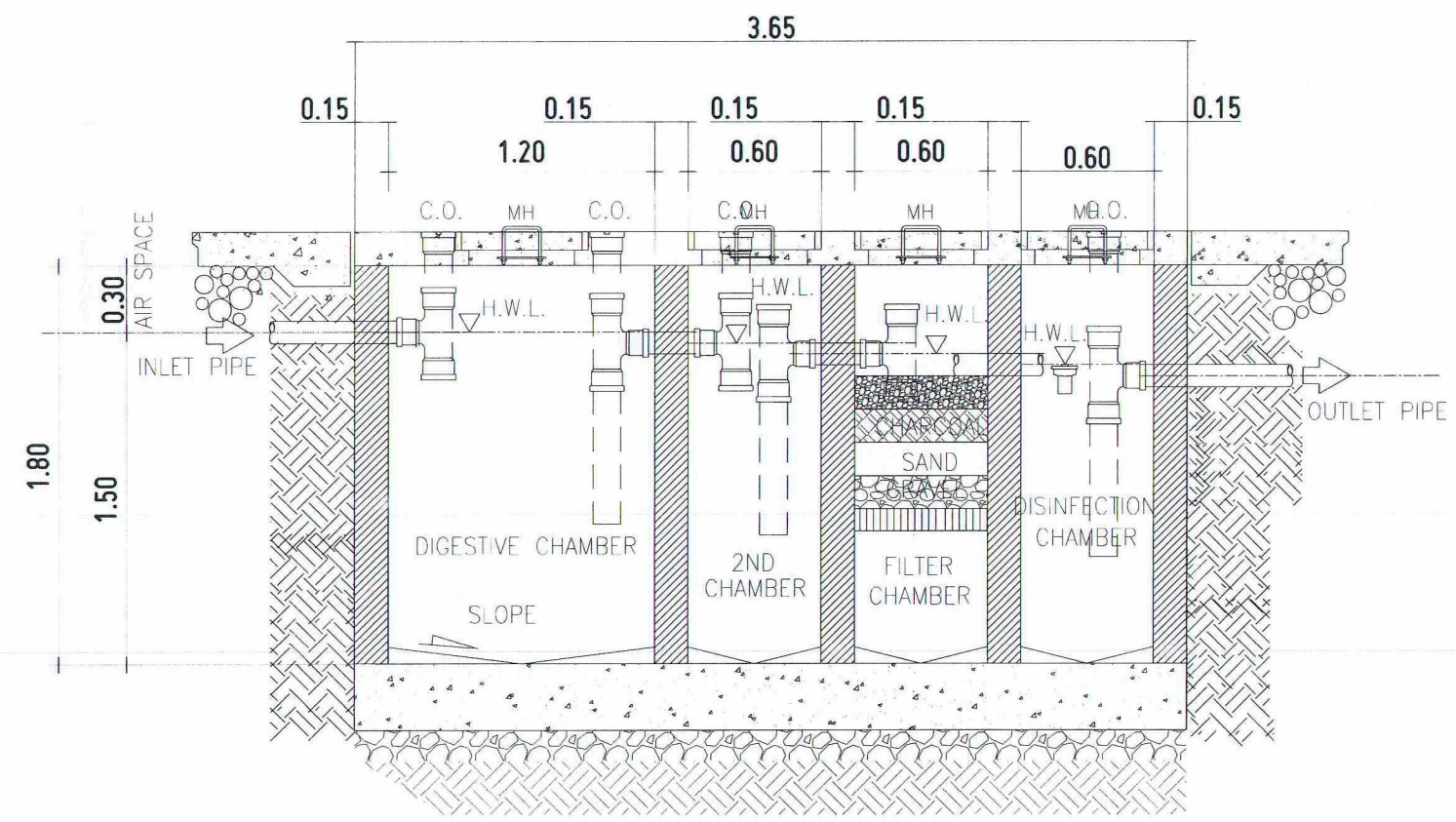

LONGITUDINAL SECTION

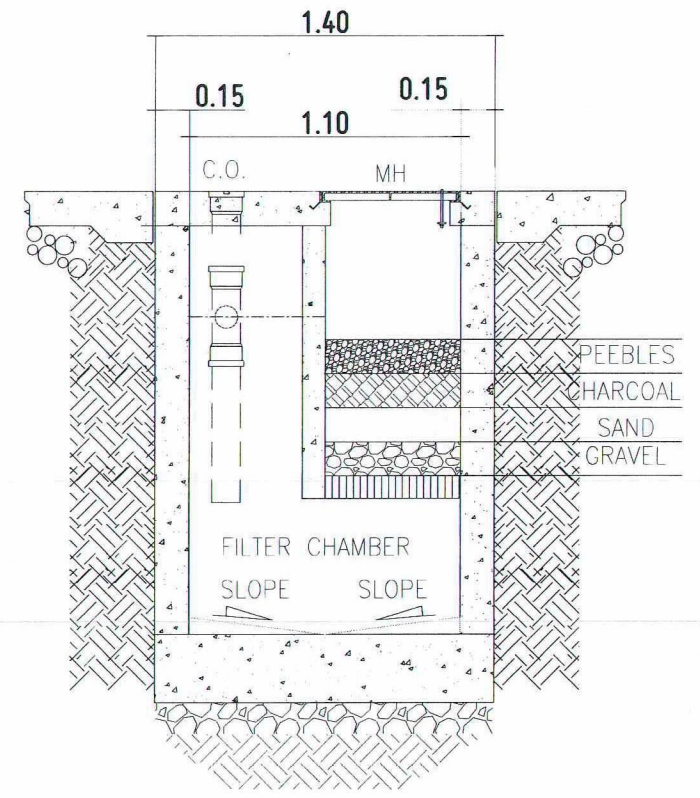

CROSS SECTION

P
10 1

SEPTIC VAULT - 2 DETAIL

SCALE: 1:20 MTS

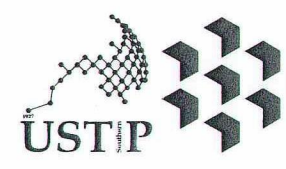

REPUBLIC OF THE PHILIPPINES
UNIVERSITY OF SCIENCE AND TECHNOLOGY OF SOUTHERN PHILIPPINES
CAGAYAN DE ORO CAMPUS
INFRASTRUCTURE PLANNING AND FACILITY DEVELOPMENT UNIT
CLARO M. RECTO AVENUE, LAPASAN, CAGAYAN DE ORO CITY 9000
TELEPHONE # (08222) 72-69-65 / (080) 856-1730 / 856-1739 | TELE FAX (080) 856-4696
WEBSITE: www.ustp.edu.ph

MASTER PLUMBER
PRC NO.:
PTR NO.:
DATE:
PLACE:

PROJECT: CONSTRUCTION OF 21ST CENTURY CLASSROOM BUILDINGS PHASE III, VILLANUEVA CAMPUS
LOCATION: USTP VILLANUEVA CAMPUS, MISAMIS ORIENTAL
OWNER: UNIVERSITY OF SCIENCE AND TECHNOLOGY OF SOUTHERN PHILIPPINES

RECOMMENDING APPROVAL:
ENGR. GRACE C. BABA
DIRECTOR, IPFDD

RECOMMENDING APPROVAL:
ATTY. ERWIN B. BUCIO
VP FOR ADMINISTRATION & LEGAL AFFAIRS

APPROVED BY:
DR. AMBROSIO B. CULTURA II
PRESIDENT, USTP SYSTEM

SHEET CONTENTS:
SEPTIC VAULT 2 DETAILS
FLOOR PLAN
LONGITUDINAL SECTION DETAIL
CROSS SECTION DETAIL
MANHOLE BLOW-UP DETAIL

DRAWN BY:
DATE DRAWN:
FNT:

P10

APPROVED BY:

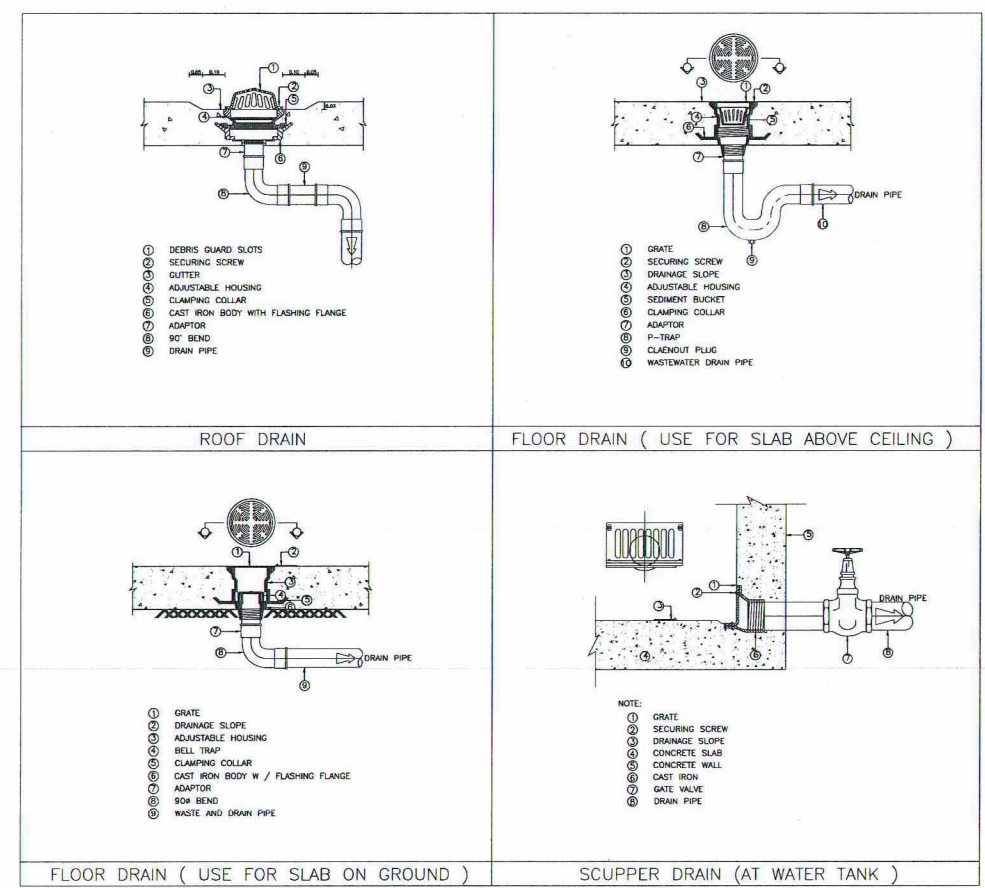
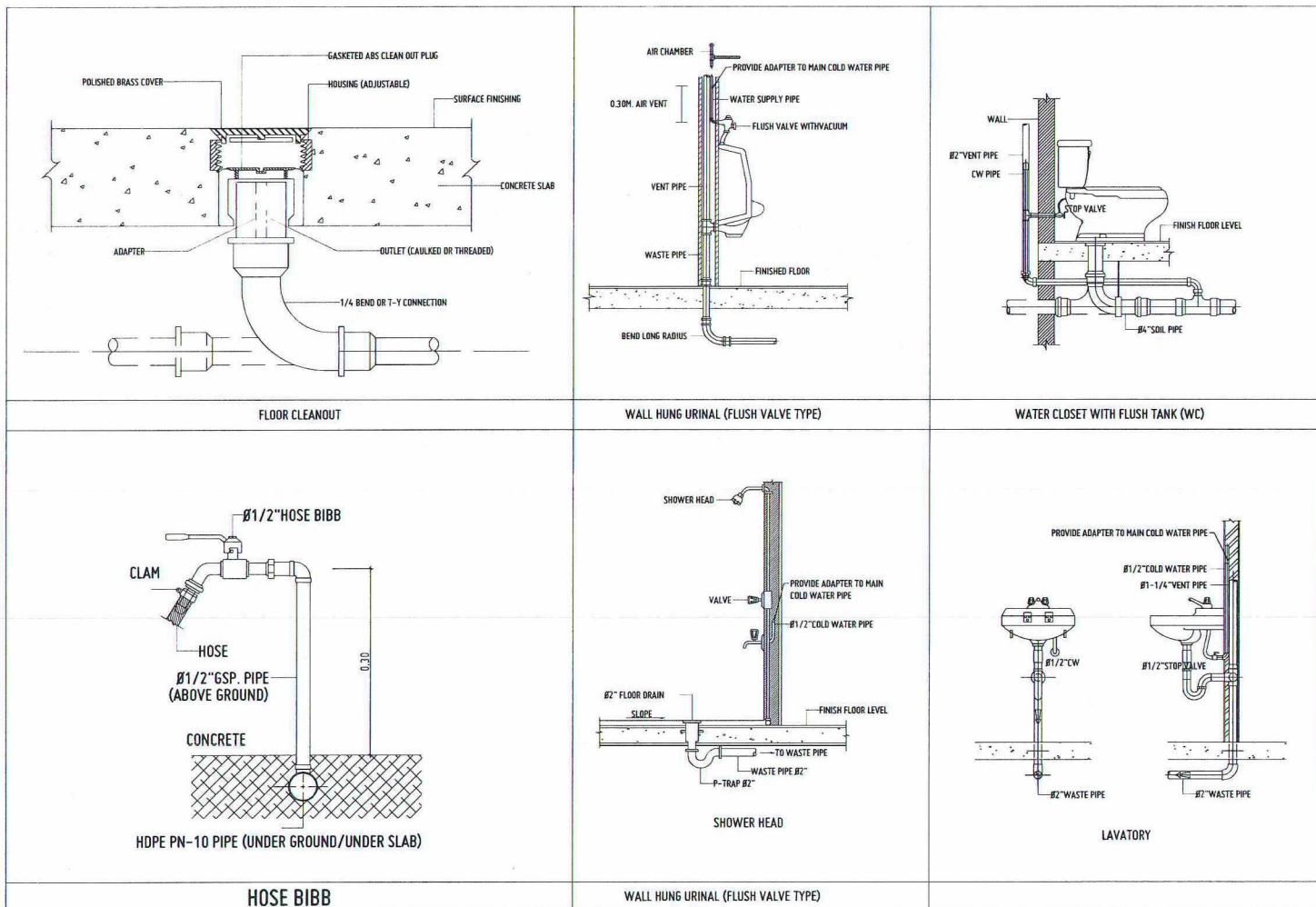
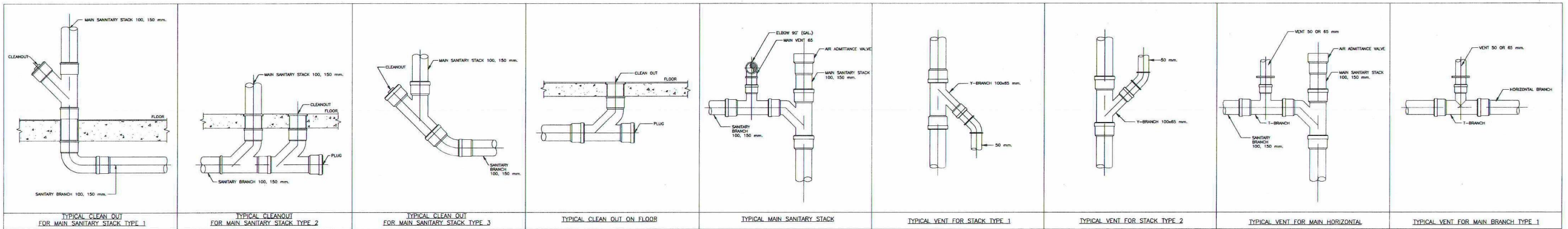

P
10
1

TOILET INSTALLATIONS & CONNECTION DETAILS

SCALE: NTS

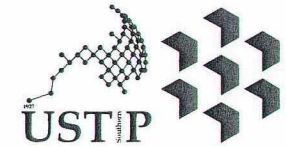

REPUBLIC OF THE PHILIPPINES
UNIVERSITY OF SCIENCE AND TECHNOLOGY OF SOUTHERN PHILIPPINES
CAGAYAN DE ORO CAMPUS
INFRASTRUCTURE PLANNING AND FACILITY DEVELOPMENT UNIT
CLARO M. RECTO AVENUE, LAPASAN, CAGAYAN DE ORO CITY 9000
TELEPHONE # (08822) 72-69-65 / (0880) 856-1738 / 856-1739 | TELE FAX (0880) 856-4696
WEBSITE: www.ustp.edu.ph

MASTER PLUMBER	
PRC NO.:	PTR NO.:
DATE:	PLACE:
TIN NO.:	

PROJECT	CONSTRUCTION OF 21ST CENTURY CLASSROOM BUILDINGS PHASE III, VILLANUEVA CAMPUS
LOCATION	USTP VILLANUEVA CAMPUS, MISAMIS ORIENTAL
OWNER	UNIVERSITY OF SCIENCE AND TECHNOLOGY OF SOUTHERN PHILIPPINES

RECOMMENDING APPROVAL:
[Signature]
ENGR. GRACE C. BABA
DIRECTOR, IPFDD

RECOMMENDING APPROVAL:
[Signature]
ATTY. ERWIN B. BUTIG
VP FOR ADMINISTRATION & LEGAL AFFAIRS

APPROVED BY:
[Signature]
DR. AMBROSIO B. CULTURA II
PRESIDENT, USTP SYSTEM

SHEET CONTENTS:
TOILET INSTALLATIONS & CONNECTION DETAILS

DRAWN BY:	
DATE DRAWN:	
PKT:	

P11

APPROVED BY:

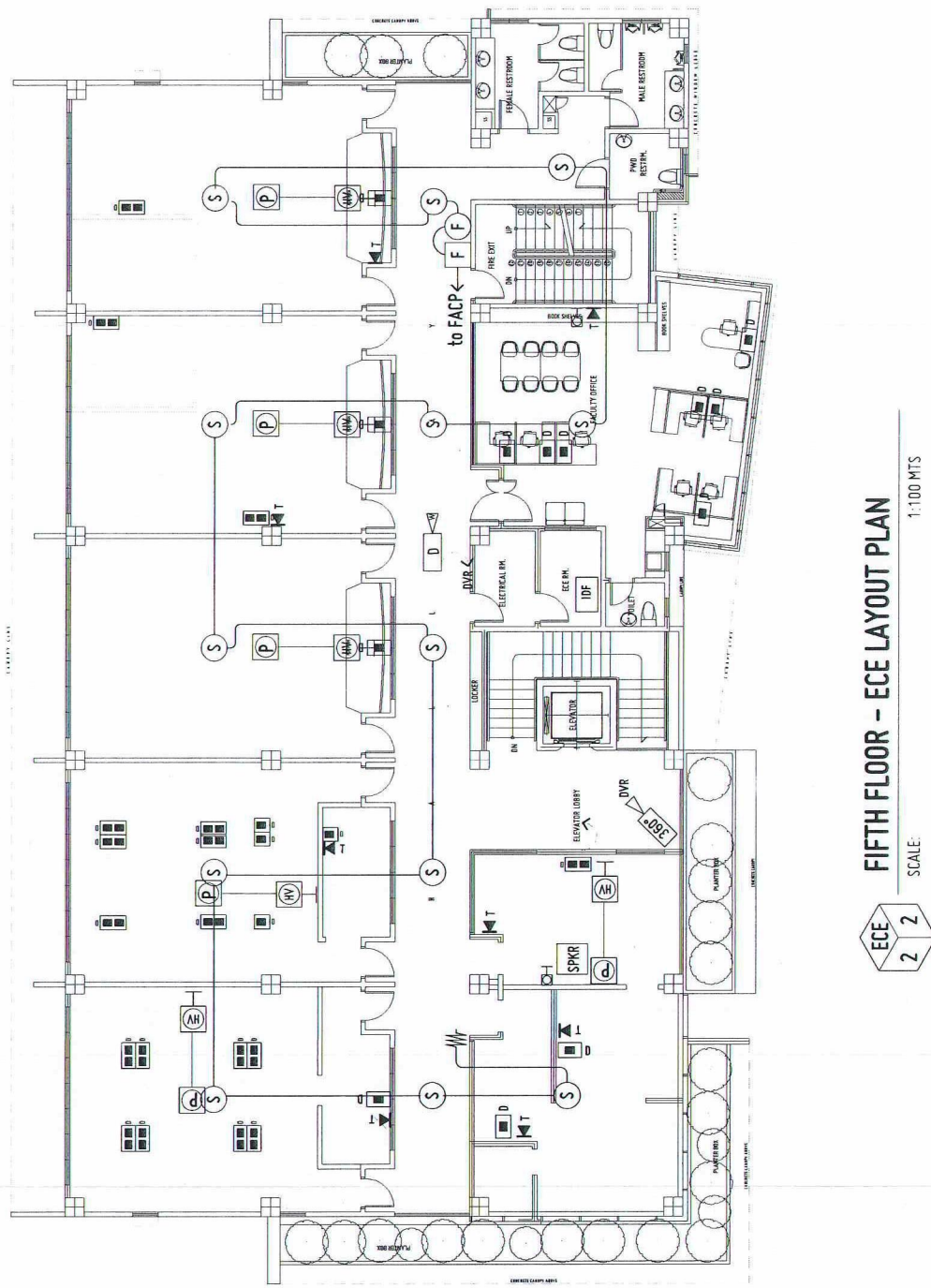
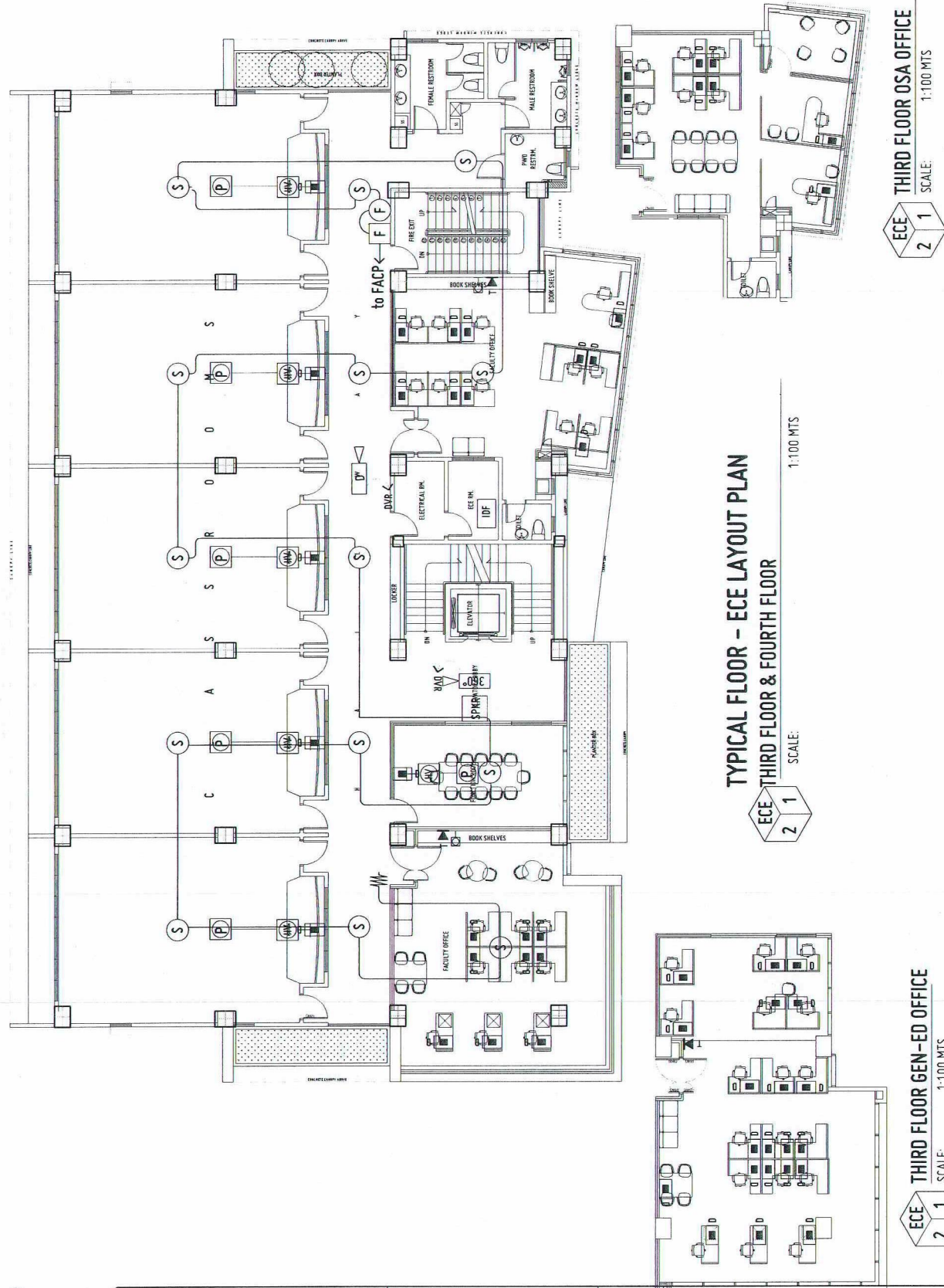

- LEGEND:**
- T SINGLE TELEPHONE WALL OUTLET, RJ11
 - T SINGLE TELEPHONE FLOOR MOUNTED OUTLET
 - D SINGLE UNIVERSAL DATA WALL OUTLET, RJ45
 - D DUPLICATION UNIVERSAL DATA WALL OUTLET, RJ45
 - IDF INTERMEDIATE DISTRIBUTION FRAME
 - MDF MAIN DISTRIBUTION FRAME
 - TV WALL CABLE TV OUTLET, PROVIDE 1- RG6/U COAXIAL CABLE
 - CTB CABLE TV BOX
 - TCB TELEPHONE AND CABLE TV BOX
 - PROVISION FOR HDMI/VGA CABLING FOR OVERHEAD PROJECTOR, VERIFY EXACT LOCATION WITH ARCHITECT.
 - HDMI & VGA WALL OUTLET IN SINGLE PLATE INTERCONNECT WITH THE OVERHEAD PROJECTOR HDMI/VGA WIRING PROVISION OR T.V APPLIANCES HDMI/ VGA CABLE VIA 63MM PVC. REFER TO LAYOUT.
 - S SMOKE DETECTOR- CEILING MOUNTED
 - S SMOKE DETECTOR- WALL MOUNTED
 - H HEAT DETECTOR, CEILING MOUNTED
 - F FIRE ALARM STROBE AND HORN, UL LISTED BRAND
 - F FIRE ALARM MANUAL PULL STATION, UL LISTED BRAND
 - EL END OF LINE RESISTOR

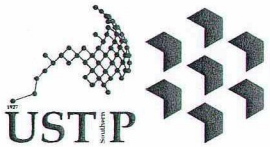

REPUBLIC OF THE PHILIPPINES
UNIVERSITY OF SCIENCE AND TECHNOLOGY OF SOUTHERN PHILIPPINES
CAGAYAN DE ORO CAMPUS
INFRASTRUCTURE PLANNING AND FACILITY DEVELOPMENT UNIT
CLARO M. RECTO AVENUE, LAPASAN, CAGAYAN DE ORO CITY 9000
TELEPHONE # (08822) 71-60-65 / (088) 856-1738 / 856-1739 | TELE FAX (088) 856-4698
WEBSITE: www.ustp.edu.ph

PROFESSIONAL ELECTRONICS ENGINEER	
PRC NO.:	PTR NO.:
DATE:	PLACE:
TIN NO.:	

PROJECT	CONSTRUCTION OF 21ST CENTURY CLASSROOM BUILDINGS PHASE III, VILLANUEVA CAMPUS
LOCATION	USTP VILLANUEVA CAMPUS, MISAMIS ORIENTAL
OWNER	UNIVERSITY OF SCIENCE AND TECHNOLOGY OF SOUTHERN PHILIPPINES

RECOMMENDING APPROVAL:
Grace C. Baba
ENGR. GRACE C. BABA
DIRECTOR, IPFDD

RECOMMENDING APPROVAL:
Atty. Erwin B. Bucio
ATTY. ERWIN B. BUCIO
-VP FOR ADMINISTRATION & LEGAL AFFAIRS

APPROVED BY:
Dr. Ambrosio B. Cultura II
DR. AMBROSIO B. CULTURA II
PRESIDENT, USTP SYSTEM

SHEET CONTENTS:	TYPICAL FLOOR - ECE LAYOUT PLAN THIRD FLOOR & FOURTH FLOOR FIFTH FLOOR - ECE LAYOUT PLAN
-----------------	--

DRAWN BY:	
DATE DRAWN:	
PKT:	

AUX2



ECE
3 1

VICINITY MAP

SCALE: NTS

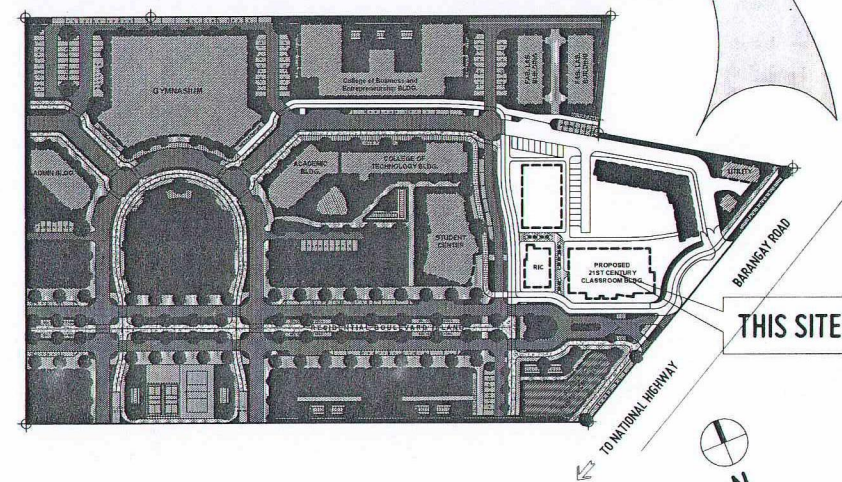

ECE
3 2

LOCATION PLAN

SCALE: 1:1500 MTS

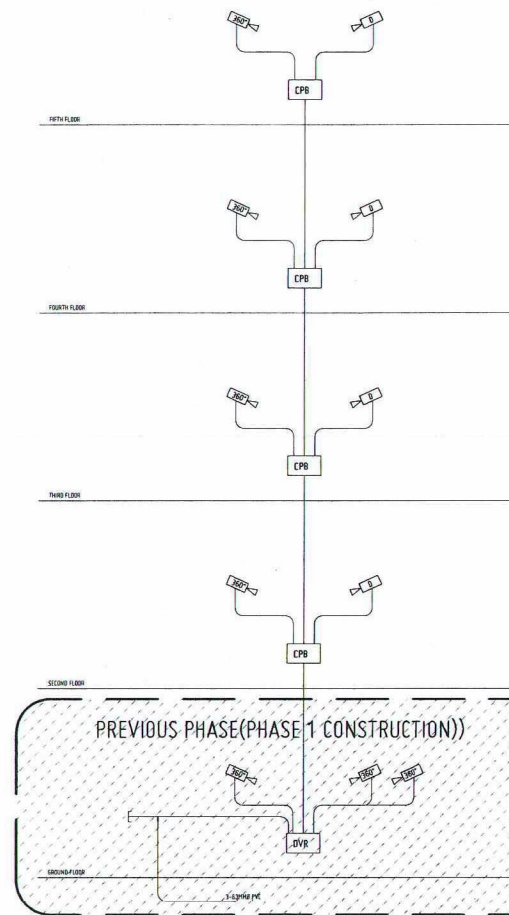

ECE
3 3

CCTV SYSTEM RISER DIAGRAM

NOT DRAWN TO SCALE

LEGEND:

- SINGLE TELEPHONE WALL OUTLET, RJ11
- SINGLE TELEPHONE FLOOR MOUNTED OUTLET
- SINGLE UNIVERSAL DATA WALL OUTLET, RJ45
- DUPLEX UNIVERSAL DATA WALL OUTLET, RJ45
- INTERMEDIATE DISTRIBUTION FRAME
- MAIN DISTRIBUTION FRAME
- WALL CABLE TV OUTLET, PROVIDE 1- R66/U COAXIAL CABLE
- CABLE TV BOX
- TELEPHONE AND CABLE TV BOX
- PROVISION FOR HDMI/VGA CABLING FOR OVERHEAD PROJECTOR, VERIFY EXACT LOCATION WITH ARCHITECT.
- HDMI & VGA WALL OUTLET IN SINGLE PLATE INTERCONNECT WITH THE OVERHEAD PROJECTOR HDMI/VGA WIRING PROVISION OR TV APPLIANCES HDMI/ VGA CABLE VIA 63MMØ PVC. REFER TO LAYOUT.
- SMOKE DETECTOR- CEILING MOUNTED
- SMOKE DETECTOR- WALL MOUNTED
- HEAT DETECTOR, CEILING MOUNTED
- FIRE ALARM STROBE AND HORN, UL LISTED BRAND
- FIRE ALARM MANUAL PULL STATION, UL LISTED BRAND
- END OF LINE RESISTOR

NOTES:

1. SYMBOL
 - CLOSED CIRCUIT TELEVISION, DOME TYPE PROVIDE SIGNAL CABLE & POWER CABLE FOR EACH CAMERA, WIRING IS SUBJECT TO MANUFACTURER'S STANDARD.
 - CLOSED CIRCUIT TELEVISION, REVOLVING 360°
 - CCTV WRING PULLBOX WITH POWER SUPPLY
 - DIGITAL VIDEO RECORDER
2. MINIMUM CONDUIT SHALL BE 20MM (3/4") Ø. USE IMC FOR ALL EXPOSED CONDUIT OR INSIDE DRYWALL AND PVC FOR ALL CONCRETE EMBEDDED CONDUIT.
3. VERIFY EXACT NUMBER OF CCTV CAMERA WITH LAYOUT.
4. VERIFY AND/OR COORDINATE WITH OWNER/USER THE EXACT LOCATION OF DVR PRIOR TO LAYOUT OF CONDUIT.
5. BOND ALL CPB, CABLE TRAY USING 5.5MMØ GROUND WIRE AND BOND TO IBTB
6. CCTV SYSTEM AND WIRING SCHEDULE.

C	CONDUIT SIZE, MMØ (INCHØ)	
	METAL	uPVC
1	20	25 (3/4)
2	20	25 (3/4)
4	25	32 (1)
8	32	40 (1-1/4)
10	40	50 (1-1/2)
15	50	63 (2)

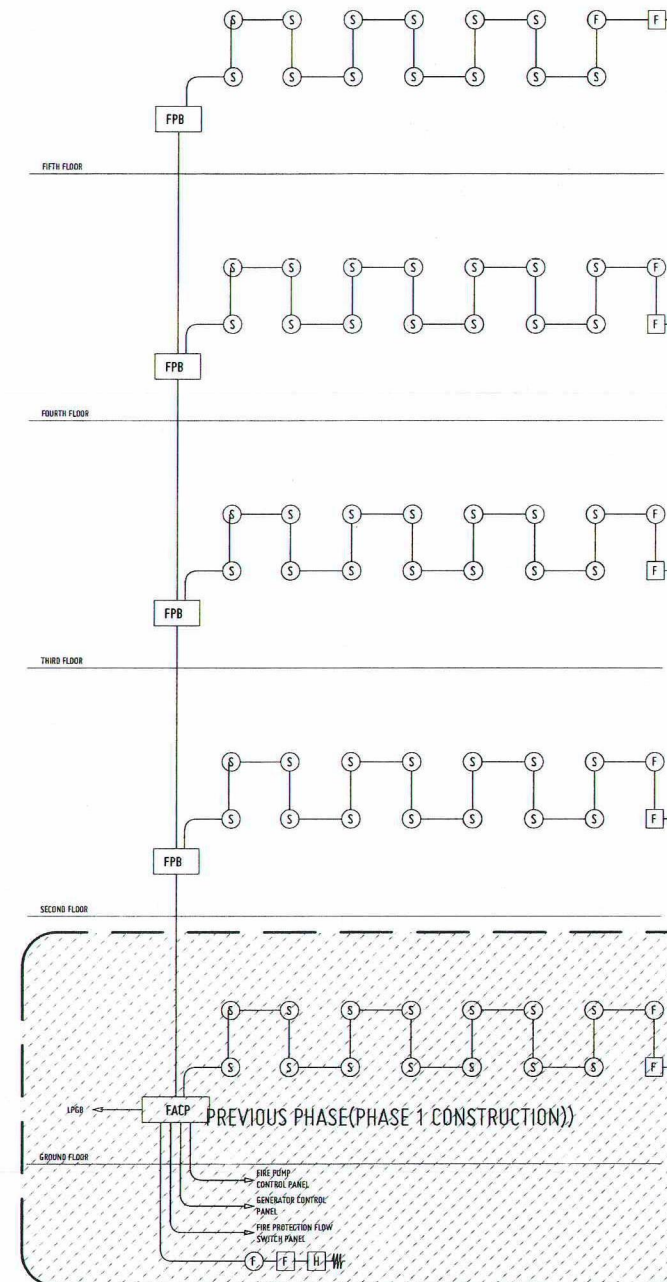

ECE
3 4

FIRE ALARM SYSTEM RISER DIAGRAM

NOT DRAWN TO SCALE

APPROVED BY:

GENERAL NOTES:

1. FF = FINISH FLOOR LINE. VERIFY FLOOR FINISHES/MATERIALS.
2. ALL INTERIOR PARTITIONS AND FURNITURE LAYOUT ARE INDICATIVE ONLY AND MAY CHANGE. VERIFY INTERIOR DESIGN DRAWINGS.
3. ALL LANDSCAPE ARCHITECTURE ELEMENTS ARE INDICATIVE ONLY AND MAY CHANGE. VERIFY LANDSCAPE ARCHITECTURE DRAWINGS.
4. DO NOT SCALE DRAWINGS. WRITTEN DIMENSIONS TO GOVERN.
5. IN CASE OF DISCREPANCY IN THE FIGURES AND DRAWINGS THE MATTER SHALL BE SUBMITTED IMMEDIATELY TO THE ARCHITECT BEFORE ADJUSTMENTS ARE TO BE MADE.
6. VERIFY ACTUAL TECHNICAL SITE CONDITIONS.
7. VERIFY ACTUAL ELEVATION MARKS AND LOT BOUNDARIES. PRIOR TO COMMENCING WORK.
8. ALL WORKS HEREIN SHALL BE DONE UNDER THE STRICT SUPERVISION OF BUILT LICENSED AND EXPERIENCED ARCHITECT/ENGINEER.
9. LOT AND BUILDING BOUNDARIES SHOULD BE SUPPORTED BY RETAINING WALLS AND FENCES. VERIFY EXISTING HEIGHTS, ELEVATIONS AND OTHER SITE CONDITIONS.
10. THE GENERAL CONTRACTOR, SUB-CONTRACTORS INCLUDING SPECIALTY CONTRACTORS, SHALL SUBMIT PROPER SHOP DRAWINGS INCLUDING MATERIALS SAMPLE PRIOR TO INSTALLATIONS FOR ARCHITECT'S APPROVAL.

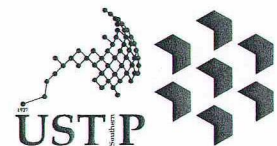

REPUBLIC OF THE PHILIPPINES
UNIVERSITY OF SCIENCE AND TECHNOLOGY OF SOUTHERN PHILIPPINES
CAGAYAN DE ORO CAMPUS
INFRASTRUCTURE PLANNING AND FACILITY DEVELOPMENT UNIT
CLARO M. RECTO AVENUE, LAPASAN, CAGAYAN DE ORO CITY 9000
TELEPHONE # (08622) 72-60-65 / (086) 856-1738 / 856-1739 | TELE FAX (086) 856-4696
WEBSITE: www.ustp.edu.ph

PROFESSIONAL ELECTRONICS ENGINEER
PRC NO.: PTR NO.:
DATE: PLACE:
TIN NO.:

PROJECT: CONSTRUCTION OF 21ST CENTURY CLASSROOM BUILDINGS PHASE III, VILLANUEVA CAMPUS
LOCATION: USTP VILLANUEVA CAMPUS, MISAMIS ORIENTAL
OWNER: UNIVERSITY OF SCIENCE AND TECHNOLOGY OF SOUTHERN PHILIPPINES

RECOMMENDING APPROVAL:
ENGR. GRACE C. BABA
DIRECTOR, IPFDO

RECOMMENDING APPROVAL:
ATTY. ERWIN B. BUICIO
VP FOR ADMINISTRATION & LEGAL AFFAIRS

APPROVED BY:
DR. AMBROSIO B. CULTURA II
PRESIDENT, USTP SYSTEM

SHEET CONTENTS:
VICINITY MAP
LOCATION PLAN
CCTV SYSTEM RISER DIAGRAM
FIRE ALARM SYSTEM RISER DIAGRAM

DRAWN BY:
DATE DRAWN:
FNT:

AUX3

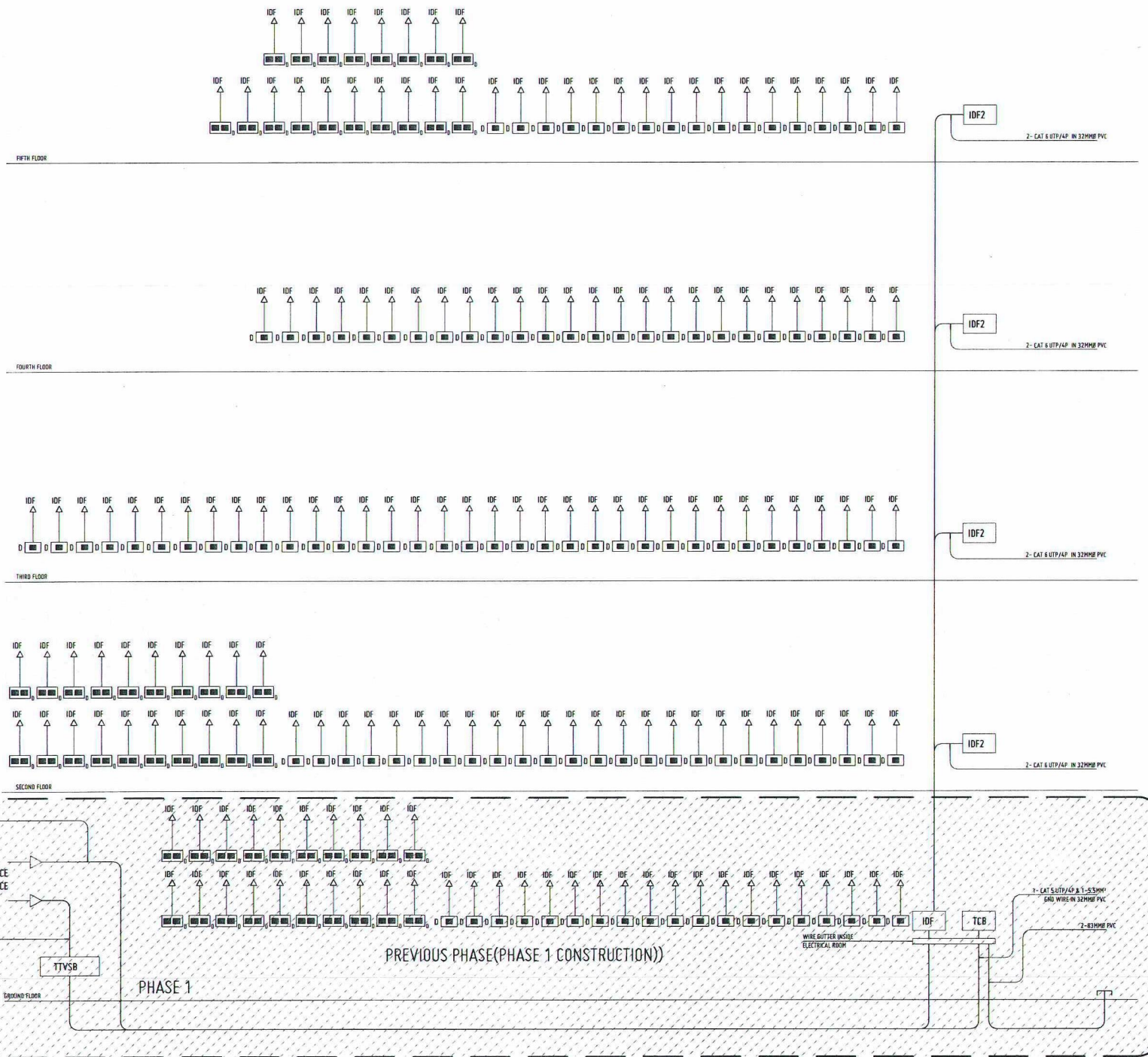

- GENERAL NOTE:
- ALL ELECTRONIC WORKS HERE IN SHALL BE DONE ACCORDANCE WITH THE PROVISION OF THE LATEST EDITION OF THE PHILIPPINE ELECTRONICS CODE, THE RULES AND REGULATIONS OF THE LOCAL ENFORCING AUTHORITIES AND THE REQUIREMENTS OF THE UTILITY TELEPHONE COMPANY.
 - ALL ELECTRONIC WORKS HERE IN INCLUDED SHALL BE EXECUTED BY THE PERSONNEL WITH ELECTRICAL EXPERIENCE UNDER THE DIRECT SUPERVISION OF A FULL TIME LICENSED ELECTRONICS ENGINEER. WORKS SHALL BE NEATLY PLACED, SECURELY FASTENED AND PROPERLY FINISHED.
 - THE CONTRACTOR SHALL VERIFY AND ORIENT THE ACTUAL LOCATION OF THE TAPPING POINT FOR CONNECTION TO COMMUNICATION SUPPLY.
 - ALL MATERIALS SHALL BE BRAND NEW AND SHALL CONFORM WITH THE PROVISIONS OF THE UNDER WRITERS LABORATORIES INC., IN EVERY CASE WHERE SUCH A STANDARD HAS BEEN ESTABLISHED.
 - ALL CONDUITS MUST BE PROTECTED AGAINST DAMAGES BY THE ENTRANCE OF THE WATER AND FOREIGN MATTERS DURING CONSTRUCTION. ALL ENDS OF CONDUITS SHALL BE PLUGGED TO EXCLUDE MOISTURE AND DUST IMMEDIATELY AFTER THE CONDUITS ARE PLACED.
 - UNLESS OTHERWISE SPECIFIED, ALL ELECTRONICS WIRING INSTALLATION SHALL BE USED RSC. THE MINIMUM SIZE OF CONDUIT SHALL BE 15MMØ.
 - ALL RACEWAYS, WALL, AND FLOOR PENETRATION SHALL BE PROVIDED WITH FIRE BARRIER OF THE APPROVED TYPE.
 - ALL OUTLET BOXES SHALL BE GALVANIZED GAGE NO. 16 DEEP TYPE WITH THE FACTORY KNOCKOUTS. PULLBOXES SHALL BE USED WHEN APPLICABLE FOR EASY PULLING OF WIRES AND SHALL BE IN ACCORDANCE WITH THE PHILIPPINE ELECTRICAL CODE REQUIREMENT. PREFERRED BRAND FOR JUNCTION, PULLBOXES OR UTILITY SQUARE BOXES SHALL BE FUMACO, AMCO, TMO OR APPROVED EQUAL.
 - MOUNTING HEIGHTS OF DEVICES SHALL BE:
(SUBJECT TO ARCHITECTS APPROVAL PRIOR TO INSTALLATION)
 - ALL SPEAKER WIRING SHALL BE 2-0.75 SQ.MM SHIELDED SPEAKER WIRE.
 - NETWORK CABLES/ CONDUIT SHALL HAVE A MINIMUM DISTANCE OF 0.3M FROM POWER CONDUIT WHEN LAND PARALLEL AND MUST RUN PERPENDICULAR TO THE STEEL CONDUIT WHEN CUTTING ACROSS A POWER LINE.
 - THE PLANS AS DRAWN ARE BASED UPON THE ARCHITECTURAL PLANS AND THE DETAILS AND SHOWN CONDITION AS ACCURATELY AS IT IS POSSIBLE TO INDICATE THEM IN SCALE. THE PLANS ARE DIAGRAMMATICAL AND DOES NOT NECESSARILY SHOW ALL FITTINGS NECESSARY TO FIT TO THE BUILDING CONDITIONS. THE LOCATIONS OF OUTLETS, APPARATUS AND APPLIANCES SHOWN ON THE PLANS ARE APPROXIMATE. THE CONTRACTORS SHALL BE HELD RESPONSIBLE FOR THEIR PROPER LOCATION IN ORDER TO MAKE THEM FIT WITH THE ARCHITECTURAL DETAILS AND INSTRUCTIONS FROM THE ENGINEER'S REPRESENTATIVE AT THE SITE.

- APPROVED BY:
- GENERAL NOTES:
- FEL - FINISH FLOOR LINE. VERIFY FLOOR FINISHES/MATERIALS.
 - ALL INTERIOR PARTITIONS AND FURNITURE LAYOUT ARE INDICATIVE ONLY AND MAY CHANGE. VERIFY INTERIOR DESIGN DRAWINGS.
 - ALL LANDSCAPE ARCHITECTURE ELEMENTS ARE INDICATIVE ONLY AND MAY CHANGE. VERIFY LANDSCAPE ARCHITECTURE DRAWINGS.
 - DO NOT SCALE DRAWINGS. WRITTEN DIMENSIONS TO GOVERN.
 - IN CASE OF DISCREPANCY IN THE FIGURES AND DRAWINGS THE MATTER SHALL BE SUBMITTED IMMEDIATELY TO THE ARCHITECT BEFORE ADJUSTMENTS ARE TO BE MADE.
 - VERIFY ACTUAL TECHNICAL SITE CONDITIONS.
 - VERIFY ACTUAL ELEVATION MARKS AND LOT BOUNDARIES PRIOR TO COMMENCING WORK.
 - ALL WORKS HEREIN SHALL BE DONE UNDER THE STRICT SUPERVISION OF BUILT LICENSED AND EXPERIENCED ARCHITECT/ENGINEER.
 - LOT AND BUILDING BOUNDARIES SHOULD BE SUPPORTED BY RETAINING WALLS AND FENCES. VERIFY EXISTING HEIGHTS, ELEVATIONS AND OTHER SITE CONDITIONS.
 - THE GENERAL CONTRACTOR, SUB-CONTRACTORS INCLUDING SPECIALTY CONTRACTORS, SHALL SUBMIT PROPER SHOP DRAWINGS INCLUDING MATERIALS SAMPLE PRIOR TO INSTALLATIONS FOR ARCHITECT'S APPROVAL.

NOTES:

- FIRE ALARM SYSTEM SHALL BE CONVENTIONAL TYPE
- MINIMUM CONDUIT SIZE SHALL BE 20MM (3/4")Ø. USE IMC FOR ALL EXPOSED CONDUIT OR INSIDE DRY WALL AND PVC IF CONCRETE EMBEDDED.
- ALL RISER CONDUIT SHALL BE IMC. PROVIDE 50MM (2")Ø SPARE IMC RISER CONDUIT.
- FDA'S WIRING AND CONDUIT SCHEDULE.

CONDUIT SIZE MMØ (INCHØ)	NUMBER OF TF WIRES (C.I. CABLE TYPE)		CONDUIT SIZE MMØ (INCHØ)	NUMBER OF TF WIRES (C.I. CABLE TYPE)	
	#18	#16		METAL	#18
20	75(3/4)	25	18	60	75(2-1/2)
25	32(1)	41	30	80	90(3)
32	40(1-1/4)	72	53	90	100(3-1/2)
40	50(1-1/2)	99	72	100	110(4)
50	63(2)	164	120		

5. SYMBOLS

A = #18/2 AWG. CIRCUIT INTEGRITY (CI) CABLE TYPE, UL LISTED BRAND

- [FACP] FIRE ALARM CONTROL PANEL, UL LISTED BRAND
- [S] SMOKE DETECTOR- CEILING MOUNTED
- [S] SMOKE DETECTOR- WALL MOUNTED
- [H] HEAT DETECTOR, CEILING MOUNTED
- [F] FIRE ALARM STROBE AND HORN, UL LISTED BRAND
- [F] FIRE ALARM MANUAL PULL STATION, UL LISTED BRAND
- [—R] END OF LINE RESISTOR
- [FPB] FIRE ALARM SYSTEM WIRING PULL BOX

- PROVIDE SUPERVISORY WIRES TO THE FOLLOWING:
 - A. ELEVATOR/S
 - B. FIRE PROTECTION FLOW SWITCH CONTROL PANEL OR INDIVIDUAL FLOW SWITCH (VERIFY LOCATION)
 - C. STAIR PRESSURIZATION BLOWER/S OR FAN/S (VERIFY EXACT LOCATION)
 - D. SMOKE VENTILATION SYSTEM AND/OR SMOKE CONTROL SYSTEM.
 - E. FIRE PUMP CONTROL PANEL
- PROVIDE WIRING FROM FACP TO GENERATOR CONTROL PANEL TO MONITOR THE FOLLOWING CONDITIONS:
 - A. GENERATOR RUNNING
 - B. GENERATOR FAULT
 - C. GENERATOR SWITCH IN NON-AUTOMATIC POSITION/MODE
- FINAL WIRING SHALL BE AS PER MANUFACTURER'S STANDARDS.

ECE
4 1
TELEPHONE AND INTERNET RISER DIAGRAM
DRAWN NOT TO SCALE

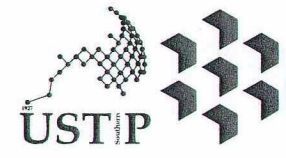

REPUBLIC OF THE PHILIPPINES
UNIVERSITY OF SCIENCE AND TECHNOLOGY OF SOUTHERN PHILIPPINES
CAGAYAN DE ORO CAMPUS
INFRASTRUCTURE PLANNING AND FACILITY DEVELOPMENT UNIT
CLARD H. RECTO AVENUE, LAPASAN, CAGAYAN DE ORO CITY 9000
TELEPHONE # (0882) 72-60-65 / (088) 856-1738 / 856-1739 / TELE FAX (088) 856-4496
WEBSITE: www.ustp.edu.ph

PROFESSIONAL ELECTRONICS ENGINEER	
PRE NO.:	PTR NO.:
DATE:	PLACE:
TIN NO.:	

PROJECT	CONSTRUCTION OF 21ST CENTURY CLASSROOM BUILDINGS PHASE III, VILLANUEVA CAMPUS
LOCATION	USTP VILLANUEVA CAMPUS, MISAMIS ORIENTAL
OWNER	UNIVERSITY OF SCIENCE AND TECHNOLOGY OF SOUTHERN PHILIPPINES

RECOMMENDING APPROVAL:
[Signature]
ENGR. GRACE C. BABA
DIRECTOR, IPFDO

RECOMMENDING APPROVAL:
[Signature]
ATTY. ERWIN B. BUELO
VP FOR ADMINISTRATION & LEGAL AFFAIRS

APPROVED BY:
[Signature]
DR. AMBROSIO B. CULTURA II
PRESIDENT, USTP SYSTEM

SHEET CONTENTS:
TELEPHONE AND INTERNET RISER DIAGRAM

DRAWN BY:
DATE DRAWN:
PNT:

AUX4

APPROVED BY:

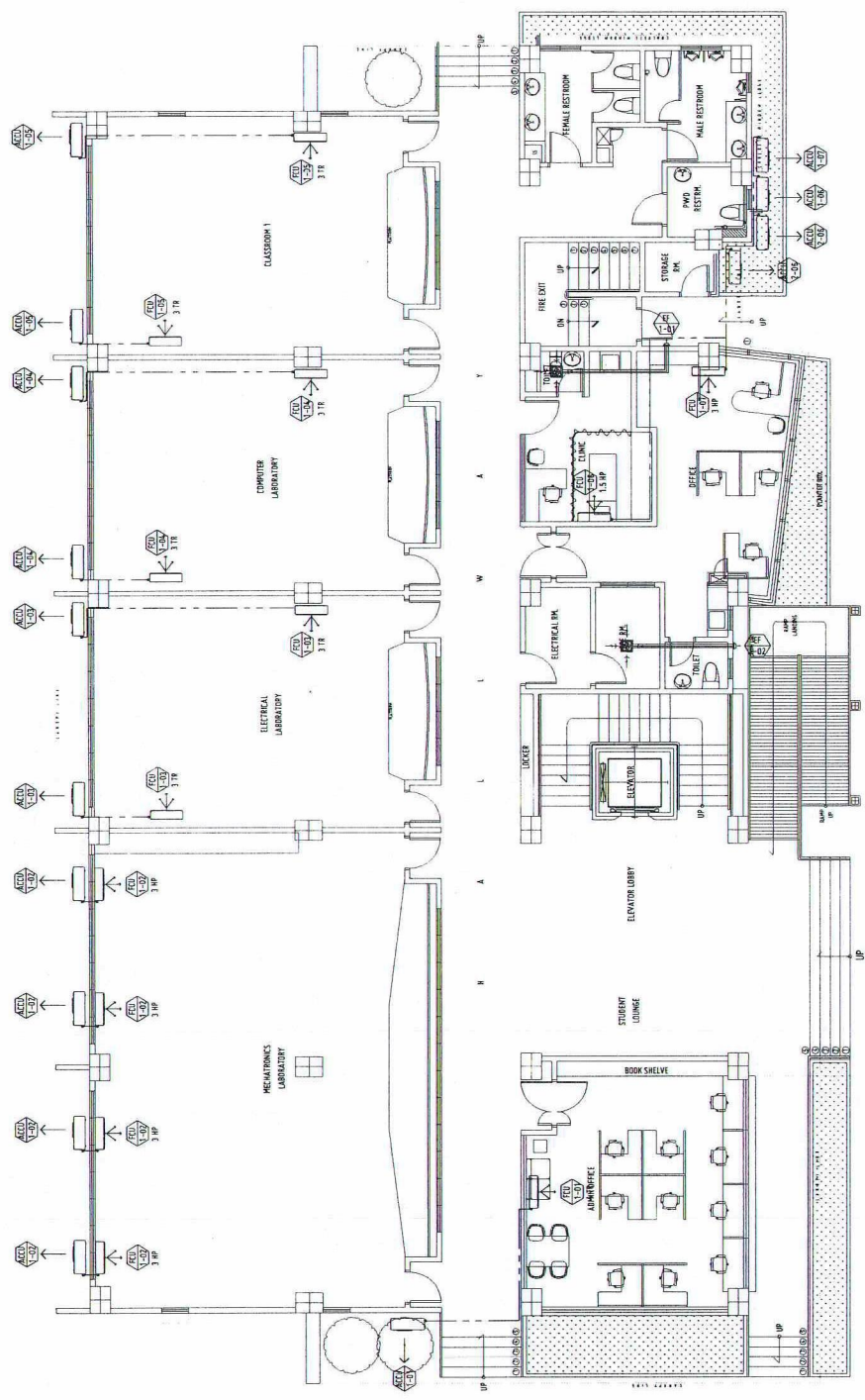

GROUND FLOOR PLAN
SCALE: 1:100 MTS

- LEGEND:
- ⊖ DIMPLEX CONDUITANCE OUTLET
 - ⊖ EMERGENCY OUTLET
 - ⊖ EL
 - ⊖ EX
 - ⊖ EXIT OUTLET
 - ⊖ FLOOR CONDUITANCE OUTLET WITH SAFETY SWITCHER
 - ⊖ FO
 - ⊖ AIR CONDITIONING UNIT
 - ⊖ ACU
 - ⊖ WEATHERPROOF OUTLET
 - ⊖ WP
 - ⊖ PANEL BOARD

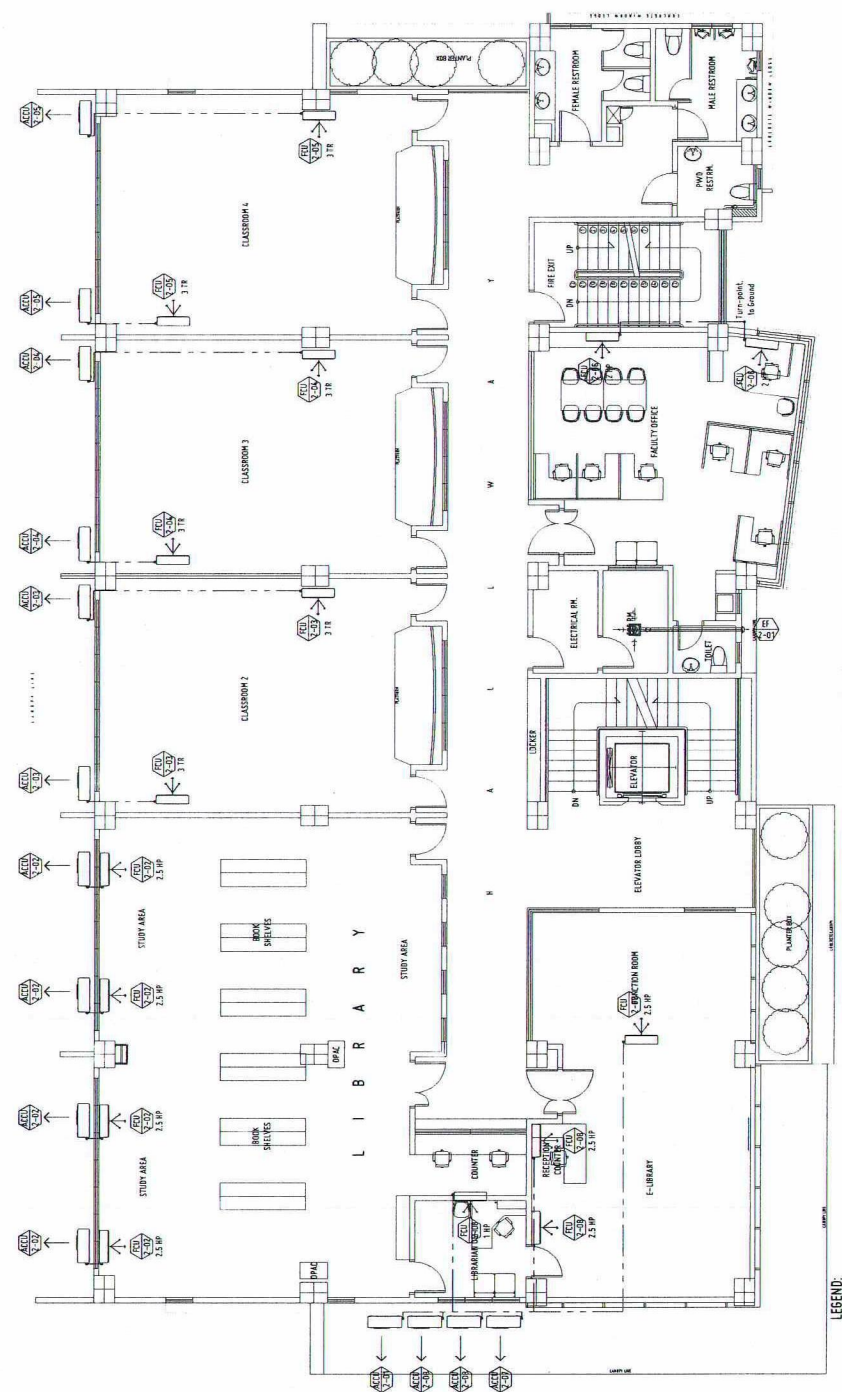

SECOND FLOOR PLAN

- LEGEND:
- ⊖ DIMPLEX CONDUITANCE OUTLET
 - ⊖ EMERGENCY OUTLET
 - ⊖ EL
 - ⊖ EX
 - ⊖ EXIT OUTLET
 - ⊖ FLOOR CONDUITANCE OUTLET WITH SAFETY SWITCHER
 - ⊖ FO
 - ⊖ AIR CONDITIONING UNIT
 - ⊖ ACU
 - ⊖ WEATHERPROOF OUTLET
 - ⊖ WP
 - ⊖ PANEL BOARD

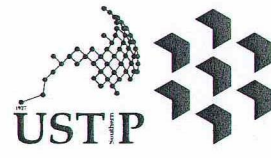

REPUBLIC OF THE PHILIPPINES
UNIVERSITY OF SCIENCE AND TECHNOLOGY OF SOUTHERN PHILIPPINES
CAGAYAN DE ORO CAMPUS
INFRASTRUCTURE PLANNING AND FACILITY DEVELOPMENT UNIT
CLARDO M. RECTO AVENUE, LAPASAN, CAGAYAN DE ORO CITY 9000
TELEPHONE # (08622) 72-60-65 / (086) 856-1738 / 856-1739 | TELE FAX (086) 856-4696
WEBSITE: www.ustip.edu.ph

PROFESSIONAL ELECTRICAL ENGINEER	
PRC NO.:	PTR NO.:
TIN NO.:	PLACE:

PROJECT	CONSTRUCTION OF 21ST CENTURY CLASSROOM BUILDINGS PHASE III, VILLANUEVA CAMPUS
LOCATION	USTP VILLANUEVA CAMPUS, MISAMIS ORIENTAL
OWNER	UNIVERSITY OF SCIENCE AND TECHNOLOGY OF SOUTHERN PHILIPPINES

RECOMMENDING APPROVAL:
Engr. Grace C. Baba
ENGR. GRACE C. BABA
DIRECTOR, IPFDD

RECOMMENDING APPROVAL:
Atty. Erwin B. Bosiso
ATTY. ERWIN B. BOSISO
VP FOR ADMINISTRATION & LEGAL AFFAIRS

APPROVED BY:
Dr. Ambrosio B. Cultura II
DR. AMBROSIO B. CULTURA II
PRESIDENT, USTP SYSTEM

SHEET CONTENTS:
FIFTH FLOOR PLAN (LIGHTING AND SWITCHING LAYOUT)
ROOF DECK PLAN
GROUND FLOOR PLAN (POWER LAYOUT)

DRAWN BY:	
DATE DRAWN:	
PNT:	

M1

APPROVED BY:

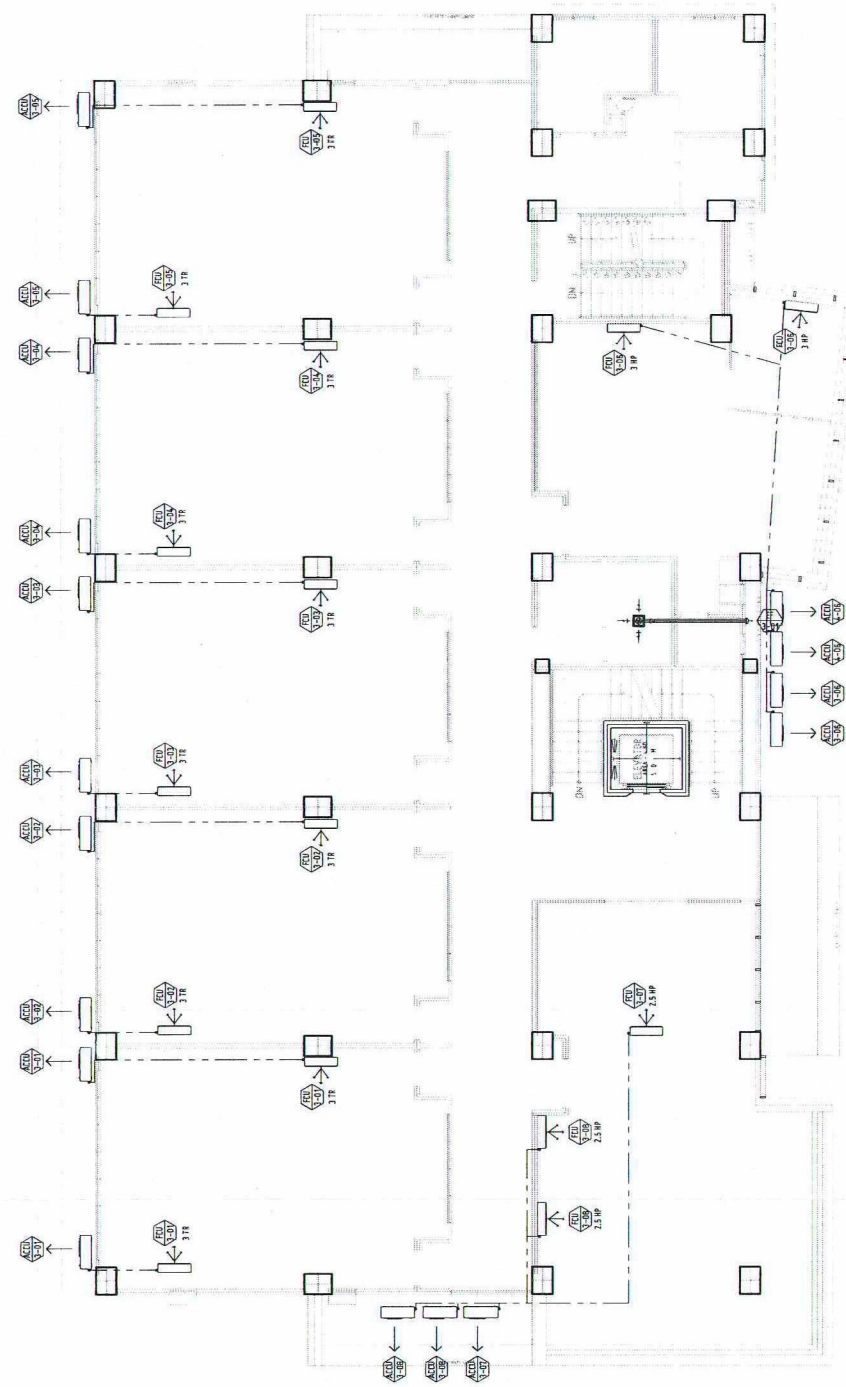

THIRD FLOOR PLAN



- LEGEND:
- ⊕ DUPLEX CONVENIENCE OUTLET
 - ⊖ EMERGENCY OUTLET
 - ⊙ EXIT OUTLET
 - ⊕ FLOOR CONVENIENCE OUTLET WITH SAFETY SWITCH
 - ⊖ AIR CONDITIONING UNIT
 - ⊕ WEATHERPROOF OUTLET
 - ⊖ WP
 - ⊖ PANEL BOARD

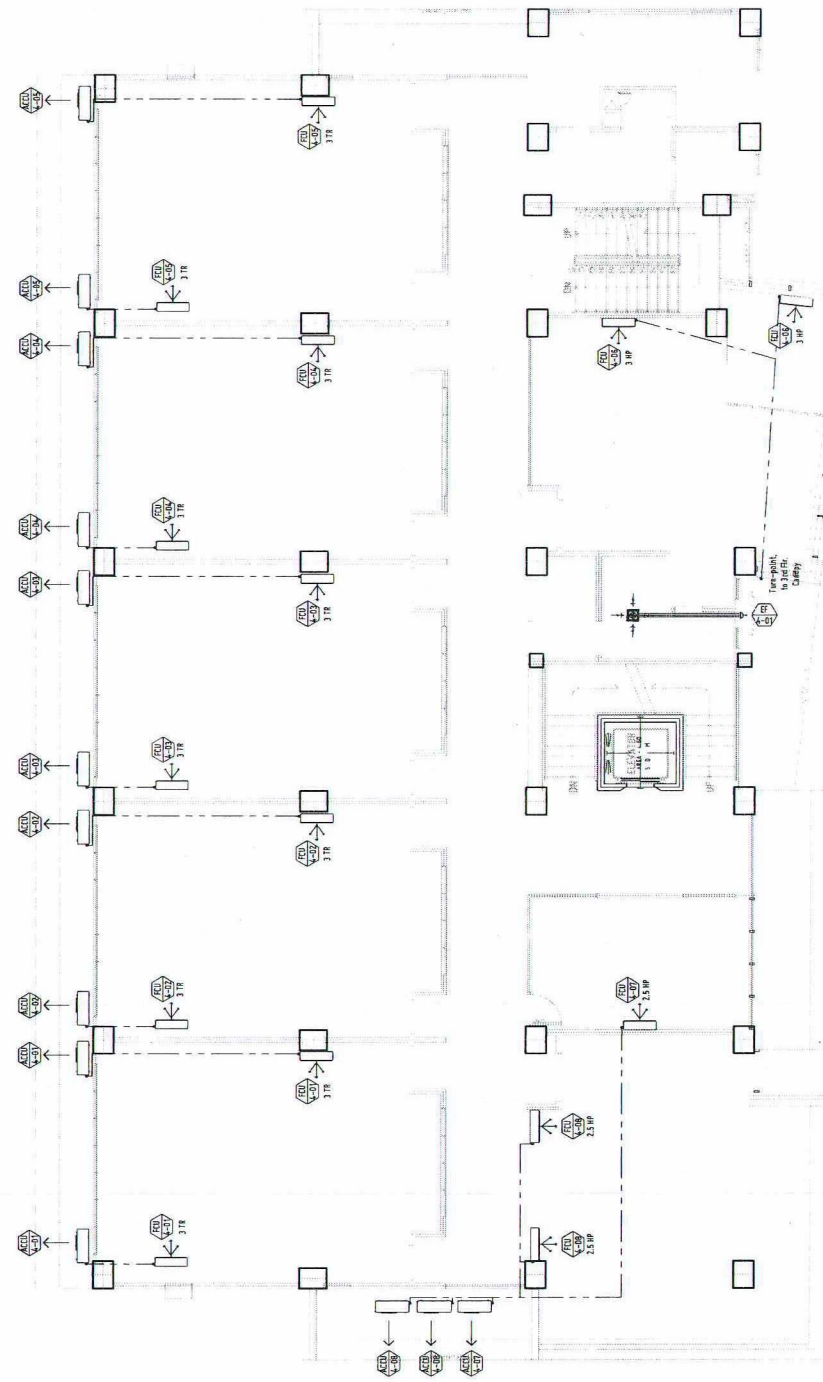

FOURTH FLOOR PLAN (POWER LAYOUT)
-PHASE 2 CONSTRUCTION



- LEGEND:
- ⊕ DUPLEX CONVENIENCE OUTLET
 - ⊖ EMERGENCY OUTLET
 - ⊙ EXIT OUTLET
 - ⊕ FLOOR CONVENIENCE OUTLET WITH SAFETY SWITCH
 - ⊖ AIR CONDITIONING UNIT
 - ⊕ WEATHERPROOF OUTLET
 - ⊖ WP
 - ⊖ PANEL BOARD

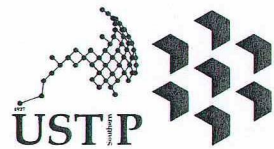

REPUBLIC OF THE PHILIPPINES
UNIVERSITY OF SCIENCE AND TECHNOLOGY OF SOUTHERN PHILIPPINES
CAGAYAN DE ORO CAMPUS
INFRASTRUCTURE PLANNING AND FACILITY DEVELOPMENT UNIT
CLARIO M. RECTO AVENUE, LAPASAN, CAGAYAN DE ORO CITY 9000
TELEPHONE # (08222) 72-60-65 / (088) 856-1738 / 856-1739 / TELE FAX (088) 856-4696
WEBSITE: www.ustp.edu.ph

PROFESSIONAL ELECTRICAL ENGINEER	
PRC NO.:	PTR NO.:
DATE:	PLACE:
TIN NO.:	

PROJECT	CONSTRUCTION OF 21ST CENTURY CLASSROOM BUILDINGS PHASE III, VILLANUEVA CAMPUS
LOCATION	USTP VILLANUEVA CAMPUS, MISAMIS ORIENTAL
OWNER	UNIVERSITY OF SCIENCE AND TECHNOLOGY OF SOUTHERN PHILIPPINES

RECOMMENDING APPROVAL
Grace C. Baba
ENGR. GRACE C. BABA
DIRECTOR, IPFDO

RECOMMENDING APPROVAL
Erwin B. Buech
ATTY. ERWIN B. BUECH
VP FOR ADMINISTRATION & LEGAL AFFAIRS

APPROVED BY:
Ambrosio B. Cultura II
DR. AMBROSIO B. CULTURA II
PRESIDENT, USTP SYSTEM

SHEET CONTENTS:	SECOND FLOOR PLAN (POWER LAYOUT) THIRD FLOOR PLAN (POWER LAYOUT)
DRAWN BY:	
DATE DRAWN:	
PKT:	

