

3



**PERSPECTIVES**  
SCALE: 1:1  
NOTES:



REPUBLIC OF THE PHILIPPINES  
OFFICE OF THE BUILDING OFFICIAL  
WILAMBUENA, MICHAS OBENAL

PROJECT  
UNIVERSITY OF SCIENCE AND TECHNOLOGY OF SOUTHERN PHILIPPINES  
CLAYTON CAMPUS  
MISJANS ORIENTAL  
PROPOSED 21ST CENTURY 5 STOREY CLASSROOM BUILDING

ARCHITECTURAL  
S1-SITE DEVELOPMENT PLAN/VICINITY MAP/LOCATION PLAN

RECOMMENDING APPROVAL:  
**AR FERDINAND A. CULIBOSO**  
ARCHITECT, PRTS

RECOMMENDING APPROVAL:  
**ATTY - ERWIN B. BUSTO**  
DIRECTOR, PRTS

APPROVED BY:  
**DR. AMPAROSO A. CULIAGA II**  
PRESIDENT, USTP SYSTEM

SHEET CONTENTS:  
PERSPECTIVES

DATE DRAWN: \_\_\_\_\_  
BY: \_\_\_\_\_  
**A1**

UNIVERSITY OF SCIENCE AND TECHNOLOGY OF SOUTHERN PHILIPPINES  
CLAYTON CAMPUS  
MISJANS ORIENTAL  
PROPOSED 21ST CENTURY 5 STOREY CLASSROOM BUILDING

PROJECT NO. 1328  
DATE: 07-2022  
PROJECT LOCATION: UNIV. OF SOUTHERN PHILIPPINES

PROPOSED 21ST CENTURY 5 STOREY CLASSROOM BUILDING  
UNIVERSITY OF SCIENCE AND TECHNOLOGY OF SOUTHERN PHILIPPINES  
CLAYTON CAMPUS, MISJANS ORIENTAL

RECOMMENDING APPROVAL:  
**AR FERDINAND A. CULIBOSO**  
ARCHITECT, PRTS

RECOMMENDING APPROVAL:  
**ATTY - ERWIN B. BUSTO**  
DIRECTOR, PRTS

APPROVED BY:  
**DR. AMPAROSO A. CULIAGA II**  
PRESIDENT, USTP SYSTEM

SHEET CONTENTS:  
PERSPECTIVES

DATE DRAWN: \_\_\_\_\_  
BY: \_\_\_\_\_  
**A1**

**TABLE OF CONTENTS:**

ARCHITECTURAL	
S1-SITE DEVELOPMENT PLAN/VICINITY MAP/LOCATION PLAN	
A1-PERSPECTIVES	
A2-FLOOR PLAN ON SITE	
A3-GROUND FLOOR PLAN, SECOND FLOOR PLAN	
A4-THIRD FLOOR PLAN, FOURTH FLOOR PLAN	
A5-FIFTH FLOOR PLAN, ROOF DECK, ROOF PLAN	
A6-FRONT ELEVATION, LEFT SIDE ELEVATION	
A7-BEAM ELEVATION, RIGHT SIDE ELEVATION	
A8-SECTION THRU - A, SECTION THRU - B, BAY SECTION DETAIL	
A9-GROUND AND SECOND WALL FINISHES, BRW/WALL DETAIL	
A10-THIRD AND FOURTH WALL FINISHES	
A11-SETH AND ROOF DECK WALL FINISHES	
A12-GROUND AND THIRD FLOOR FINISHES	
A13-FOURTH AND ROOF DECK FLOOR FINISHES	
A14-GROUND AND SECOND DECK	
A15-THIRD AND FOURTH DECK	
A16-FIFTH AND ROOF DECK DECK	
A17-STAR STAIR DETAIL	
A18-TYPICAL STAIR DETAIL	
A19-TYPICAL STAIR DETAIL	
A20-FIRE EXIT STAIR DETAIL	
A21-FIRE EXIT STAIR DETAIL	
A22-FIRE EXIT STAIR DETAIL	
A23-FIRE EXIT STAIR DETAIL	
A24-FIRE EXIT STAIR DETAIL	
A25-FIRE EXIT STAIR DETAIL	
A26-FIRE EXIT STAIR DETAIL	
A27-FIRE EXIT STAIR DETAIL	
A28-FIRE EXIT STAIR DETAIL	
A29-FIRE EXIT STAIR DETAIL	
A30-FIRE EXIT STAIR DETAIL	
A31-FIRE EXIT STAIR DETAIL	
A32-FIRE EXIT STAIR DETAIL	
A33-FIRE EXIT STAIR DETAIL	
A34-FIRE EXIT STAIR DETAIL	
A35-FIRE EXIT STAIR DETAIL	
A36-FIRE EXIT STAIR DETAIL	
A37-FIRE EXIT STAIR DETAIL	
A38-FIRE EXIT STAIR DETAIL	
A39-FIRE EXIT STAIR DETAIL	
A40-FIRE EXIT STAIR DETAIL	
A41-FIRE EXIT STAIR DETAIL	
A42-FIRE EXIT STAIR DETAIL	
A43-FIRE EXIT STAIR DETAIL	
A44-FIRE EXIT STAIR DETAIL	
A45-FIRE EXIT STAIR DETAIL	
A46-FIRE EXIT STAIR DETAIL	
A47-FIRE EXIT STAIR DETAIL	
A48-FIRE EXIT STAIR DETAIL	
A49-FIRE EXIT STAIR DETAIL	
A50-FIRE EXIT STAIR DETAIL	
A51-FIRE EXIT STAIR DETAIL	
A52-FIRE EXIT STAIR DETAIL	
A53-FIRE EXIT STAIR DETAIL	
A54-FIRE EXIT STAIR DETAIL	
A55-FIRE EXIT STAIR DETAIL	
A56-FIRE EXIT STAIR DETAIL	
A57-FIRE EXIT STAIR DETAIL	
A58-FIRE EXIT STAIR DETAIL	
A59-FIRE EXIT STAIR DETAIL	
A60-FIRE EXIT STAIR DETAIL	
A61-FIRE EXIT STAIR DETAIL	
A62-FIRE EXIT STAIR DETAIL	
A63-FIRE EXIT STAIR DETAIL	
A64-FIRE EXIT STAIR DETAIL	
A65-FIRE EXIT STAIR DETAIL	
A66-FIRE EXIT STAIR DETAIL	
A67-FIRE EXIT STAIR DETAIL	
A68-FIRE EXIT STAIR DETAIL	
A69-FIRE EXIT STAIR DETAIL	
A70-FIRE EXIT STAIR DETAIL	
A71-FIRE EXIT STAIR DETAIL	
A72-FIRE EXIT STAIR DETAIL	
A73-FIRE EXIT STAIR DETAIL	
A74-FIRE EXIT STAIR DETAIL	
A75-FIRE EXIT STAIR DETAIL	
A76-FIRE EXIT STAIR DETAIL	
A77-FIRE EXIT STAIR DETAIL	
A78-FIRE EXIT STAIR DETAIL	
A79-FIRE EXIT STAIR DETAIL	
A80-FIRE EXIT STAIR DETAIL	
A81-FIRE EXIT STAIR DETAIL	
A82-FIRE EXIT STAIR DETAIL	
A83-FIRE EXIT STAIR DETAIL	
A84-FIRE EXIT STAIR DETAIL	
A85-FIRE EXIT STAIR DETAIL	
A86-FIRE EXIT STAIR DETAIL	
A87-FIRE EXIT STAIR DETAIL	
A88-FIRE EXIT STAIR DETAIL	
A89-FIRE EXIT STAIR DETAIL	
A90-FIRE EXIT STAIR DETAIL	
A91-FIRE EXIT STAIR DETAIL	
A92-FIRE EXIT STAIR DETAIL	
A93-FIRE EXIT STAIR DETAIL	
A94-FIRE EXIT STAIR DETAIL	
A95-FIRE EXIT STAIR DETAIL	
A96-FIRE EXIT STAIR DETAIL	
A97-FIRE EXIT STAIR DETAIL	
A98-FIRE EXIT STAIR DETAIL	
A99-FIRE EXIT STAIR DETAIL	
A100-FIRE EXIT STAIR DETAIL	
A101-FIRE EXIT STAIR DETAIL	
A102-FIRE EXIT STAIR DETAIL	
A103-FIRE EXIT STAIR DETAIL	
A104-FIRE EXIT STAIR DETAIL	
A105-FIRE EXIT STAIR DETAIL	
A106-FIRE EXIT STAIR DETAIL	
A107-FIRE EXIT STAIR DETAIL	
A108-FIRE EXIT STAIR DETAIL	
A109-FIRE EXIT STAIR DETAIL	
A110-FIRE EXIT STAIR DETAIL	
A111-FIRE EXIT STAIR DETAIL	
A112-FIRE EXIT STAIR DETAIL	
A113-FIRE EXIT STAIR DETAIL	
A114-FIRE EXIT STAIR DETAIL	
A115-FIRE EXIT STAIR DETAIL	
A116-FIRE EXIT STAIR DETAIL	
A117-FIRE EXIT STAIR DETAIL	
A118-FIRE EXIT STAIR DETAIL	
A119-FIRE EXIT STAIR DETAIL	
A120-FIRE EXIT STAIR DETAIL	
A121-FIRE EXIT STAIR DETAIL	
A122-FIRE EXIT STAIR DETAIL	
A123-FIRE EXIT STAIR DETAIL	
A124-FIRE EXIT STAIR DETAIL	
A125-FIRE EXIT STAIR DETAIL	
A126-FIRE EXIT STAIR DETAIL	
A127-FIRE EXIT STAIR DETAIL	
A128-FIRE EXIT STAIR DETAIL	
A129-FIRE EXIT STAIR DETAIL	
A130-FIRE EXIT STAIR DETAIL	
A131-FIRE EXIT STAIR DETAIL	
A132-FIRE EXIT STAIR DETAIL	
A133-FIRE EXIT STAIR DETAIL	
A134-FIRE EXIT STAIR DETAIL	
A135-FIRE EXIT STAIR DETAIL	
A136-FIRE EXIT STAIR DETAIL	
A137-FIRE EXIT STAIR DETAIL	
A138-FIRE EXIT STAIR DETAIL	
A139-FIRE EXIT STAIR DETAIL	
A140-FIRE EXIT STAIR DETAIL	
A141-FIRE EXIT STAIR DETAIL	
A142-FIRE EXIT STAIR DETAIL	
A143-FIRE EXIT STAIR DETAIL	
A144-FIRE EXIT STAIR DETAIL	
A145-FIRE EXIT STAIR DETAIL	
A146-FIRE EXIT STAIR DETAIL	
A147-FIRE EXIT STAIR DETAIL	
A148-FIRE EXIT STAIR DETAIL	
A149-FIRE EXIT STAIR DETAIL	
A150-FIRE EXIT STAIR DETAIL	
A151-FIRE EXIT STAIR DETAIL	
A152-FIRE EXIT STAIR DETAIL	
A153-FIRE EXIT STAIR DETAIL	
A154-FIRE EXIT STAIR DETAIL	
A155-FIRE EXIT STAIR DETAIL	
A156-FIRE EXIT STAIR DETAIL	
A157-FIRE EXIT STAIR DETAIL	
A158-FIRE EXIT STAIR DETAIL	
A159-FIRE EXIT STAIR DETAIL	
A160-FIRE EXIT STAIR DETAIL	
A161-FIRE EXIT STAIR DETAIL	
A162-FIRE EXIT STAIR DETAIL	
A163-FIRE EXIT STAIR DETAIL	
A164-FIRE EXIT STAIR DETAIL	
A165-FIRE EXIT STAIR DETAIL	
A166-FIRE EXIT STAIR DETAIL	
A167-FIRE EXIT STAIR DETAIL	
A168-FIRE EXIT STAIR DETAIL	
A169-FIRE EXIT STAIR DETAIL	
A170-FIRE EXIT STAIR DETAIL	
A171-FIRE EXIT STAIR DETAIL	
A172-FIRE EXIT STAIR DETAIL	
A173-FIRE EXIT STAIR DETAIL	
A174-FIRE EXIT STAIR DETAIL	
A175-FIRE EXIT STAIR DETAIL	
A176-FIRE EXIT STAIR DETAIL	
A177-FIRE EXIT STAIR DETAIL	
A178-FIRE EXIT STAIR DETAIL	
A179-FIRE EXIT STAIR DETAIL	
A180-FIRE EXIT STAIR DETAIL	
A181-FIRE EXIT STAIR DETAIL	
A182-FIRE EXIT STAIR DETAIL	
A183-FIRE EXIT STAIR DETAIL	
A184-FIRE EXIT STAIR DETAIL	
A185-FIRE EXIT STAIR DETAIL	
A186-FIRE EXIT STAIR DETAIL	
A187-FIRE EXIT STAIR DETAIL	
A188-FIRE EXIT STAIR DETAIL	
A189-FIRE EXIT STAIR DETAIL	
A190-FIRE EXIT STAIR DETAIL	
A191-FIRE EXIT STAIR DETAIL	
A192-FIRE EXIT STAIR DETAIL	
A193-FIRE EXIT STAIR DETAIL	
A194-FIRE EXIT STAIR DETAIL	
A195-FIRE EXIT STAIR DETAIL	
A196-FIRE EXIT STAIR DETAIL	
A197-FIRE EXIT STAIR DETAIL	
A198-FIRE EXIT STAIR DETAIL	
A199-FIRE EXIT STAIR DETAIL	
A200-FIRE EXIT STAIR DETAIL	

RECOMMENDING APPROVAL:  
**ATTY - ERWIN B. BUSTO**  
DIRECTOR, PRTS

REPUBLIC OF THE PHILIPPINES  
OFFICE OF THE BUILDING OFFICIAL  
WILAMBUENA, MICHAS OBENAL



APPROVED BY:

- GENERAL NOTES:**
1. ALL DIMENSIONS SHALL BE IN METERS UNLESS OTHERWISE SPECIFIED.
  2. ALL DIMENSIONS ARE TO FACE UNLESS OTHERWISE SPECIFIED.
  3. ALL DIMENSIONS ARE TO FACE UNLESS OTHERWISE SPECIFIED.
  4. ALL DIMENSIONS ARE TO FACE UNLESS OTHERWISE SPECIFIED.
  5. ALL DIMENSIONS ARE TO FACE UNLESS OTHERWISE SPECIFIED.
  6. ALL DIMENSIONS ARE TO FACE UNLESS OTHERWISE SPECIFIED.
  7. ALL DIMENSIONS ARE TO FACE UNLESS OTHERWISE SPECIFIED.
  8. ALL DIMENSIONS ARE TO FACE UNLESS OTHERWISE SPECIFIED.
  9. ALL DIMENSIONS ARE TO FACE UNLESS OTHERWISE SPECIFIED.
  10. ALL DIMENSIONS ARE TO FACE UNLESS OTHERWISE SPECIFIED.
  11. ALL DIMENSIONS ARE TO FACE UNLESS OTHERWISE SPECIFIED.
  12. ALL DIMENSIONS ARE TO FACE UNLESS OTHERWISE SPECIFIED.
  13. ALL DIMENSIONS ARE TO FACE UNLESS OTHERWISE SPECIFIED.
  14. ALL DIMENSIONS ARE TO FACE UNLESS OTHERWISE SPECIFIED.
  15. ALL DIMENSIONS ARE TO FACE UNLESS OTHERWISE SPECIFIED.
  16. ALL DIMENSIONS ARE TO FACE UNLESS OTHERWISE SPECIFIED.
  17. ALL DIMENSIONS ARE TO FACE UNLESS OTHERWISE SPECIFIED.
  18. ALL DIMENSIONS ARE TO FACE UNLESS OTHERWISE SPECIFIED.
  19. ALL DIMENSIONS ARE TO FACE UNLESS OTHERWISE SPECIFIED.
  20. ALL DIMENSIONS ARE TO FACE UNLESS OTHERWISE SPECIFIED.

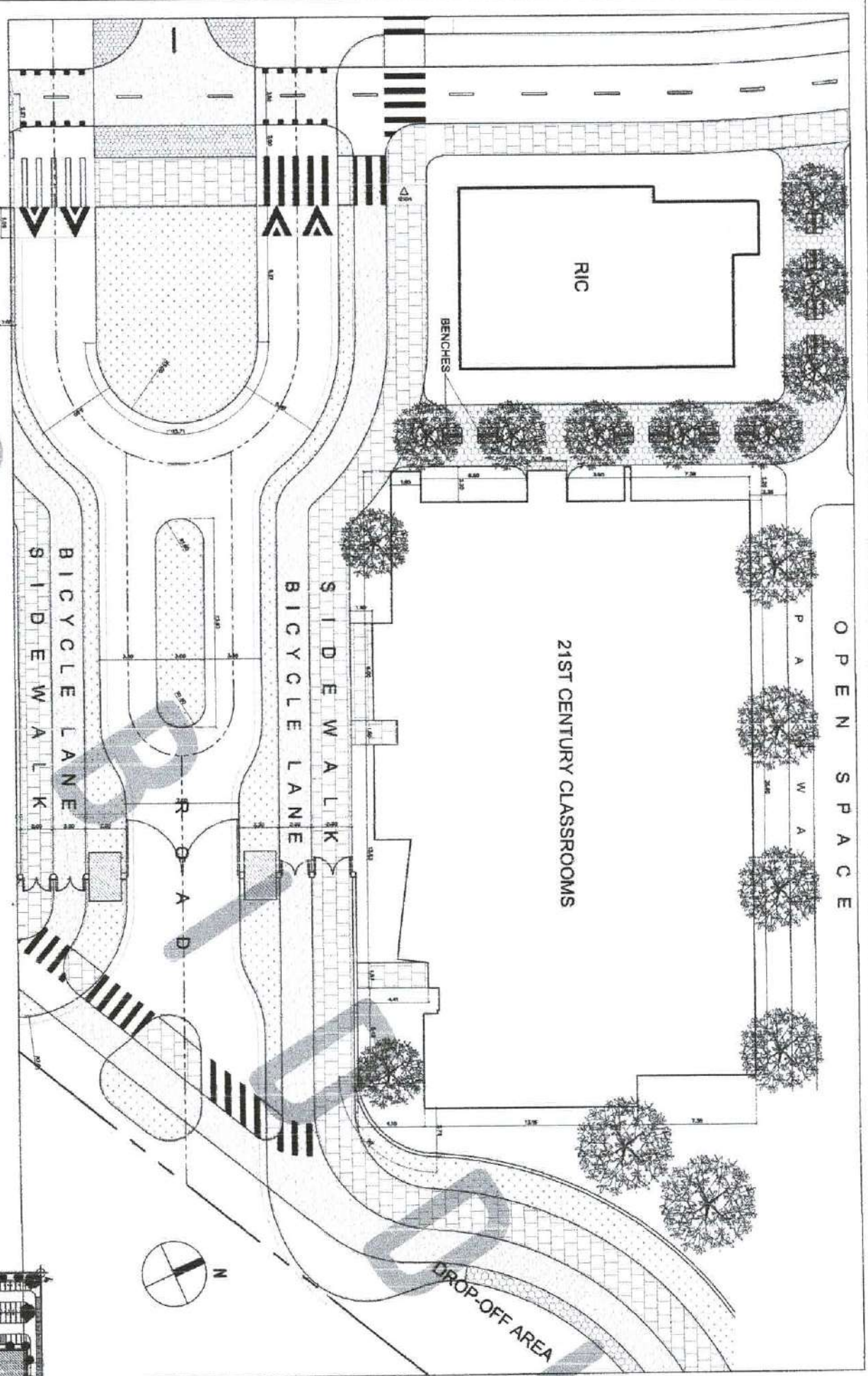

611 SCALE 1:150MTRS  
SITE DEVELOPMENT PLAN

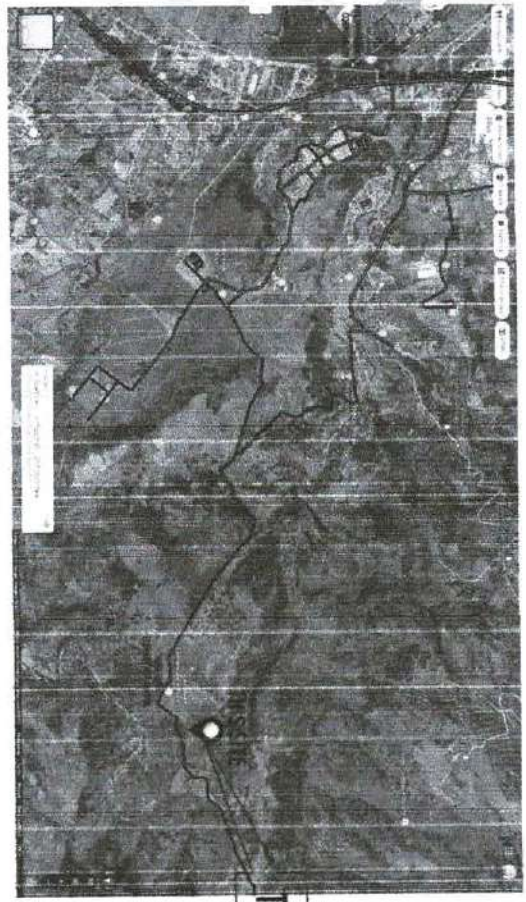
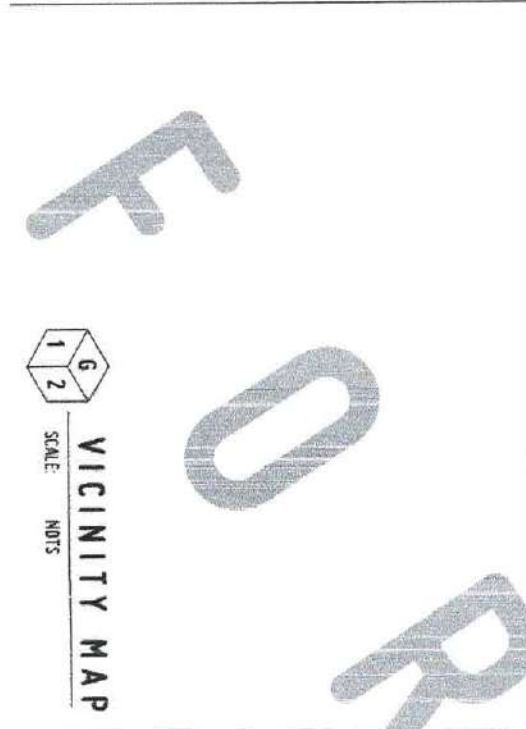

613 SCALE 1:1200MTRS  
LOCATION PLAN

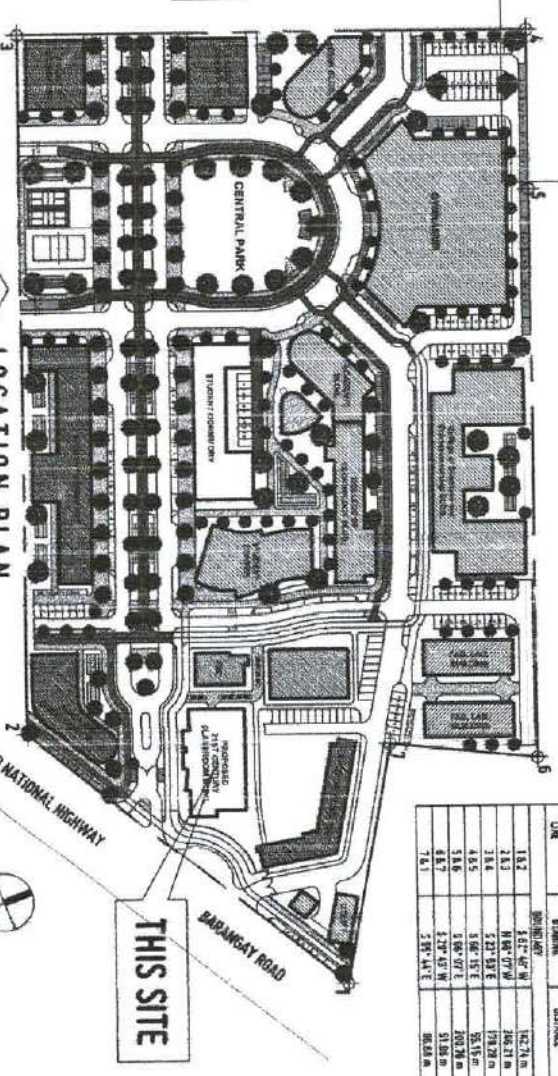

LINE	DESCRIPTION	DISTANCE
1.1.2	1.1.2	142.71 m
1.1.3	1.1.3	198.29 m
1.1.4	1.1.4	178.29 m
1.1.5	1.1.5	55.15 m
1.1.6	1.1.6	202.78 m
1.1.7	1.1.7	118.89 m
1.1.8	1.1.8	82.84 m



REPUBLIC OF THE PHILIPPINES  
UNIVERSITY OF SCIENCE AND TECHNOLOGY OF SOUTHERN PHILIPPINES  
CLAYTON DE ORO CAMPUS  
HEADS RCTING PLANNING AND FACILITY DEVELOPMENT UNIT  
CLAYTON DE ORO CAMPUS, CANTON DE ORO CITY 8000  
TEL: (083) 7-66-85 / (083) 7-66-139 / (083) 7-66-139 (TEL FAX ROOM 89-468)  
WEBSITE: www.ustip.edu.ph

PROJECT	OWNER
PROPOSED 21ST CENTURY 5 STOREY CLASSROOM BUILDING	UNIVERSITY OF SCIENCE AND TECHNOLOGY OF SOUTHERN PHILIPPINES

PROJECT	OWNER
PROPOSED 21ST CENTURY 5 STOREY CLASSROOM BUILDING	UNIVERSITY OF SCIENCE AND TECHNOLOGY OF SOUTHERN PHILIPPINES

PROJECT	OWNER
PROPOSED 21ST CENTURY 5 STOREY CLASSROOM BUILDING	UNIVERSITY OF SCIENCE AND TECHNOLOGY OF SOUTHERN PHILIPPINES

RECOMMENDING APPROVAL  
ATTESTATION  
DIRECTOR

RECOMMENDING APPROVAL  
ATTESTATION  
DIRECTOR

APPROVED BY:  
DR. ANGELO B. CULTURA II  
PRESIDENT, USTIP SYSTEM

APPROVED BY:  
DR. ANGELO B. CULTURA II  
PRESIDENT, USTIP SYSTEM

61



OPEN SPACE

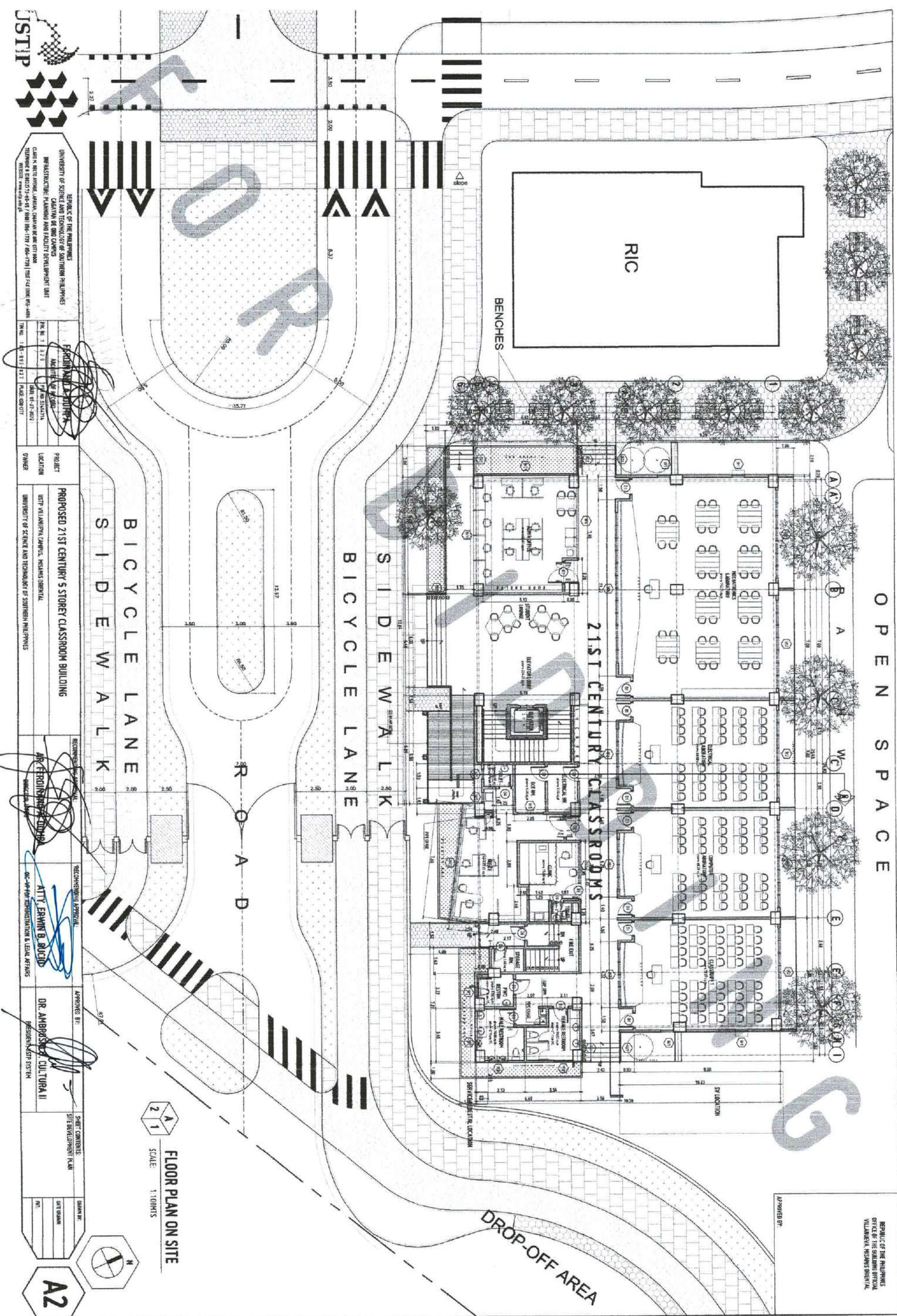

REPUBLIC OF THE PHILIPPINES  
UNIVERSITY OF SCIENCE AND TECHNOLOGY OF SOUTHERN PHILIPPINES  
INFRASTRUCTURE PLANNING AND FACILITY DEVELOPMENT UNIT  
CLAYTON AVENUE, DAVAO CITY  
TELEPHONE: 8032311-8181 / 8081 886-1179 / 806-1179 | FAX: 8081 886-4889  
WEBSITE: www.usstp.edu.ph

DESIGN AND ARCHITECTURE  
ARCHITECT OF RECORD  
DATE: 07-27-2023  
PROJECT NO.: 1-23-3  
SCALE: 1:100  
DRAWN BY: [Signature]  
CHECKED BY: [Signature]

PROJECT: PROPOSED 21ST CENTURY 5 STOREY CLASSROOM BUILDING  
LOCATION: USTP WILAMPENA CAMPUS, WISCONSIN CORRAL  
OWNER: UNIVERSITY OF SCIENCE AND TECHNOLOGY OF SOUTHERN PHILIPPINES

RECOMMENDED BY: [Signature]  
ARCHITECT OF RECORD: [Signature]

RECOMMENDATION APPROVAL:  
ATTY. EMMAN B. BUENO  
DEPUTY ADMINISTRATOR & LEGAL AFFAIRS

APPROVED BY: [Signature]  
DR. AMBROSIO A. CULTURA II  
PRESIDENT, USTP SYSTEM

SHEET CONTENTS: SITE DEVELOPMENT PLAN  
DATE: [Blank]  
NO.: [Blank]

FLOOR PLAN ON SITE  
SCALE: 1:100  
A2

REPUBLIC OF THE PHILIPPINES  
OFFICE OF THE BUILDING OFFICIAL  
WILAMPENA WISCONSIN CORRAL

APPROVED BY: [Signature]





REPUBLIC OF THE PHILIPPINES  
UNIVERSITY OF SCIENCE AND TECHNOLOGY OF SOUTHERN PHILIPPINES  
INFRASTRUCTURE PLANNING AND FACILITY DEVELOPMENT UNIT  
CLARENCE AVENUE, LAPOAN, CAGAYAN DE ORO CITY 9000  
TEL: (088) 770-0000 / 770-0001 / 770-0002 / 770-0003 / 770-0004 / 770-0005 / 770-0006 / 770-0007 / 770-0008 / 770-0009 / 770-0010  
WWW.USTIP.UTSOU.PH

PROJECT: FERDINAND ALDRIPA  
ARCHITECT OF RECORD: FERDINAND ALDRIPA  
DATE: 04-13-2023  
PROJECT NO.: 185-13-23-017  
PLACE: CDO CITY

PROPOSED 21ST CENTURY 5 STOREY CLASSROOM BUILDING  
LOCATION: USTIP VILLAMORIA CAMPUS, HIGASAS ORIENTAL  
OWNER: UNIVERSITY OF SCIENCE AND TECHNOLOGY OF SOUTHERN PHILIPPINES

RECOMMENDING APPROVAL:  
DR. FERDINAND ALDRIPA  
DIRECTOR, USTIP

RECOMMENDING APPROVAL:  
ATTY. ERWIN B. BUENO  
D.C. - VP FOR ADMINISTRATION & LEGAL AFFAIRS

APPROVED BY:  
DR. AMBRISHERA CULTURA II  
PRESIDENT, USTIP SYSTEM

SHEET CONTENTS:  
GROUND FLOOR PLAN  
SECOND FLOOR PLAN

DATE SHOWN:  
SCALE:  
DRAWN BY:  
CHECKED BY:  
APPROVED BY:

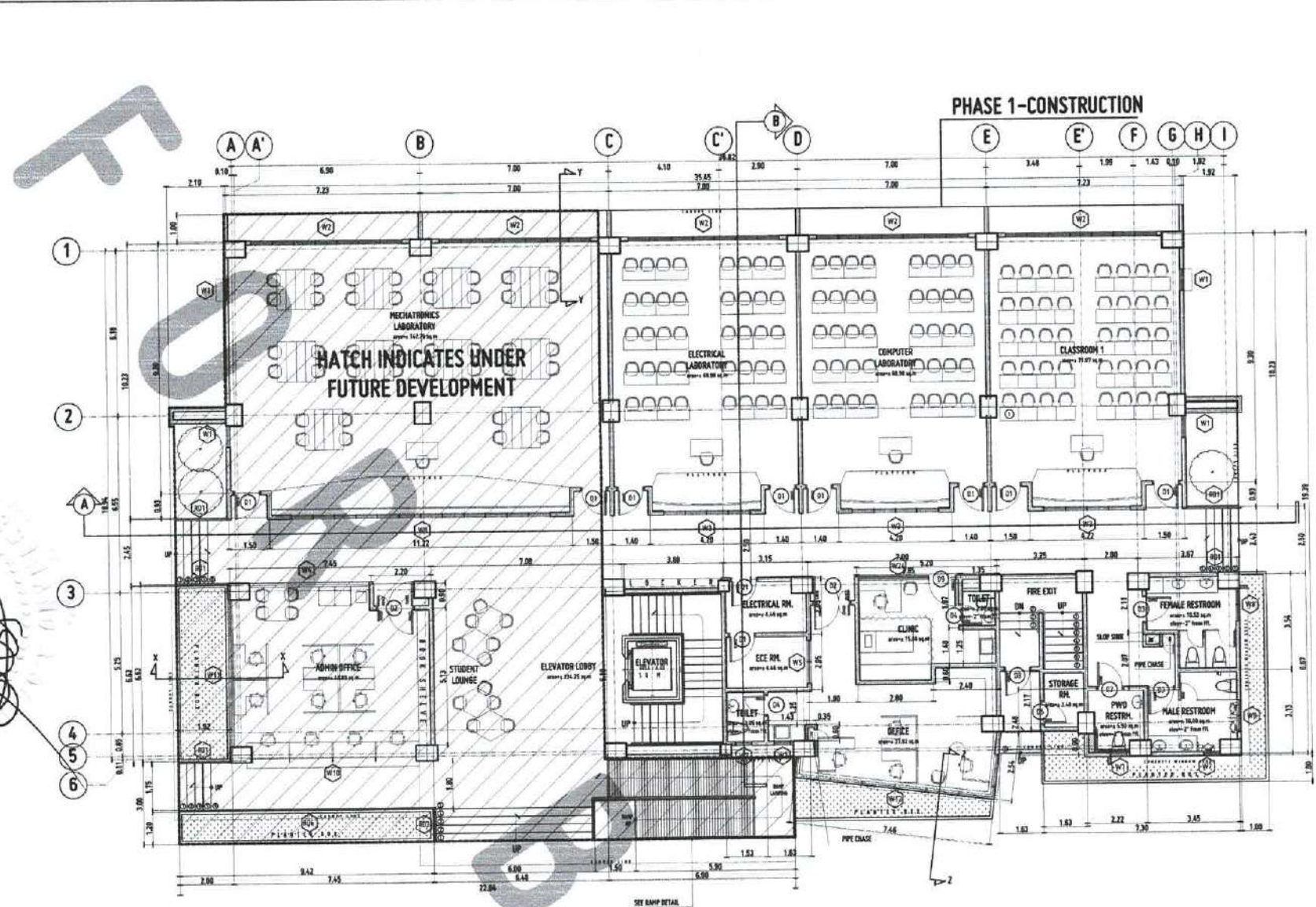

**GROUND FLOOR PLAN-Phase 1 Construction**  
SCALE: 1:100 MTS

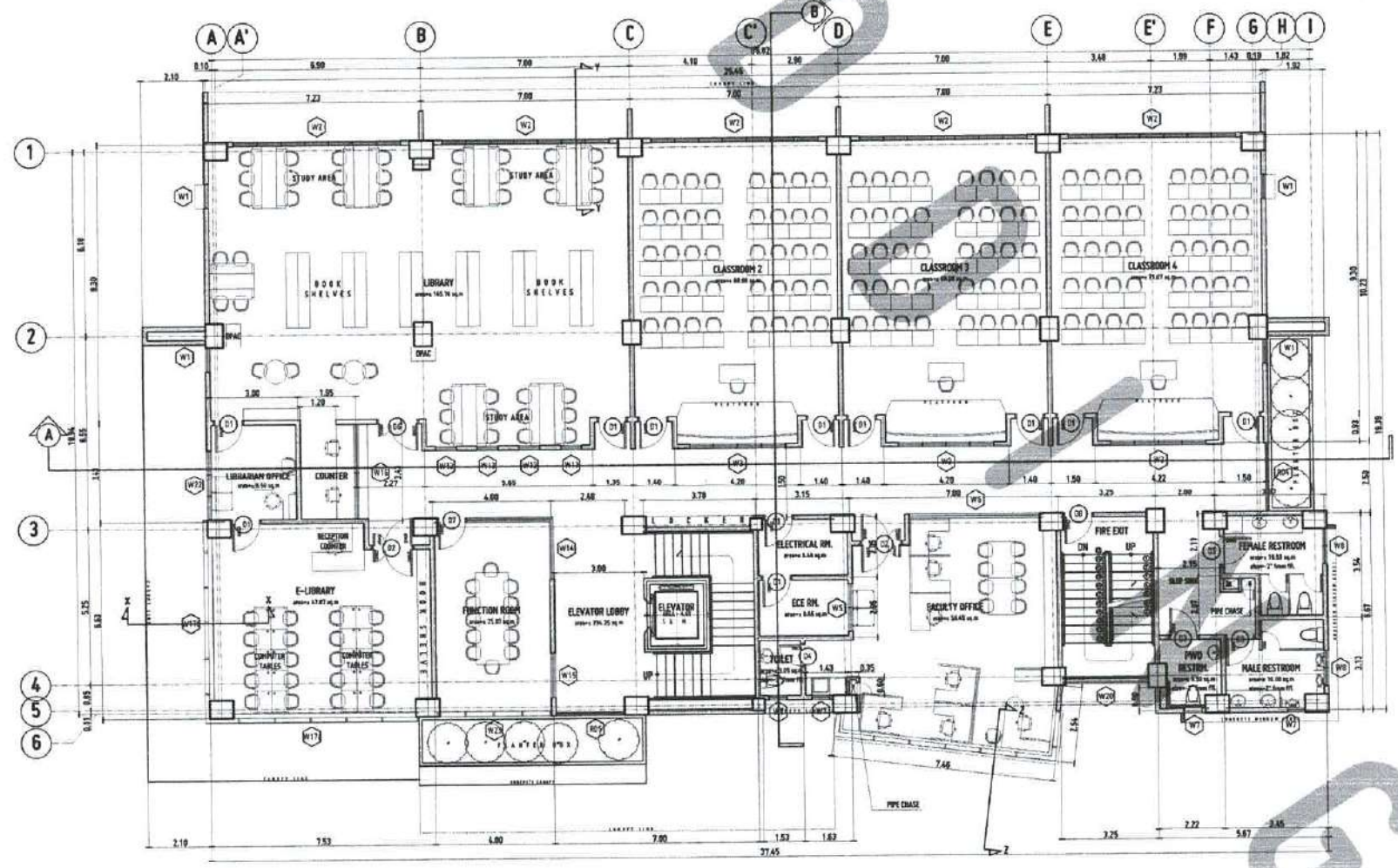

**SECOND FLOOR PLAN-for future development**  
SCALE: 1:100 MTS

RECOMMENDING APPROVAL:  
DR. FERDINAND ALDRIPA  
DIRECTOR, USTIP

RECOMMENDING APPROVAL:  
ATTY. ERWIN B. BUENO  
D.C. - VP FOR ADMINISTRATION & LEGAL AFFAIRS

APPROVED BY:  
DR. AMBRISHERA CULTURA II  
PRESIDENT, USTIP SYSTEM

SHEET CONTENTS:  
GROUND FLOOR PLAN  
SECOND FLOOR PLAN

DATE SHOWN:  
SCALE:  
DRAWN BY:  
CHECKED BY:  
APPROVED BY:

REPUBLIC OF THE PHILIPPINES  
OFFICE OF THE BUILDING OFFICIAL  
VILLAMORIA, HIGASAS ORIENTAL

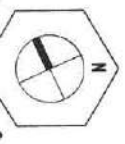

A3



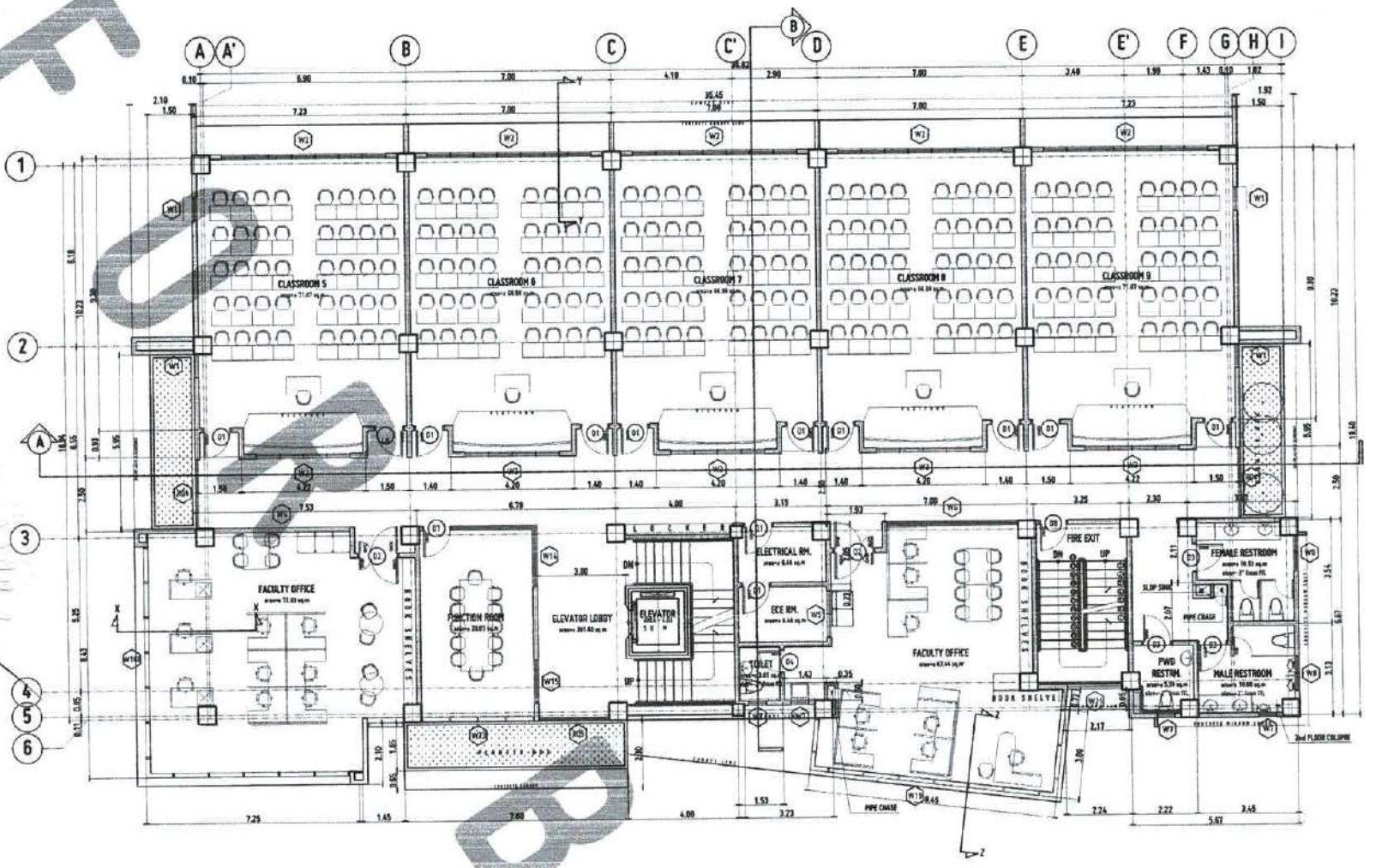

**THIRD FLOOR PLAN - for future development**  
SCALE: 1:100 MTS

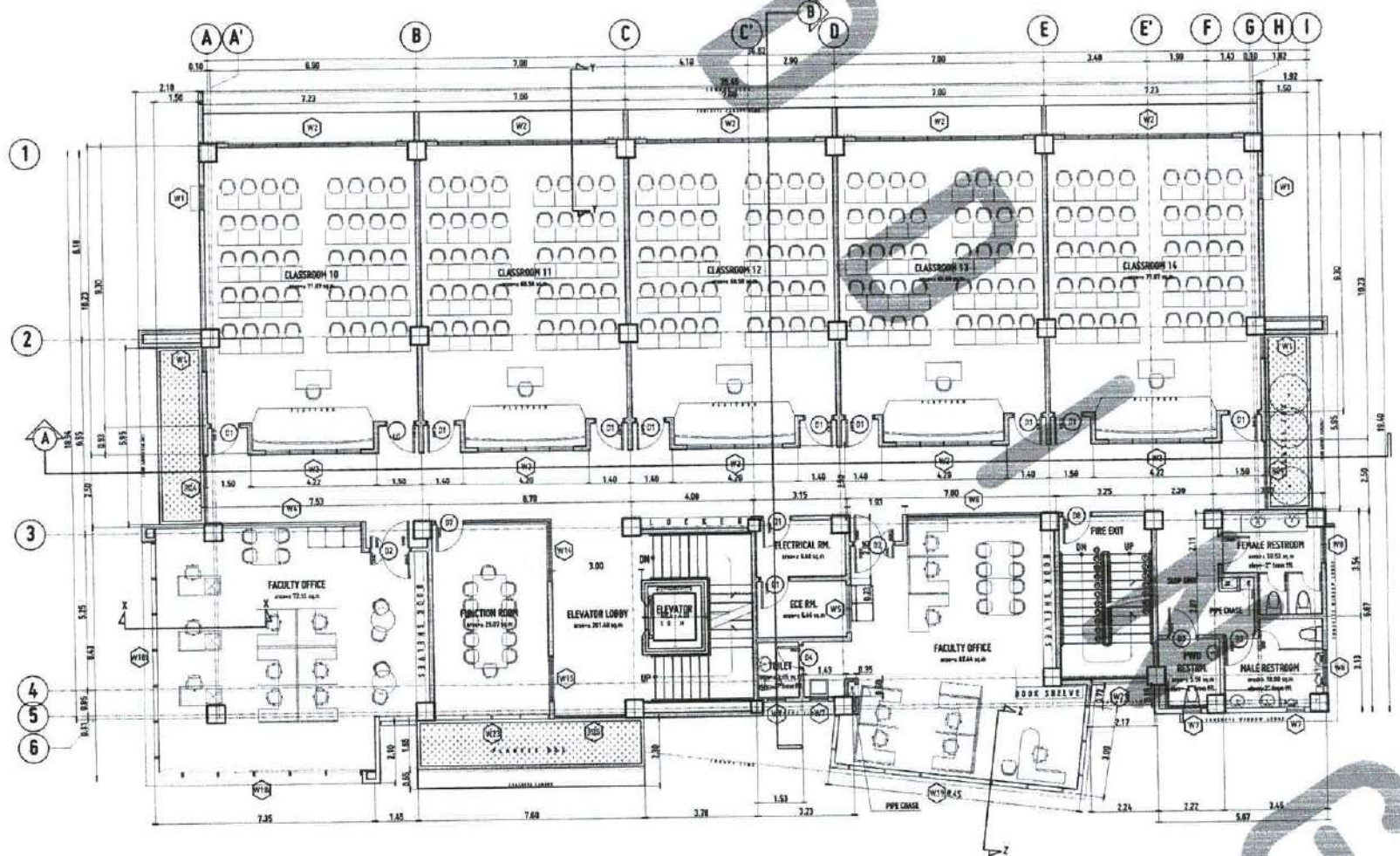

**FOURTH FLOOR PLAN - for future development**  
SCALE: 1:100 MTS

- REVISIONS:
1. ALL DIMENSIONS SHALL BE IN METERS UNLESS OTHERWISE SPECIFIED.
  2. ALL WALLS SHALL BE 100MM THICK UNLESS OTHERWISE SPECIFIED.
  3. ALL FLOORS SHALL BE FINISHED WITH 75MM COMPACTED GRAVEL ON 100MM SAND AND 75MM FINISH FLOORING.
  4. ALL ROOFS SHALL BE FINISHED WITH 100MM COMPACTED GRAVEL ON 100MM SAND AND 75MM FINISH FLOORING.
  5. ALL CEILING SHALL BE FINISHED WITH 100MM COMPACTED GRAVEL ON 100MM SAND AND 75MM FINISH FLOORING.
  6. ALL LIGHTING SHALL BE FINISHED WITH 100MM COMPACTED GRAVEL ON 100MM SAND AND 75MM FINISH FLOORING.
  7. ALL PAINTING SHALL BE FINISHED WITH 100MM COMPACTED GRAVEL ON 100MM SAND AND 75MM FINISH FLOORING.
  8. ALL DOORS SHALL BE FINISHED WITH 100MM COMPACTED GRAVEL ON 100MM SAND AND 75MM FINISH FLOORING.
  9. ALL WINDOWS SHALL BE FINISHED WITH 100MM COMPACTED GRAVEL ON 100MM SAND AND 75MM FINISH FLOORING.
  10. ALL STAIRS SHALL BE FINISHED WITH 100MM COMPACTED GRAVEL ON 100MM SAND AND 75MM FINISH FLOORING.
  11. ALL ELEVATORS SHALL BE FINISHED WITH 100MM COMPACTED GRAVEL ON 100MM SAND AND 75MM FINISH FLOORING.
  12. ALL CORRIDORS SHALL BE FINISHED WITH 100MM COMPACTED GRAVEL ON 100MM SAND AND 75MM FINISH FLOORING.
  13. ALL Lobbies SHALL BE FINISHED WITH 100MM COMPACTED GRAVEL ON 100MM SAND AND 75MM FINISH FLOORING.
  14. ALL RESTROOMS SHALL BE FINISHED WITH 100MM COMPACTED GRAVEL ON 100MM SAND AND 75MM FINISH FLOORING.
  15. ALL FUNCTION ROOMS SHALL BE FINISHED WITH 100MM COMPACTED GRAVEL ON 100MM SAND AND 75MM FINISH FLOORING.
  16. ALL FACULTY OFFICES SHALL BE FINISHED WITH 100MM COMPACTED GRAVEL ON 100MM SAND AND 75MM FINISH FLOORING.
  17. ALL CLASSROOMS SHALL BE FINISHED WITH 100MM COMPACTED GRAVEL ON 100MM SAND AND 75MM FINISH FLOORING.
  18. ALL STAIRS SHALL BE FINISHED WITH 100MM COMPACTED GRAVEL ON 100MM SAND AND 75MM FINISH FLOORING.
  19. ALL ELEVATORS SHALL BE FINISHED WITH 100MM COMPACTED GRAVEL ON 100MM SAND AND 75MM FINISH FLOORING.
  20. ALL CORRIDORS SHALL BE FINISHED WITH 100MM COMPACTED GRAVEL ON 100MM SAND AND 75MM FINISH FLOORING.