

THIRD FLOOR PLAN-REFLECTED CEILING PLAN-for future development
SCALE: 1:100 MTS

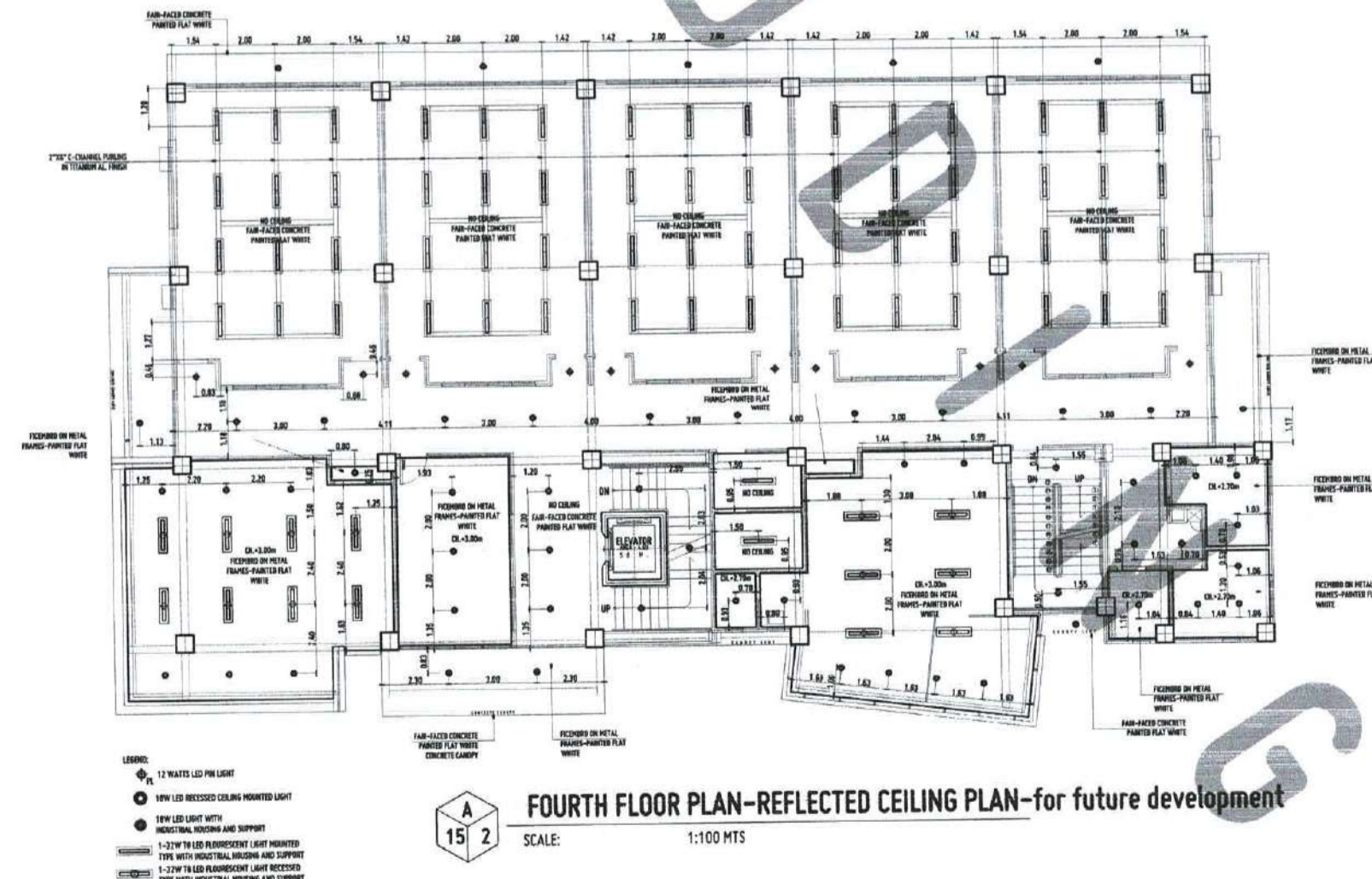

FOURTH FLOOR PLAN-REFLECTED CEILING PLAN-for future development
SCALE: 1:100 MTS

APPROVED BY:
[Signature]

REVISIONS:
1. TO CORRECT THE LIGHTING FIXTURES AND DIMENSIONS.
2. TO CORRECT THE LIGHTING FIXTURES AND DIMENSIONS.
3. TO CORRECT THE LIGHTING FIXTURES AND DIMENSIONS.
4. TO CORRECT THE LIGHTING FIXTURES AND DIMENSIONS.
5. TO CORRECT THE LIGHTING FIXTURES AND DIMENSIONS.
6. TO CORRECT THE LIGHTING FIXTURES AND DIMENSIONS.
7. TO CORRECT THE LIGHTING FIXTURES AND DIMENSIONS.
8. TO CORRECT THE LIGHTING FIXTURES AND DIMENSIONS.
9. TO CORRECT THE LIGHTING FIXTURES AND DIMENSIONS.
10. TO CORRECT THE LIGHTING FIXTURES AND DIMENSIONS.

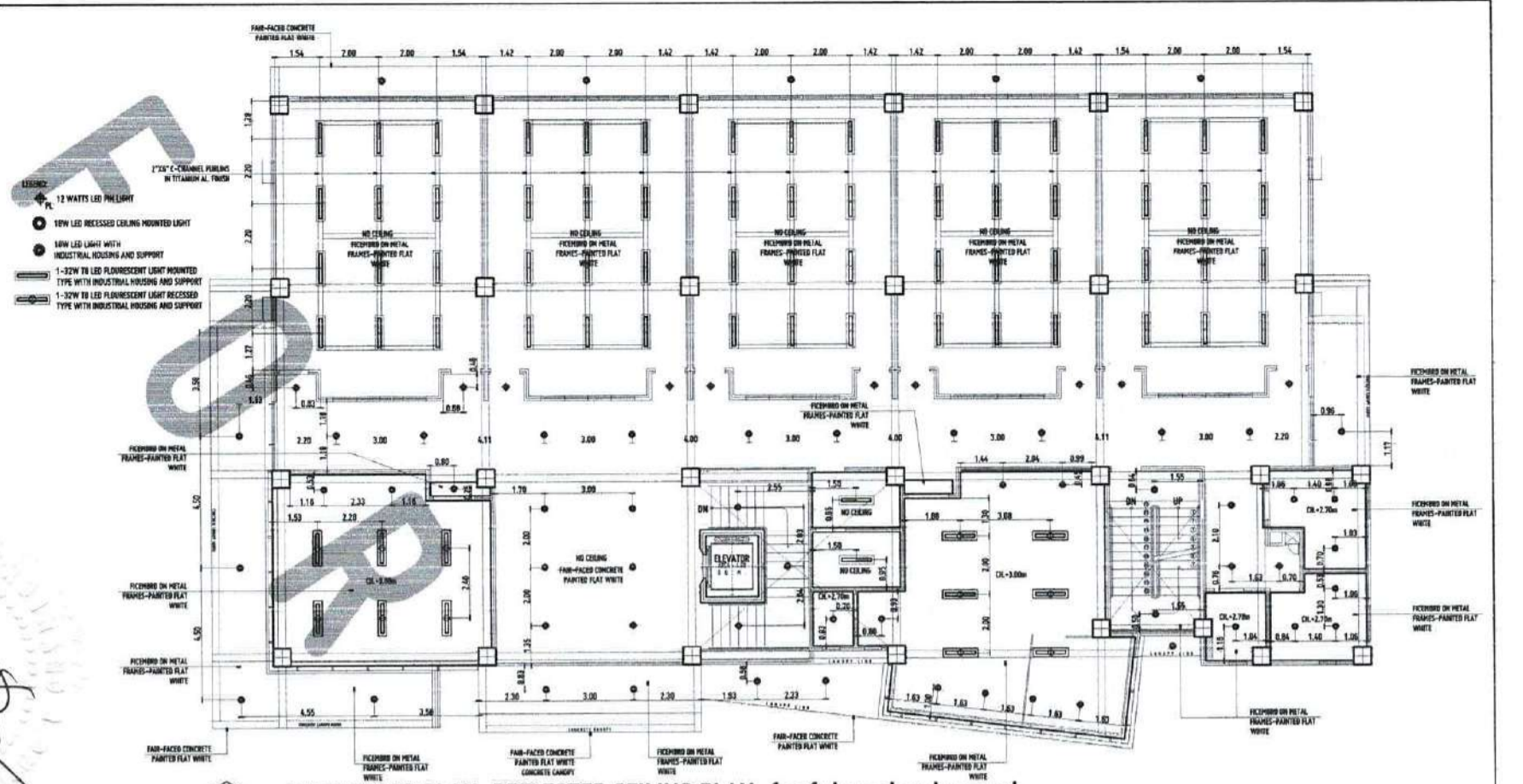

A 16 1 FIFTH FLOOR PLAN-REFLECTED CEILING PLAN-for future development
SCALE: 1:100 MTS

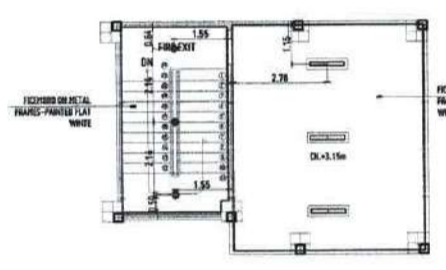

A 16 2 ROOF DECK PLAN
SCALE: 1:100 MTS

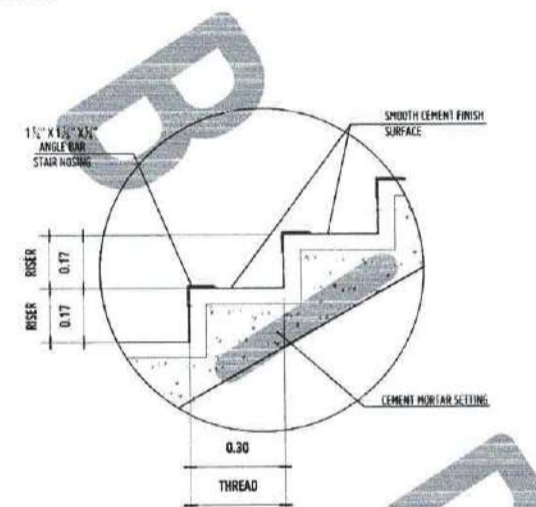

A 16 4 TYPICAL STAIR NOSING DETAIL
SCALE: 1:10 MTS

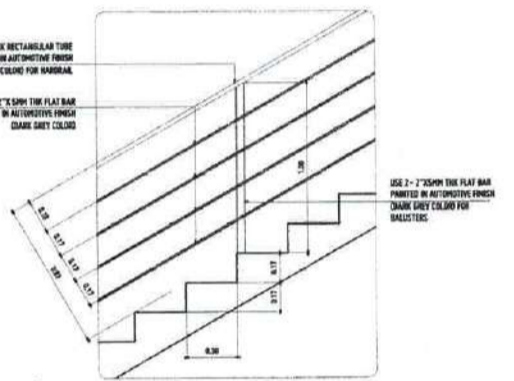

A 16 5 MAIN STAIR RAILING DETAIL
SCALE: 1:20 MTS

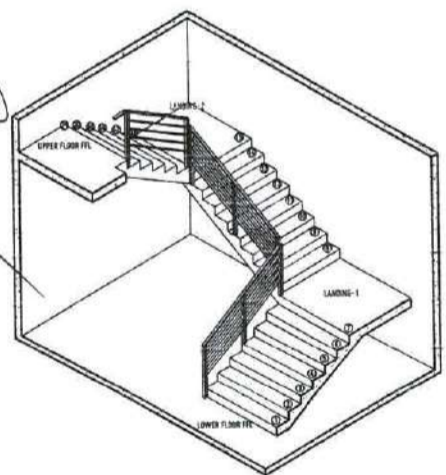

A 16 6 MAIN STAIR ISOMETRIC VIEW
SCALE: N.D.T.S.

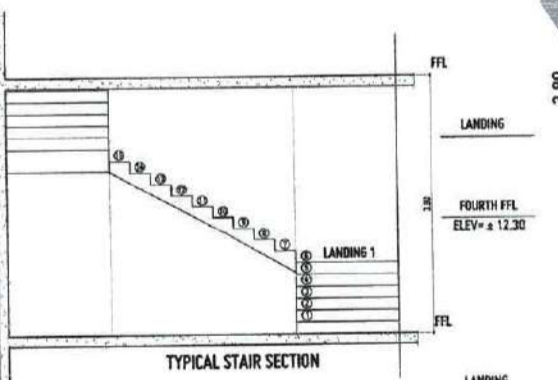

TYPICAL STAIR SECTION

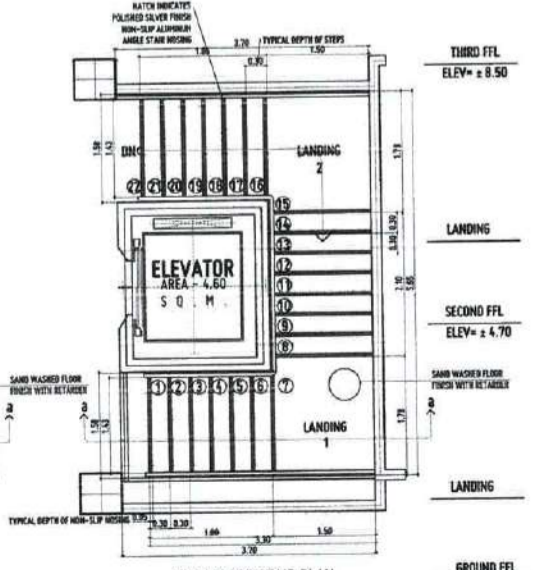
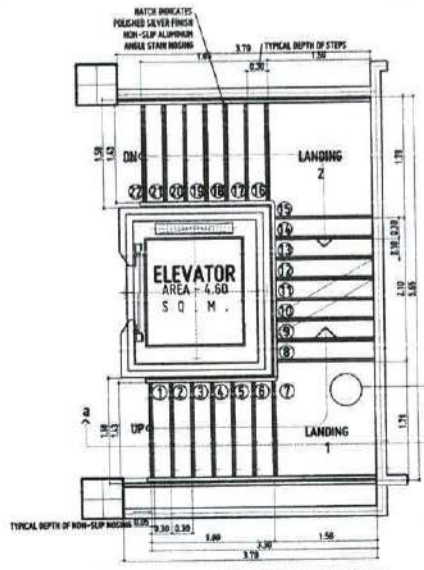

A 16 3 MAIN STAIR DETAIL
SCALE: 1:50 MTS

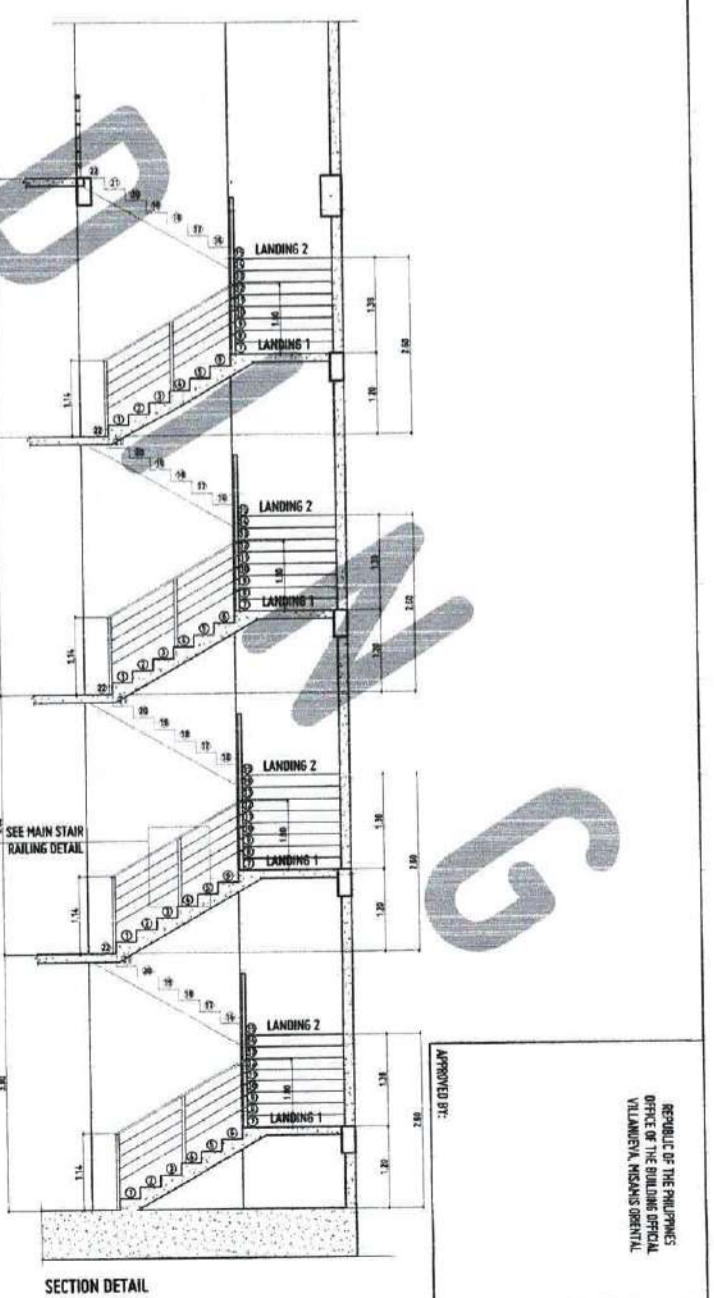

SECTION DETAIL

APPROVED BY:

- 1. ALL DIMENSIONS ARE TO FACE UNLESS OTHERWISE SPECIFIED.
- 2. ALL DIMENSIONS ARE TO FACE UNLESS OTHERWISE SPECIFIED.
- 3. ALL DIMENSIONS ARE TO FACE UNLESS OTHERWISE SPECIFIED.
- 4. ALL DIMENSIONS ARE TO FACE UNLESS OTHERWISE SPECIFIED.
- 5. ALL DIMENSIONS ARE TO FACE UNLESS OTHERWISE SPECIFIED.
- 6. ALL DIMENSIONS ARE TO FACE UNLESS OTHERWISE SPECIFIED.
- 7. ALL DIMENSIONS ARE TO FACE UNLESS OTHERWISE SPECIFIED.
- 8. ALL DIMENSIONS ARE TO FACE UNLESS OTHERWISE SPECIFIED.
- 9. ALL DIMENSIONS ARE TO FACE UNLESS OTHERWISE SPECIFIED.
- 10. ALL DIMENSIONS ARE TO FACE UNLESS OTHERWISE SPECIFIED.

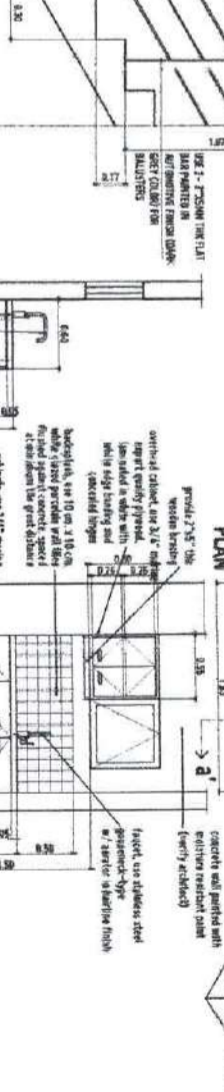
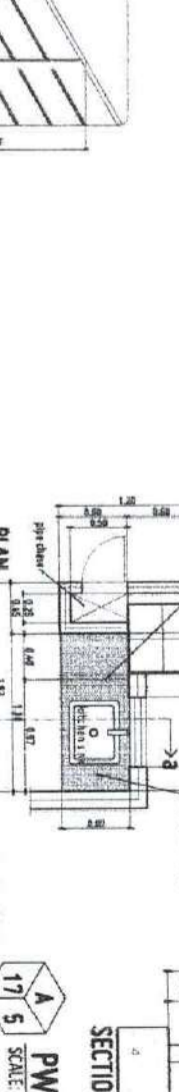
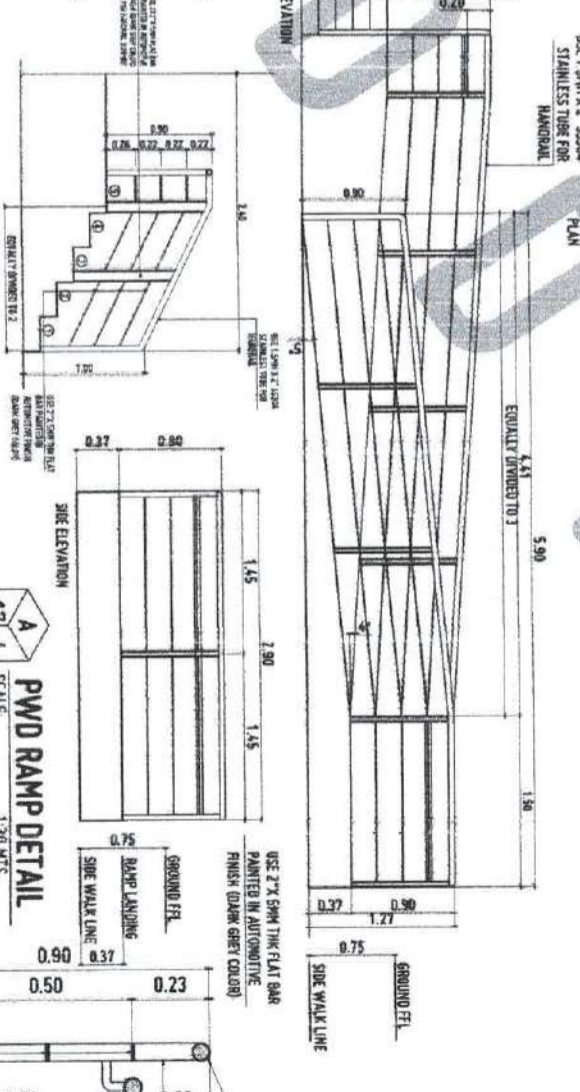
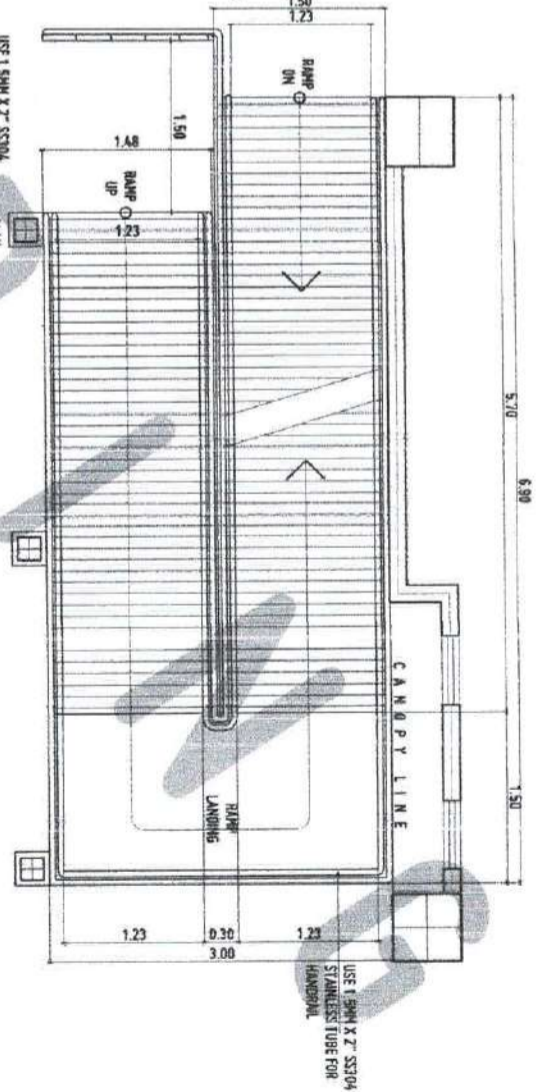

OFFICE SINK DETAIL
SCALE: 1:30 MTS

PWD RAMP RAILING DETAIL
SCALE: 1:20 MTS

PWD RAMP DETAIL
SCALE: 1:30 MTS

PWD RAMP DETAIL
SCALE: 1:30 MTS

FIRE EXIT RAILING DETAIL
SCALE: 1:20 MTS

FIRE EXIT STAIR SECTION DETAIL
SCALE: 1:50 MTS

TYPICAL STAIR NOSING DETAIL
SCALE: 1:10 MTS

FIRE EXIT STAIR SECTION DETAIL
SCALE: 1:50 MTS

FIRE EXIT STAIR SECTION DETAIL
SCALE: 1:50 MTS



UNIVERSITY OF THE PHILIPPINES
OFFICE OF THE BIDDING OFFICIAL
WILLAMENA, HINSAWAN ORIENTAL

REPUBLIC OF THE PHILIPPINES
UNIVERSITY OF THE PHILIPPINES
OFFICE OF THE BIDDING OFFICIAL
WILLAMENA, HINSAWAN ORIENTAL

PROPOSED 21ST CENTURY 5 STOREY CLASSROOM BUILDING
OWNER: UNIVERSITY OF THE PHILIPPINES
LOCATION: USTP WILLAMENA CAMPUS, HINSAWAN ORIENTAL

RECOMMENDED APPROVALS
APPROVED BY: DR. AMERSON CUL TURA II
PRESIDENT, USTP SYSTEM

A17

APPROVED BY:

USE 1.5MM X 2.75MM
STAINLESS TUBE FOR
HANDRAIL

USE 2.7X 3MM THK FLAT BAR
PAINTED IN AUTOMATIC
FINISH (DARK GREY COLOR)

USE 1.5MM X 2.75MM
STAINLESS TUBE FOR
HANDRAIL

USE 2.7X 3MM THK FLAT BAR
PAINTED IN AUTOMATIC
FINISH (DARK GREY COLOR)

USE 2.7X 3MM THK FLAT BAR
PAINTED IN AUTOMATIC
FINISH (DARK GREY COLOR)

USE 2.7X 3MM THK FLAT BAR
PAINTED IN AUTOMATIC
FINISH (DARK GREY COLOR)

USE 2.7X 3MM THK FLAT BAR
PAINTED IN AUTOMATIC
FINISH (DARK GREY COLOR)

USE 2.7X 3MM THK FLAT BAR
PAINTED IN AUTOMATIC
FINISH (DARK GREY COLOR)

USE 2.7X 3MM THK FLAT BAR
PAINTED IN AUTOMATIC
FINISH (DARK GREY COLOR)

USE 2.7X 3MM THK FLAT BAR
PAINTED IN AUTOMATIC
FINISH (DARK GREY COLOR)

USE 2.7X 3MM THK FLAT BAR
PAINTED IN AUTOMATIC
FINISH (DARK GREY COLOR)

USE 2.7X 3MM THK FLAT BAR
PAINTED IN AUTOMATIC
FINISH (DARK GREY COLOR)

USE 2.7X 3MM THK FLAT BAR
PAINTED IN AUTOMATIC
FINISH (DARK GREY COLOR)

USE 2.7X 3MM THK FLAT BAR
PAINTED IN AUTOMATIC
FINISH (DARK GREY COLOR)

USE 2.7X 3MM THK FLAT BAR
PAINTED IN AUTOMATIC
FINISH (DARK GREY COLOR)

USE 2.7X 3MM THK FLAT BAR
PAINTED IN AUTOMATIC
FINISH (DARK GREY COLOR)

USE 2.7X 3MM THK FLAT BAR
PAINTED IN AUTOMATIC
FINISH (DARK GREY COLOR)

USE 2.7X 3MM THK FLAT BAR
PAINTED IN AUTOMATIC
FINISH (DARK GREY COLOR)

USE 2.7X 3MM THK FLAT BAR
PAINTED IN AUTOMATIC
FINISH (DARK GREY COLOR)

USE 2.7X 3MM THK FLAT BAR
PAINTED IN AUTOMATIC
FINISH (DARK GREY COLOR)

USE 2.7X 3MM THK FLAT BAR
PAINTED IN AUTOMATIC
FINISH (DARK GREY COLOR)

USE 2.7X 3MM THK FLAT BAR
PAINTED IN AUTOMATIC
FINISH (DARK GREY COLOR)

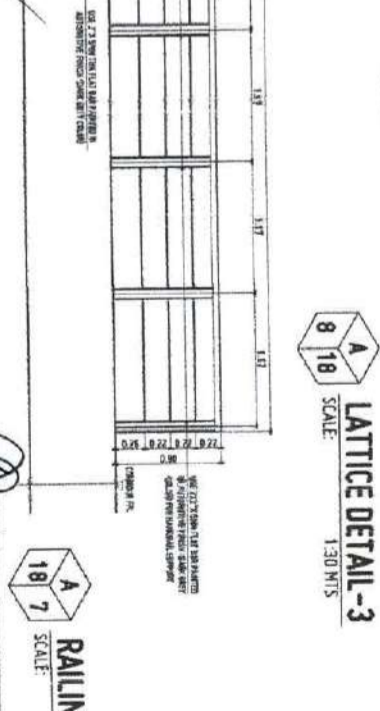
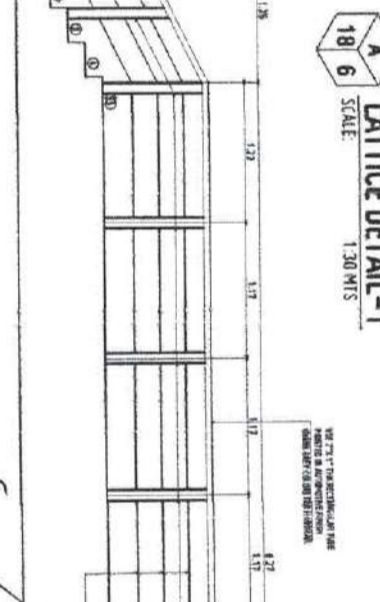
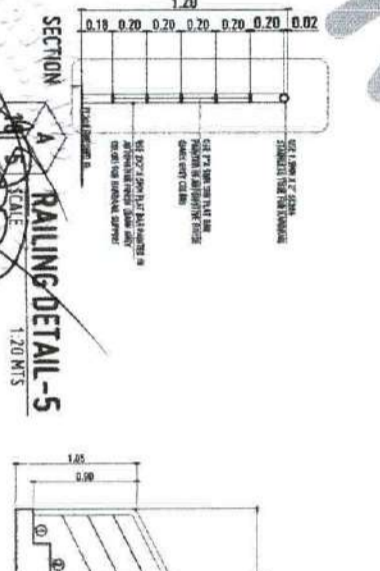
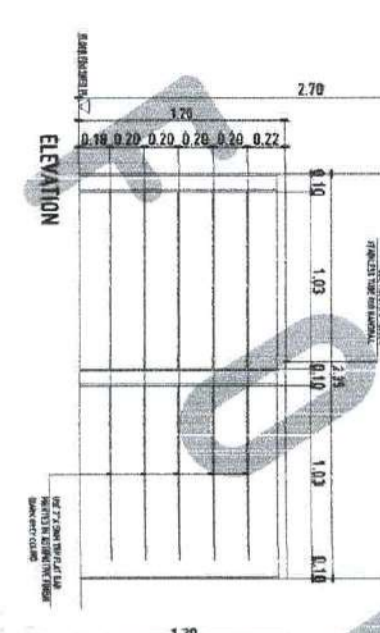
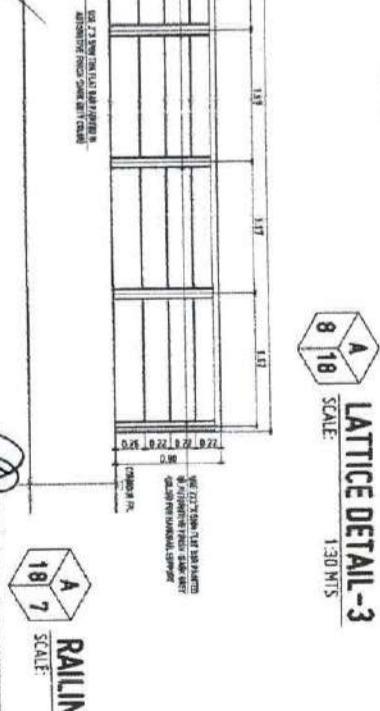
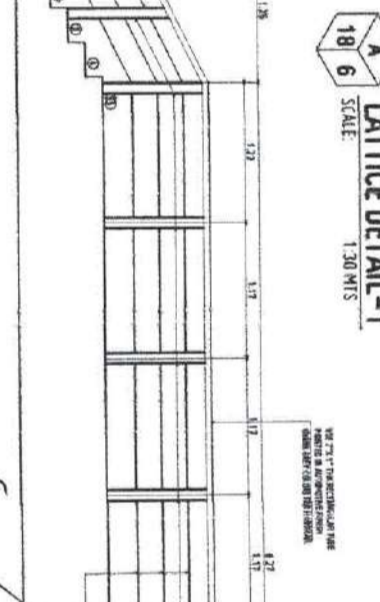
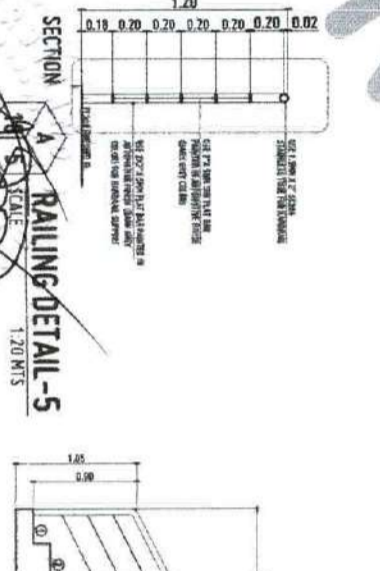
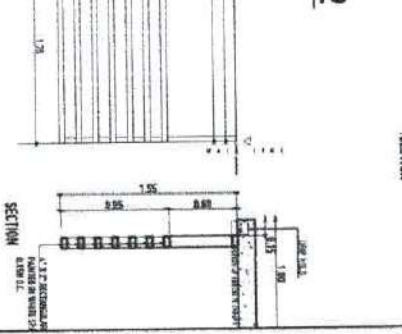
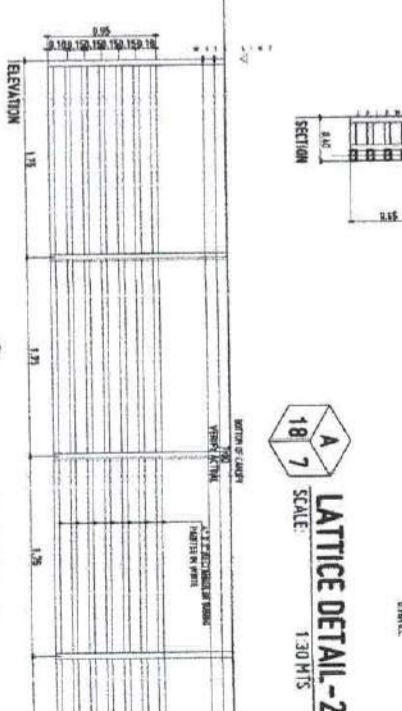
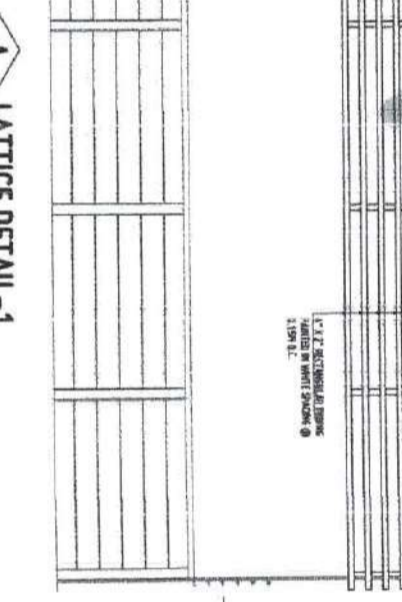
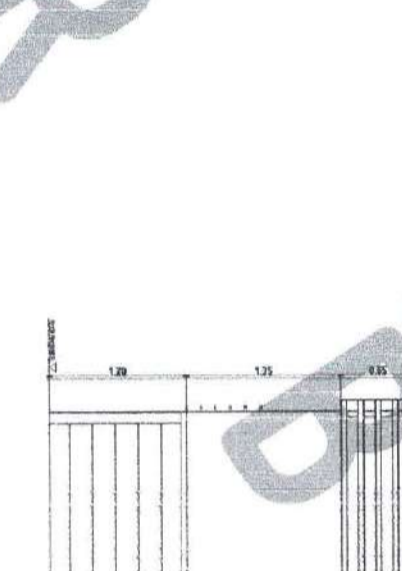
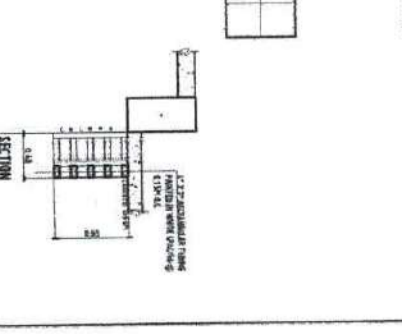
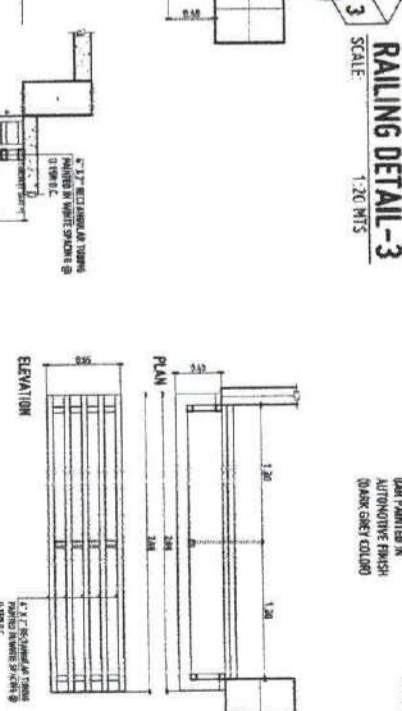
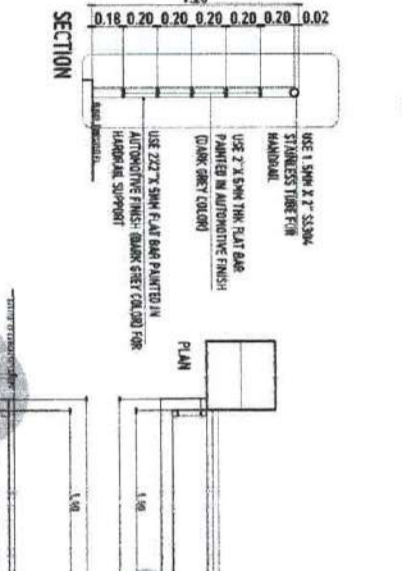
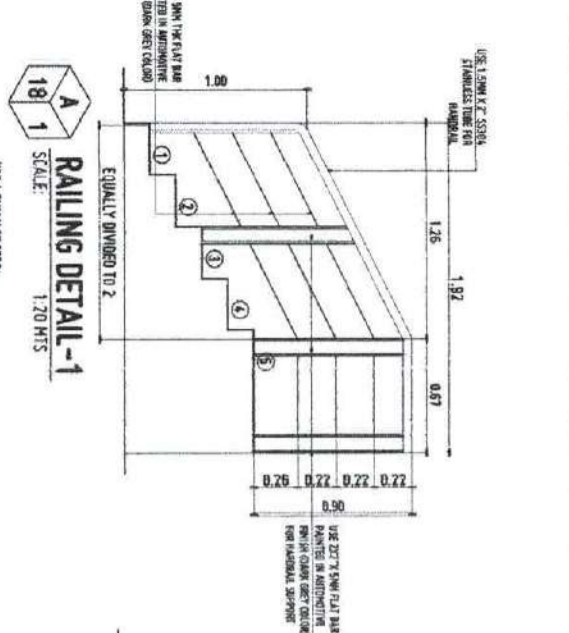
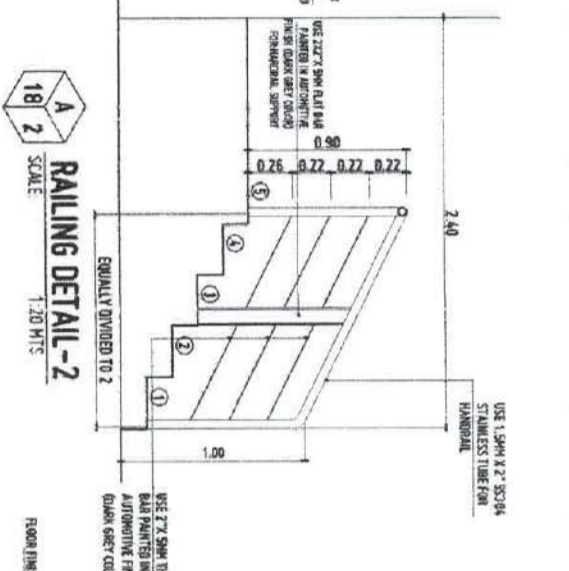
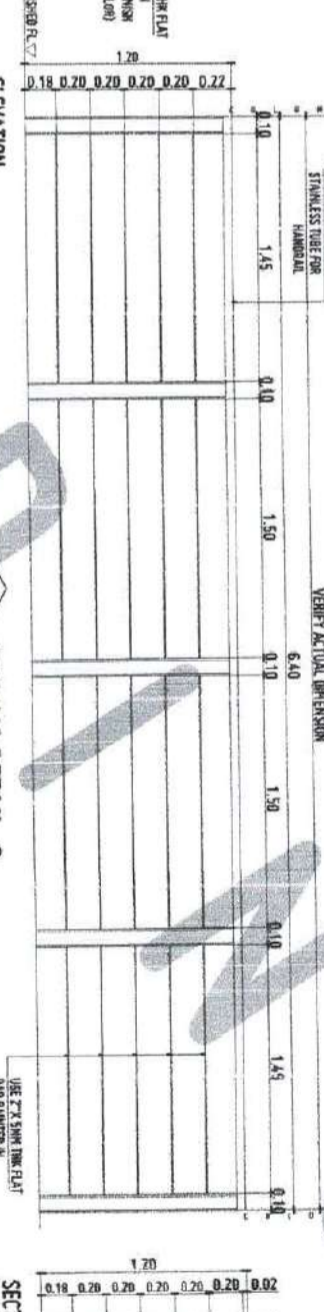
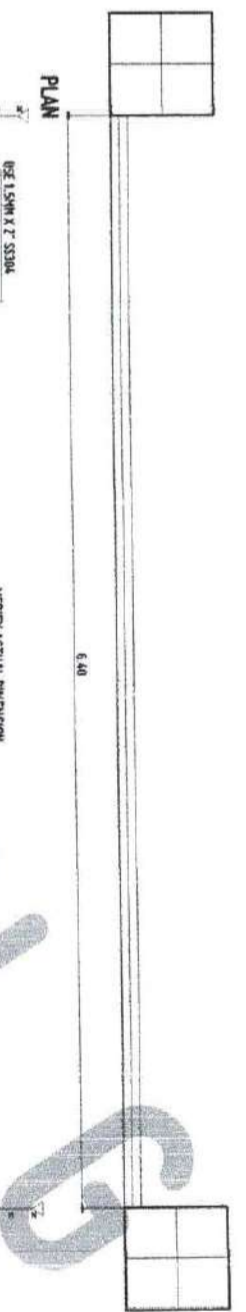

RECOMMENDING ASSOCIATE	RECOMMENDING ASSOCIATE	APPROVED BY:	SHEET COMMENTS:	DATE:
DR. FERMINA B. CORTES	DR. FERMINA B. CORTES	DR. ANTONIO S. CORTES	RAILING AND LATTICE DETAILS	1/10/2024
DR. FERMINA B. CORTES	DR. FERMINA B. CORTES	DR. ANTONIO S. CORTES	RAILING AND LATTICE DETAILS	1/10/2024

UNIVERSITY OF THE PHILIPPINES
OFFICE OF THE BUILDING OFFICIAL
DIVISION OFFICE, MINDANAO REGIONAL

PROPOSED 21ST CENTURY 5 STOREY CLASSROOM BUILDING
UNIVERSITY OF SCIENCE AND TECHNOLOGY OF SOUTHERN PHILIPPINES

UNIVERSITY OF SCIENCE AND TECHNOLOGY OF SOUTHERN PHILIPPINES
INSTITUTE OF ARCHITECTURE AND FACILITY DEVELOPMENT UNIT
CLAY H. BERTOLINO, ARCHITECT, CHAIRMAN OF FACULTY BOARD
TELEPHONE: 8322-71-48-55 / 7399-1141-1141 / 7399-1141-1141 / 7399-1141-1141
WEBSITE: www.ustip.edu.ph

REPUBLIC OF THE PHILIPPINES
OFFICE OF THE BUILDING OFFICIAL
DIVISION OFFICE, MINDANAO REGIONAL

UNIVERSITY OF THE PHILIPPINES
OFFICE OF THE BUILDING OFFICIAL
DIVISION OFFICE, MINDANAO REGIONAL



APPROVED BY:

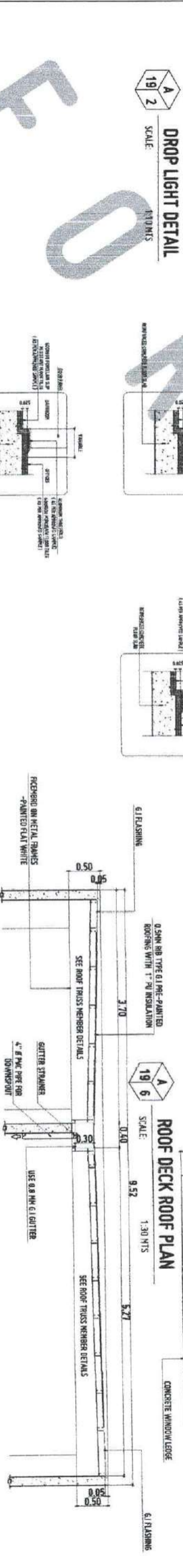
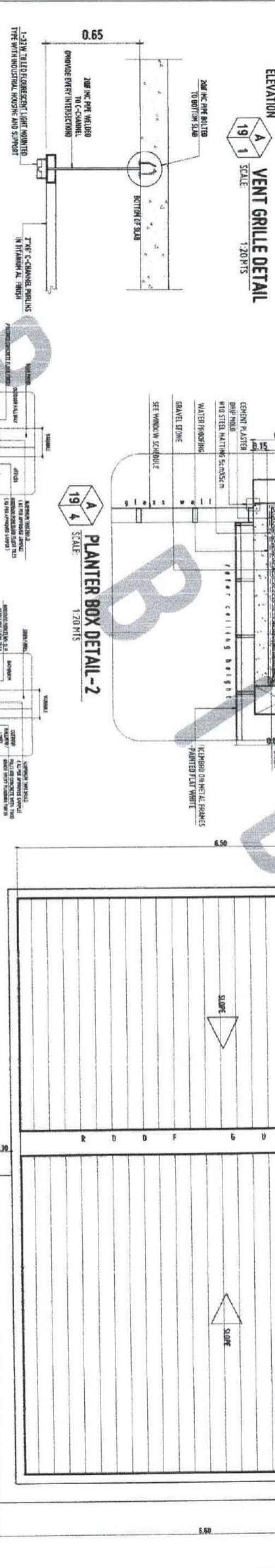
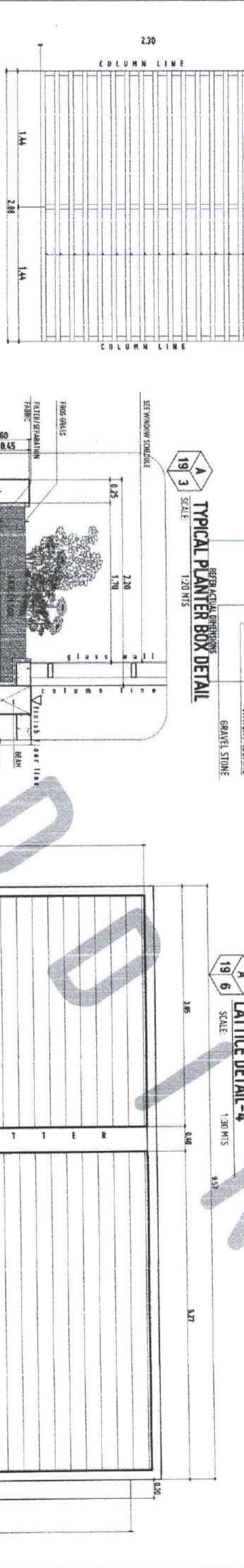
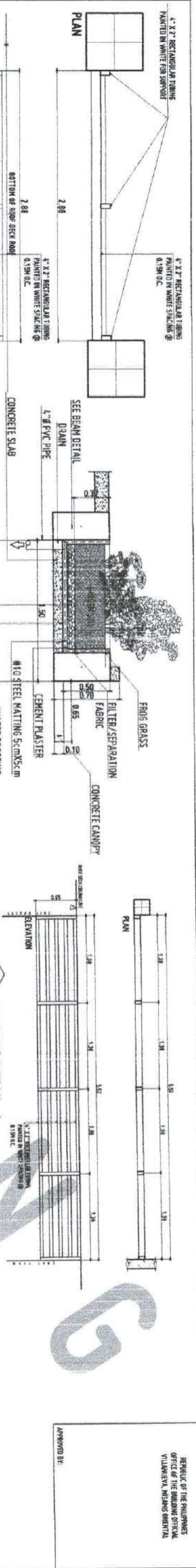

FERMINA L. ALMORA
Architect of Record
1111 N. ASPEN ST., SUITE 110, DENVER, CO 80202
TEL: (303) 733-4977

PROPOSED 21ST CENTURY 5 STOREY CLASSROOM BUILDING

AR. FERMINA L. ALMORA
DIRECTOR, USUP

ATTY. ERNIE A. BUENO
DIRECTOR, USUP

DR. AMBRADOR B. CULIURA II
PRESIDENT, USUP SYSTEM

RECOMMENDING APPROVAL: _____
RECOMMENDING APPROVAL: _____
APPROVED BY: _____
APPROVED BY: _____
APPROVED BY: _____

SHEET CONTENTS:
SHEET NO. 1: 1.1 - 1.2
SHEET NO. 2: 1.3 - 1.4
SHEET NO. 3: 1.5 - 1.6
SHEET NO. 4: 1.7 - 1.8
SHEET NO. 5: 1.9 - 2.0

DATE: _____
DRAWN BY: _____
CHECKED BY: _____
SCALE: 1:30 MTS

A19

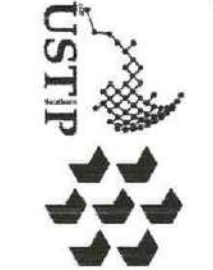

REPUBLIC OF THE PHILIPPINES
UNIVERSITY OF SCIENCE AND TECHNOLOGY OF SOUTHERN PHILIPPINES
DILMANSIA, MARIKINA CITY
INTEGRATING PLANNING AND FACILITY DEVELOPMENT UNIT
CAMPUS PLANNING AND FACILITY DEVELOPMENT UNIT
1111 N. ASPEN ST., SUITE 110, DENVER, CO 80202
TEL: (303) 733-4977