

THIS SITE

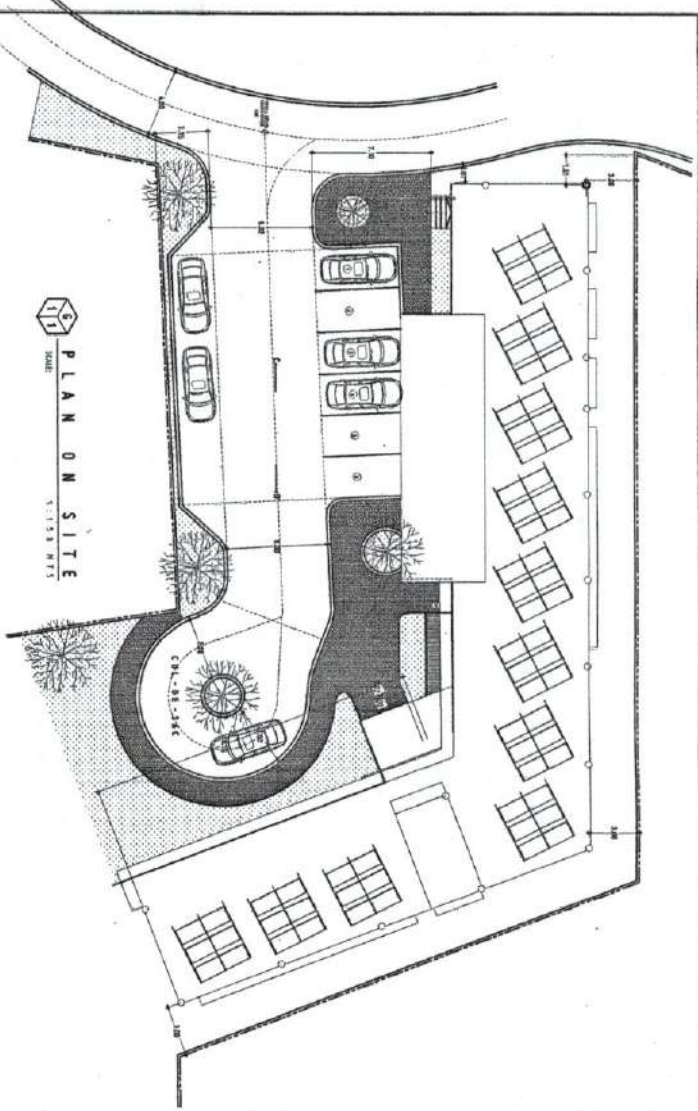

LOT 1		
NO.	TECHNICAL DESCRIPTION	AREA (SQ. M)
1-2	N 55 DEG. 25' W	28.04
2-3	N 65 DEG. 27' W	1.97
3-4	N 19 DEG. 46' E	44.12
4-5	S 67 DEG. 15' E	28.45
5-1	S 16 DEG. 17' W	45.12
LOT 2		
NO.	TECHNICAL DESCRIPTION	AREA (SQ. M)
1-2	S 65 DEG. 46' E	25.77
2-3	S 36 DEG. 21' W	15.94
3-4	S 8 DEG. 38' W	13.58
4-5	N 65 DEG. 55' E	44.4
5-6	N 4 DEG. 55' E	28.28
6-1	S 65 DEG. 25' E	28.04
LOT 3		
NO.	TECHNICAL DESCRIPTION	AREA (SQ. M)
1-2	S 82 DEG. 54' W	7.22
2-3	S 49 DEG. 38' W	88.12
3-4	N 47 DEG. 24' W	51.88
4-5	N 46 DEG. 45' E	40.58
5-6	N 8 DEG. 36' E	13.88
6-7	N 38 DEG. 27' E	24.57
7-8	N 16 DEG. 54' E	12.49
8-9	N 25 DEG. 27' E	21.69
9-1	S 28 DEG. 30' E	88.94

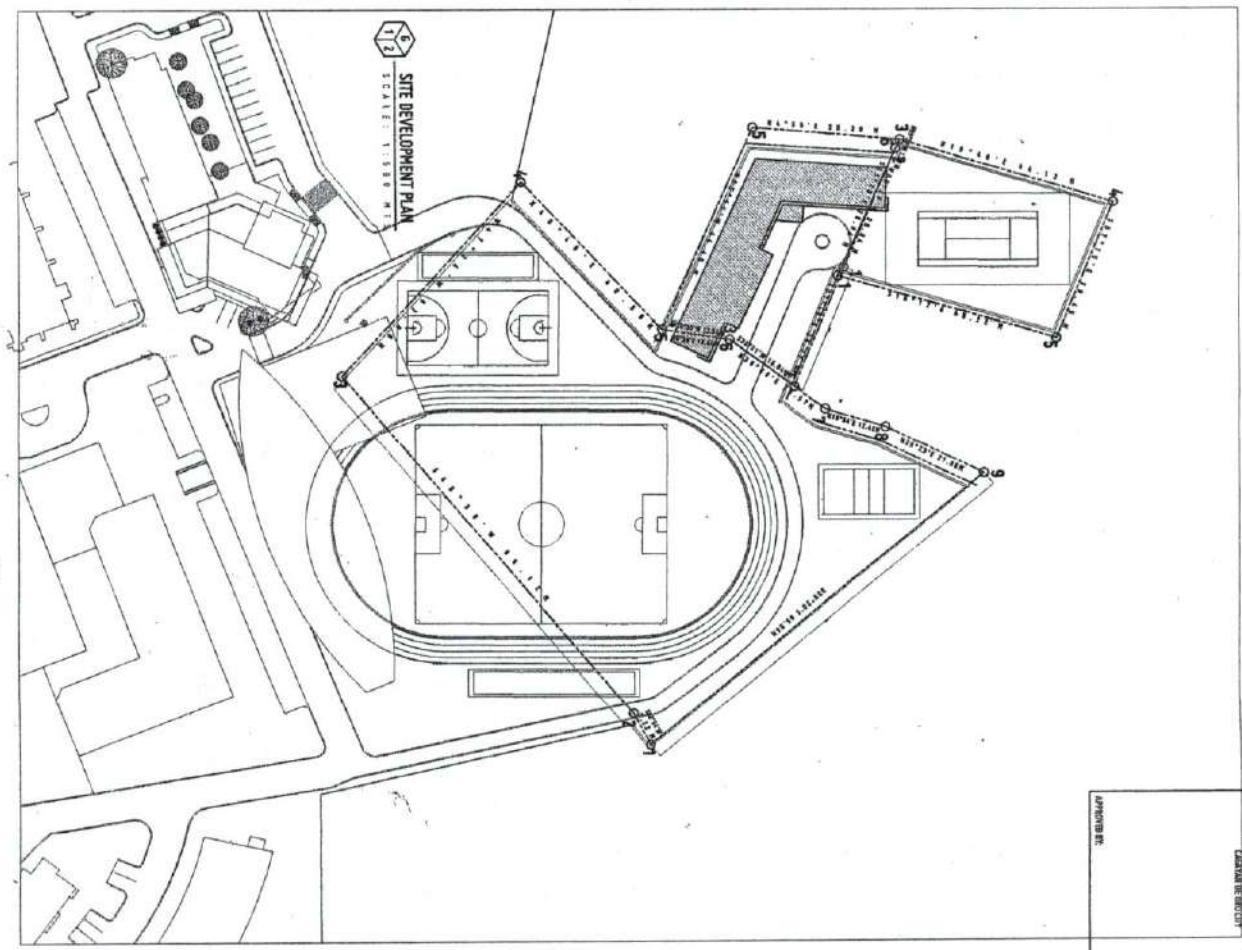

APPROVED BY: _____

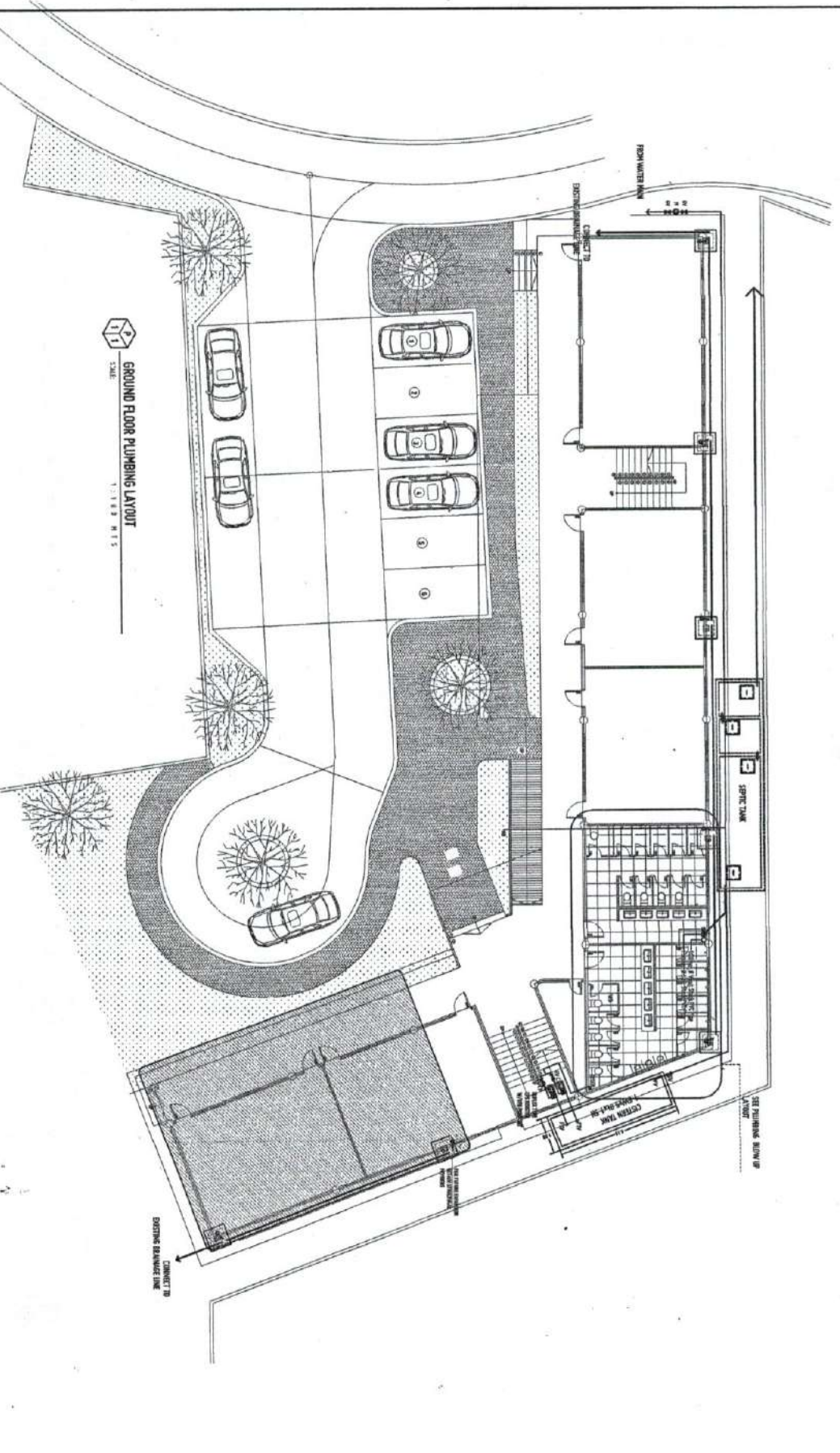

GROUND FLOOR PLUMBING LAYOUT
SCALE: 1:1000 M.P.S.

- SPECIAL NOTES**
1. THE SYSTEM SHALL BE SUBJECT TO THE LOCAL HEALTH DEPARTMENT/INSPECTOR.
 2. ALL MATERIALS AND WORKMANSHIP SHALL BE APPROVED BY THE LOCAL HEALTH DEPARTMENT/INSPECTOR.
 3. ALL MATERIALS AND WORKMANSHIP SHALL BE APPROVED BY THE LOCAL HEALTH DEPARTMENT/INSPECTOR.
 4. THE SYSTEM SHALL BE SUBJECT TO THE LOCAL HEALTH DEPARTMENT/INSPECTOR.
 5. THE SYSTEM SHALL BE SUBJECT TO THE LOCAL HEALTH DEPARTMENT/INSPECTOR.
 6. THE SYSTEM SHALL BE SUBJECT TO THE LOCAL HEALTH DEPARTMENT/INSPECTOR.
 7. THE SYSTEM SHALL BE SUBJECT TO THE LOCAL HEALTH DEPARTMENT/INSPECTOR.
 8. THE SYSTEM SHALL BE SUBJECT TO THE LOCAL HEALTH DEPARTMENT/INSPECTOR.
 9. THE SYSTEM SHALL BE SUBJECT TO THE LOCAL HEALTH DEPARTMENT/INSPECTOR.
 10. THE SYSTEM SHALL BE SUBJECT TO THE LOCAL HEALTH DEPARTMENT/INSPECTOR.

PLUMBING

LEGEND:	
LAV	LAVATORY
UR	URINAL
W/C	WATER CLOSET
R	RISER
KS	KITCHEN SINK
SOV	SHUT-OFF VALVE
CV	CHECK VALVE
CBV	CHECK BALL VALVE
HB	HOSE BIB
PWL	POTABLE WATER LINE
SS	SEWER SINK



OFFICE OF THE BUILDING OFFICIAL
UNIVERSITY OF SOUTHERN PHILIPPINES
INTEGRATED PLANNING AND FACILITY DEVELOPMENT UNIT
CLARENCE A. RIVERA, ARCHITECT, LICENSED ARCHITECT NO. 12345
TEL: 0917-123-4567 / FAX: 0917-123-4567 / EMAIL: info@ustip.edu.ph

PROJECT INFORMATION	
PROJECT NAME	UNIVERSITY OF SOUTHERN PHILIPPINES
PROJECT LOCATION	UNIVERSITY OF SOUTHERN PHILIPPINES
PROJECT OWNER	UNIVERSITY OF SOUTHERN PHILIPPINES

COMPLETION OF SPORTS COMPLEX AND RESIDENCES PHASE 1-3
CLARENCE A. RIVERA, ARCHITECT, LICENSED ARCHITECT NO. 12345
UNIVERSITY OF SOUTHERN PHILIPPINES

RECOMMENDING APPROVAL
AR. FERDINAND S. SORIANO
REGISTERED ARCHITECT

ECONOMIC APPROVAL
ATTY. ERWIN A. BARRERA
REGISTERED ARCHITECT

APPROVED BY:
DR. AMERSON B. CULTURA II
REGISTERED ARCHITECT

SHEET CONTAINS:	
DATE	NOV 2023
NO.	1

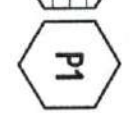

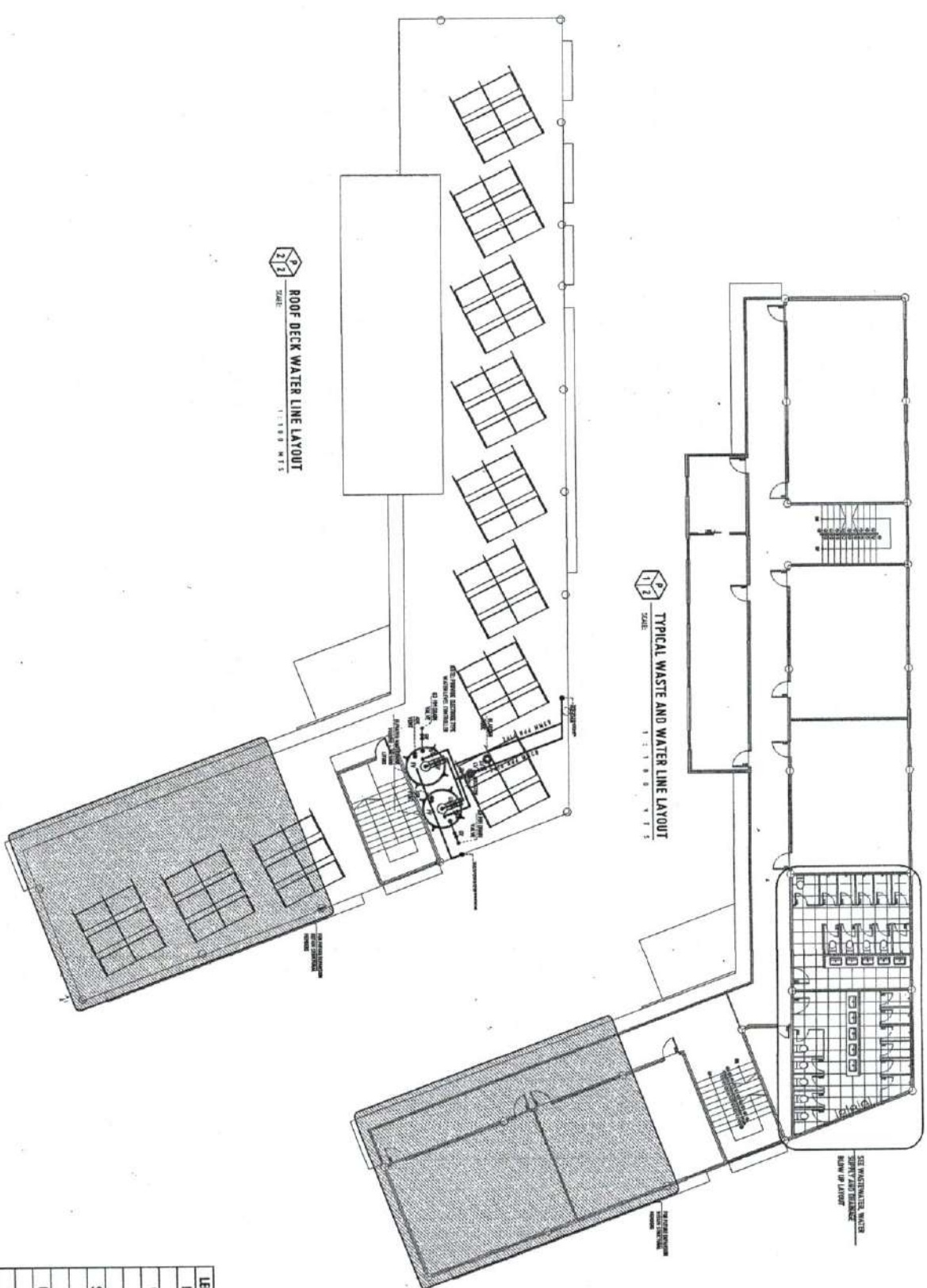

PLUMBING

LEGEND:	
LAV	LAVATORY
UR	URINAL
WC	WATER CLOSET
R	ROSER
KS	KITCHEN SINK
SNV	SHUT-OFF VALVE
CV	CHECK VALVE
GV	GLOBE VALVE
CBV	CHECK BALL VALVE
HB	HOSE BIB
PWL	POTABLE WATER LINE
SS	SLOP SINK

- GENERAL NOTES:**
1. SEE "TYPICAL WASTE AND WATER LINE LAYOUT" FOR GENERAL INFORMATION.
 2. ALL WASTE PIPING SHALL BE INSTALLED IN ACCORDANCE WITH THE LATEST EDITIONS OF THE NATIONAL PLUMBING CODE AND THE NATIONAL ELECTRICAL CODE.
 3. ALL WASTE PIPING SHALL BE INSTALLED IN ACCORDANCE WITH THE LATEST EDITIONS OF THE NATIONAL PLUMBING CODE AND THE NATIONAL ELECTRICAL CODE.
 4. ALL WASTE PIPING SHALL BE INSTALLED IN ACCORDANCE WITH THE LATEST EDITIONS OF THE NATIONAL PLUMBING CODE AND THE NATIONAL ELECTRICAL CODE.
 5. ALL WASTE PIPING SHALL BE INSTALLED IN ACCORDANCE WITH THE LATEST EDITIONS OF THE NATIONAL PLUMBING CODE AND THE NATIONAL ELECTRICAL CODE.
 6. ALL WASTE PIPING SHALL BE INSTALLED IN ACCORDANCE WITH THE LATEST EDITIONS OF THE NATIONAL PLUMBING CODE AND THE NATIONAL ELECTRICAL CODE.
 7. WASTE PIPING SHALL BE INSTALLED IN ACCORDANCE WITH THE LATEST EDITIONS OF THE NATIONAL PLUMBING CODE AND THE NATIONAL ELECTRICAL CODE.
 8. ALL WASTE PIPING SHALL BE INSTALLED IN ACCORDANCE WITH THE LATEST EDITIONS OF THE NATIONAL PLUMBING CODE AND THE NATIONAL ELECTRICAL CODE.
 9. ALL WASTE PIPING SHALL BE INSTALLED IN ACCORDANCE WITH THE LATEST EDITIONS OF THE NATIONAL PLUMBING CODE AND THE NATIONAL ELECTRICAL CODE.
 10. ALL WASTE PIPING SHALL BE INSTALLED IN ACCORDANCE WITH THE LATEST EDITIONS OF THE NATIONAL PLUMBING CODE AND THE NATIONAL ELECTRICAL CODE.

UNIVERSITY OF THE PHILIPPINES
 OFFICE OF THE REGISTERED ARCHITECT

SYMBOL	DESCRIPTION
W	WATER
WC	WATER CLOSET
B	BATH
SH	SHOWER
CV	COIN VENDING
SI	SINK
UB	URINAL
FM	FRESH WATER LINE
SS	SEWER

PLUMBING

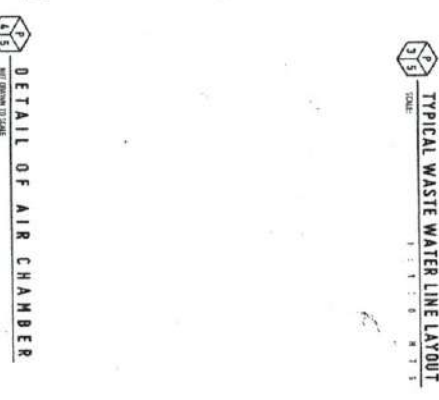
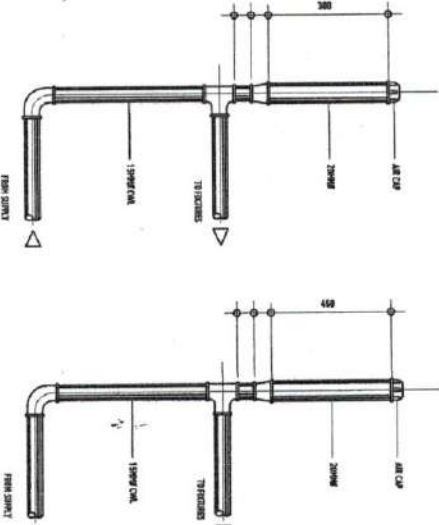
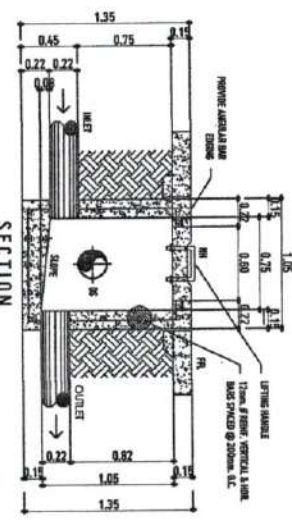
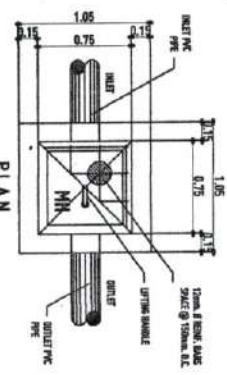
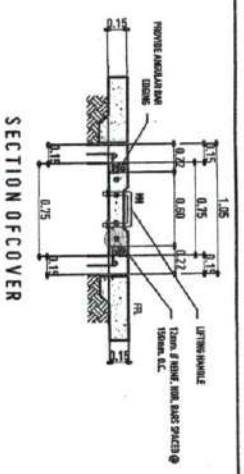
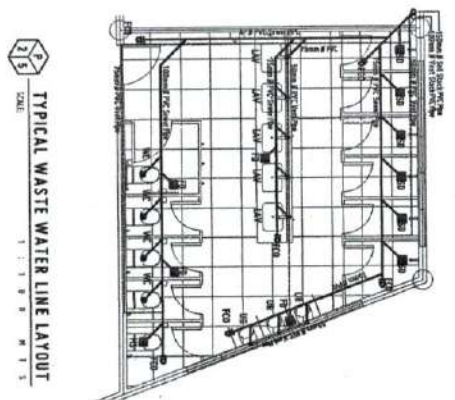
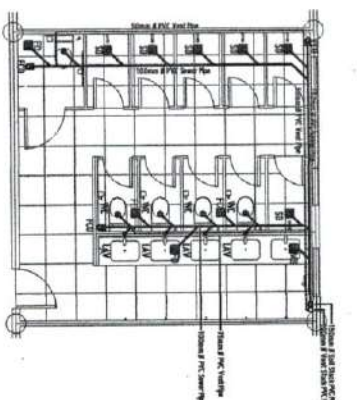
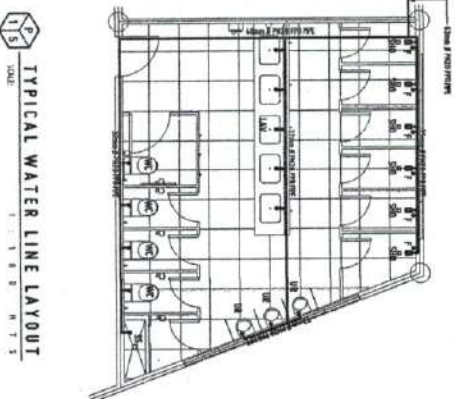
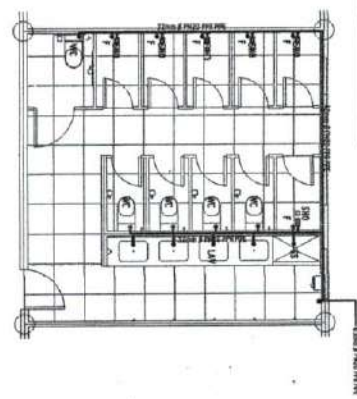

- GENERAL NOTES:**
1. ALL DIMENSIONS SHALL BE IN METERS UNLESS OTHERWISE SPECIFIED.
 2. ALL MATERIALS SHALL BE OF THE BEST QUALITY AVAILABLE.
 3. ALL WORK SHALL BE DONE IN ACCORDANCE WITH THE NATIONAL STANDARD SPECIFICATIONS FOR PLUMBING.
 4. ALL WORK SHALL BE DONE IN ACCORDANCE WITH THE NATIONAL STANDARD SPECIFICATIONS FOR PLUMBING.
 5. ALL WORK SHALL BE DONE IN ACCORDANCE WITH THE NATIONAL STANDARD SPECIFICATIONS FOR PLUMBING.
 6. ALL WORK SHALL BE DONE IN ACCORDANCE WITH THE NATIONAL STANDARD SPECIFICATIONS FOR PLUMBING.
 7. ALL WORK SHALL BE DONE IN ACCORDANCE WITH THE NATIONAL STANDARD SPECIFICATIONS FOR PLUMBING.
 8. ALL WORK SHALL BE DONE IN ACCORDANCE WITH THE NATIONAL STANDARD SPECIFICATIONS FOR PLUMBING.
 9. ALL WORK SHALL BE DONE IN ACCORDANCE WITH THE NATIONAL STANDARD SPECIFICATIONS FOR PLUMBING.
 10. ALL WORK SHALL BE DONE IN ACCORDANCE WITH THE NATIONAL STANDARD SPECIFICATIONS FOR PLUMBING.

OFFICE OF THE NATIONAL ENGINEERING EXAMINERS



UNIVERSITY OF SCIENCE AND TECHNOLOGY OF THE PHILIPPINES
ARCHITECTURE PLANNING AND FACILITY DEVELOPMENT UNIT
CLARKE HALL, SCIENCE CENTER, LOS BAÑOS, CAVITE
TEL: (02) 809-1111 / (02) 809-1112 / (02) 809-1113 / (02) 809-1114

PROJECT	LOCATION
COMPLETION OF SPORTS COMPLEX AND RESIDENCES PHASE 1-3	CLARKE HALL, SCIENCE CENTER, LOS BAÑOS, CAVITE

RECOMMENDING APPROVAL:
MR. FERDINAND S. TORRES
REGISTERED ARCHITECT

DESIGNING APPROVAL:
DR. ANTONIO B. CUI TUBA II
REGISTERED ARCHITECT

SHEET CONTENTS

DATE DRAWN

P3

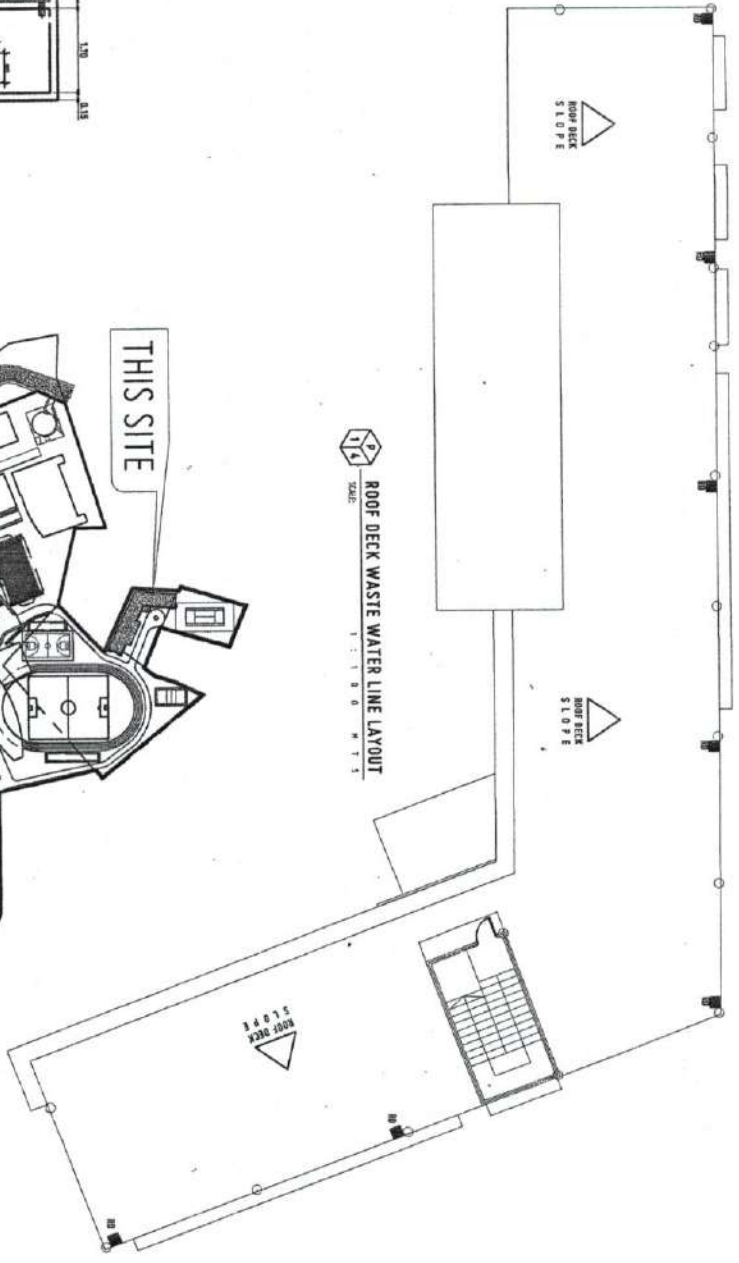

ROOF DECK WASTE WATER LINE LAYOUT
SCALE: 1 : 1 0 0 0

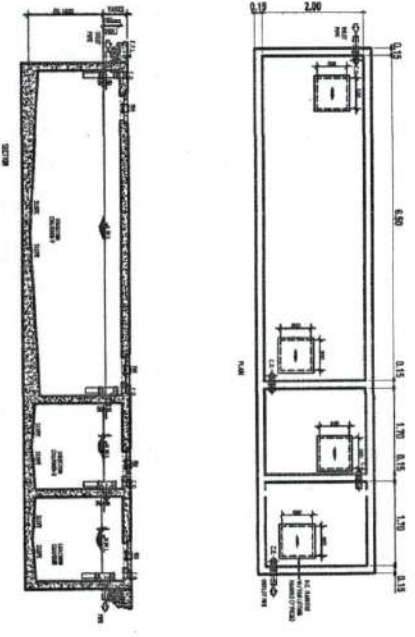

SEPTIC VAULT DETAIL
SCALE: 1 : 5 0

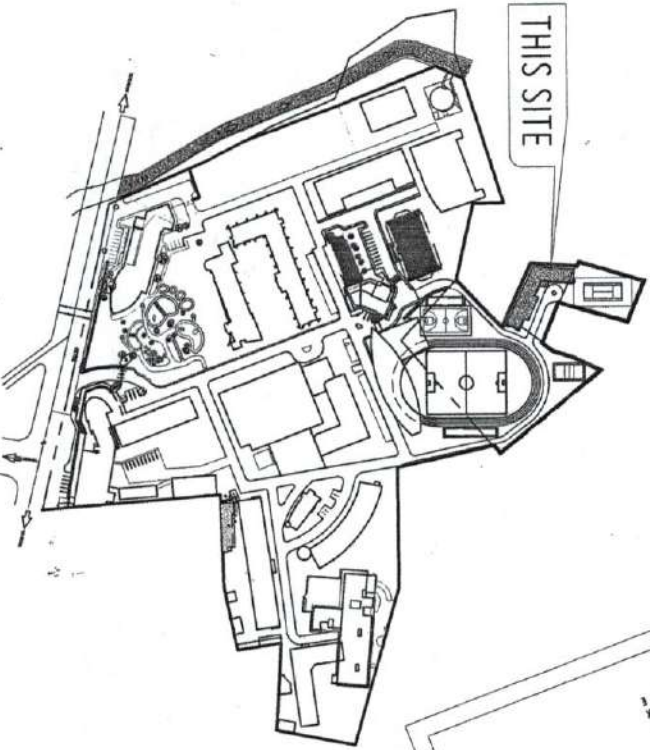

LOCATION PLAN
SCALE: AS SHOWN TO SCALE

PLUMBING

LEGEND:	
LAV	LAVATORY
UR	URINAL
WC	WATER CLOSET
R	RISER
KS	KITCHEN SINK
SDV	SHUT-OFF VALVE
CV	CHECK VALVE
BV	GLIDE VALVE
CBV	CHECK BALL VALVE
HB	HOSE BIB
PWL	POTABLE WATER LINE
SS	SLOP SINK



REPUBLIC OF THE PHILIPPINES
COMMISSION OF SCIENCE AND TECHNOLOGY - SOUTHERN PHILIPPINES
UNIVERSITY OF SCIENCE AND TECHNOLOGY
CLAREN M. BERTS LABOR, LIPATAN, CALAPAN CITY, SARANGANI
UNIVERSITY OF SCIENCE AND TECHNOLOGY - SOUTHERN PHILIPPINES
ADDRESS: Zamboanga

PROJECT: FACILITY RENOVATION
CLIENT: USTIP
OWNER: USTIP

COMMISSION OF SCIENCE AND TECHNOLOGY (PHASE 10)
CLAREN M. BERTS LABOR, LIPATAN, CALAPAN CITY, SARANGANI
UNIVERSITY OF SCIENCE AND TECHNOLOGY - SOUTHERN PHILIPPINES

RECOMMENDING APPROVAL:
MR. FERDINAND TORRES
DIRECTOR (PHILIPPINE)

RECOMMENDING APPROVAL:
ATTY. ERVING BOGOS
DIRECTOR (CULTURAL AFFAIRS)

APPROVED BY:
DR. AMBROSIO S. CULTIBRA II
DIRECTOR (LITIGATION)

SHEET CONTAINS:
DATE CHECKED:
BY: