

P E R S P E C T I V E S

	REPUBLIC OF THE PHILIPPINES UNIVERSITY OF SOUTHERN PHILIPPINES CAGAYAN DE ORO CITY 8000 5th Floor, University Center 2nd Floor, Student Center 3rd Floor, Faculty Center 4th Floor, Administration Center	PREPARED BY ENRICA ANTONIO C. HERNANDEZ PRG NO. _____ TRN NO. _____ DATE ISSUED _____	PROJECT PROPOSED CONSTRUCTION OF ROAD RIGHT OF WAY AND GROUND PREPARATION FOR LANDSCAPE AREAS FOR COT BUILDING LOCATION: C.M. RECTO AVENUE, LAFAMAN, CAGAYAN DE ORO CITY OWNER: UNIVERSITY OF SOUTHERN PHILIPPINES	RECOMMENDING APPROVAL  ENGR. ALLAN M. LINARES REGISTERED PROFESSIONAL ENGINEER	APPROVED BY  ATTY. NORELLE M. LOPEZ REGISTERED PROFESSIONAL ATTORNEY	SHEET CONTENTS PERSPECTIVES	DRAWN BY: ANGE DATE: 08/20/2021 CAD BY: ANTONIO C. HERNANDEZ FILE NO. 19/2021 SHEET NO. 07 SCALE: 1:10000
---	---	---	---	--	--	--------------------------------	--

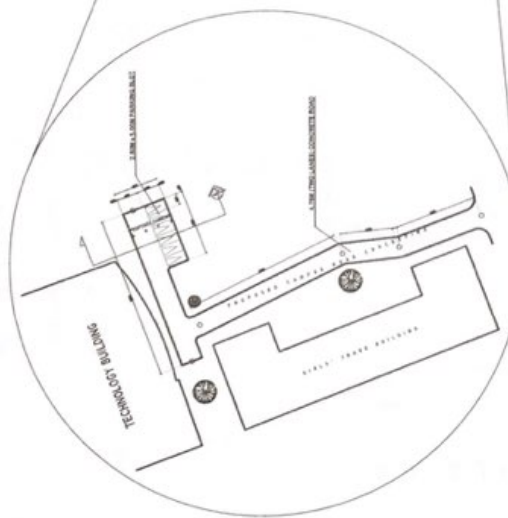

1 CAMPUS ROAD CONCRETING BLOW-UP PLAN  
SCALE: 1:2000

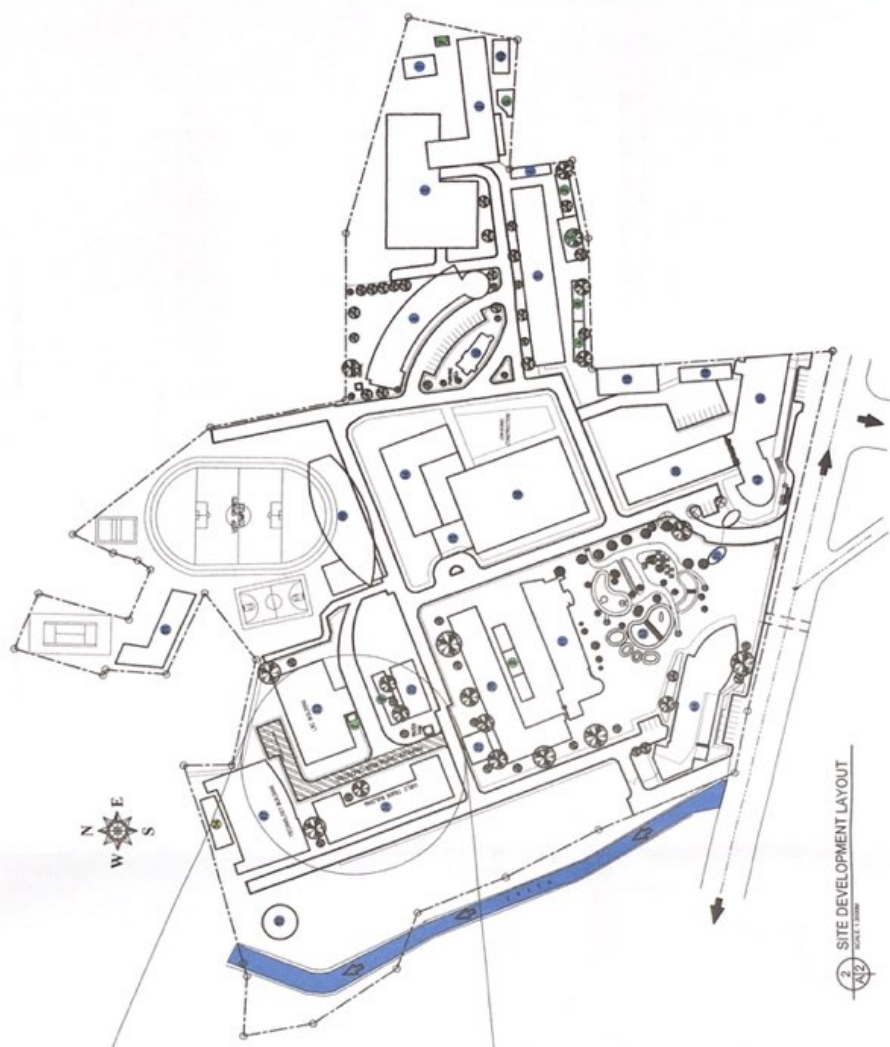
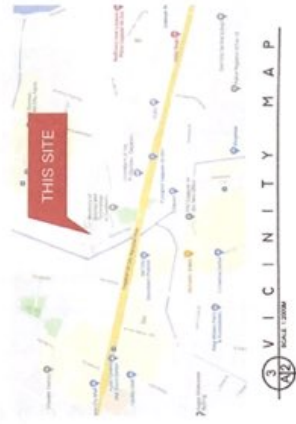

3 VICINITY MAP  
SCALE: 1:2000

2 SITE DEVELOPMENT LAYOUT  
SCALE: 1:2000

<p>REPUBLIC OF THE PHILIPPINES UNIVERSITY OF SCIENCE &amp; TECHNOLOGY OF SOUTHERN PHILIPPINES CAMPUS OF COT ABATIAN</p> <p>C.E. - 1000 1000 1000 1000</p>	<p>PREPARED BY: ENGR. ANGEL S. NERE, JR. PROJECT NO. 1000 DATE ISSUED: 10/10/2023</p>	<p>PROPOSED CONSTRUCTION OF ROAD RIGHT OF WAY AND GROUND PREPARATION FOR LANDSCAPE AREAS FOR COT BUILDING LOCATION: C.M. SECTO AVENUE, LUPATAN, CANTAWAN, ORIENTAL CEBU OWNER: UNIVERSITY OF SCIENCE &amp; TECHNOLOGY OF SOUTHERN PHILIPPINES</p>	<p>RECOMMENDING APPROVAL: [Signature] ATTY. JOSE P. CALINA 1000</p>	<p>APPROVED BY: [Signature] ATTY. JOSE P. CALINA 1000</p>	<p>SHEET CONTENTS: - SITE DEVELOPMENT LAYOUT - CONCRETING PLAN - LANDSCAPE PLAN</p>	<p>DATE: 10/10/2023 DRAWN BY: OME DATE: 10/10/2023 CHECKED BY: [Signature] DATE: 10/10/2023 SCALE: 1:2000</p>	<p>SHEET NO. A2 07</p>
	<p>USTP</p>	<p>DATE: 10/10/2023</p>	<p>SCALE: 1:2000</p>	<p>SCALE: 1:2000</p>	<p>SCALE: 1:2000</p>	<p>SCALE: 1:2000</p>	<p>SCALE: 1:2000</p>

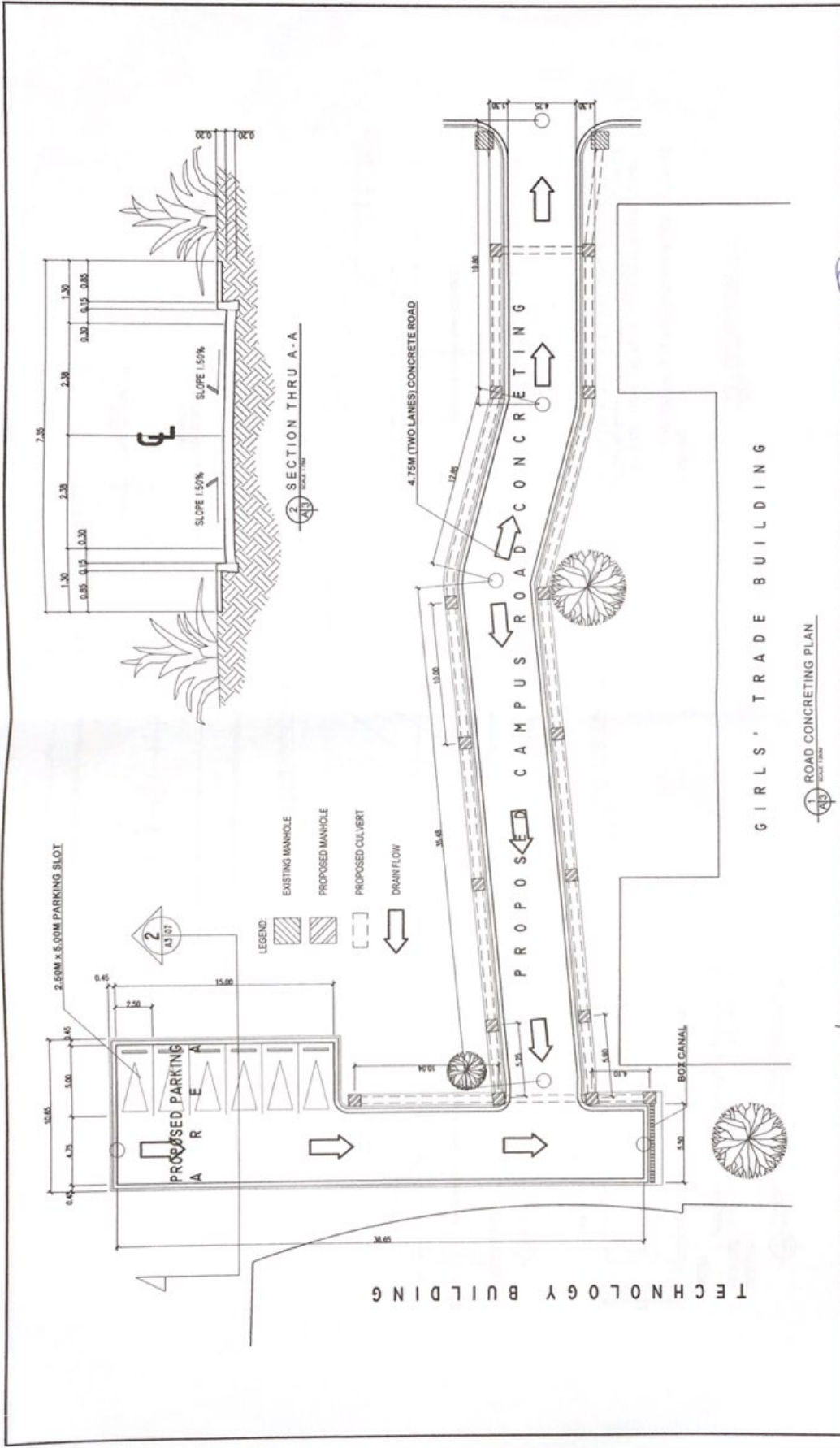

 <b>USTP</b> UNIVERSITY OF SCIENCE & TECHNOLOGY OF SOUTHERN PHILIPPINES	PREPARED BY: <b>ENR. ANJELIC C. MENDOZA</b> TR. NO. _____	PROJECT: <b>PROPOSED CONSTRUCTION OF ROAD RIGHT OF WAY AND GROUND PREPARATION FOR LANDSCAPE AREAS FOR COT BUILDING</b> LOCATION: <b>C.M. REYES AVENUE, LAPANAL, CAGAYAN DE ORO CITY</b>	RECOMMENDING APPROVAL: <i>[Signature]</i> DATE: _____	APPROVED BY: <i>[Signature]</i> DATE: _____	SHEET CONTENTS: <ul style="list-style-type: none"> <li>ROAD CONCRETING PLAN</li> <li>SECTION THRU A-A</li> </ul>	DRAWN BY: <b>DOBE</b> DATE: _____	SHEET NO: <b>A3</b> OF: <b>07</b>
	CHECKED BY: _____	CHECKED DATE: _____	CHECKED BY: _____	CHECKED DATE: _____	CHECKED BY: _____	CHECKED DATE: _____	SCALE: 1:1000

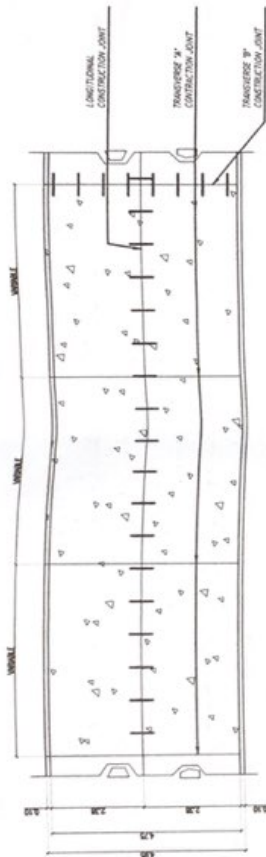

ROAD CONCRETING BLOW-UP PLAN

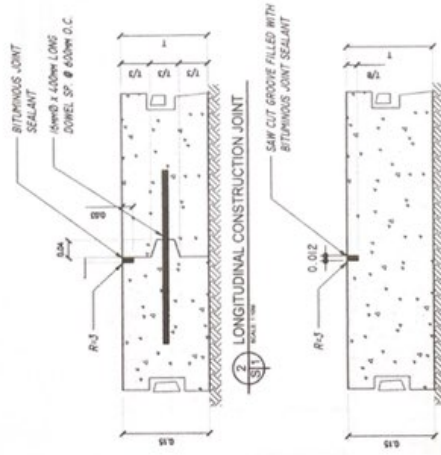

NOTE:  
1. TRANSVERSE CONTRACTION JOINTS SHALL BE PROVIDED AT EVERY 3.50 METERS MAXIMUM INTERVALS

TRANSVERSE CONTRACTION JOINT

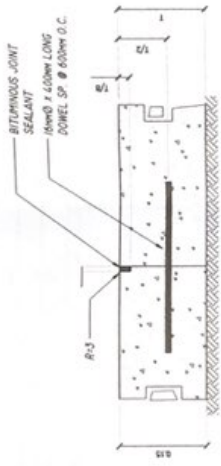

NOTE:  
1. TRANSVERSE CONSTRUCTION JOINT SHALL BE PROVIDED AT EVERY PLANNED LIMIT OF POURING

TRANSVERSE CONSTRUCTION JOINT

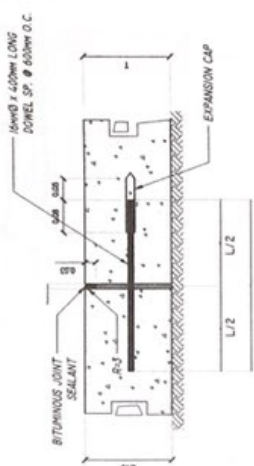

NOTES:  
1. PREFORMED EXPANSION JOINT FILLER WITH JOINT SEALANT ARE REQUIRED WHERE EXISTING & NEW CONCRETE PAVEMENT MEET AND WHERE NEW CONCRETE PAVEMENT ABUTS A RIGID STRUCTURE AND AT UNSYMMETRICAL INTERSECTIONS.  
2. EXPANSION JOINTS ARE REQUIRED @ EVERY 30.00M OF PAVEMENT

EXPANSION JOINT



REPUBLIC OF THE PHILIPPINES  
UNIVERSITY OF SCIENCE & TECHNOLOGY OF SOUTHERN PHILIPPINES  
CAGAYAN DE ORO CITY 8000  
C.P. - North Avenue, Linaoan - 8000 Cagayan de Oro City  
Tel. No. (8082) 70-6487 / (808) 84-1731 / 84-1775  
Fax No. (808) 847-2674

PROPOSED BY: ENGR. ANGELO M. DELA CRUZ  
DATE: 08/20/2018

PROPOSED CONSTRUCTION OF ROAD RIGHT OF WAY AND LAND PREPARATION FOR LANDSCAPE AREAS FOR COT BUILDING  
LOCATION: C.M. NESTO AVENUE, LAPANAN, CAGAYAN DE ORO CITY  
OWNER: UNIVERSITY OF SCIENCE & TECHNOLOGY OF SOUTHERN PHILIPPINES

RECOMMENDING APPROVAL: [Signature]

APPROVED: [Signature]

DATE: 08/20/2018  
DATE CHECKED: 08/20/2018  
DATE CHECKED: 08/20/2018  
DATE CHECKED: 08/20/2018  
DATE CHECKED: 08/20/2018  
SCALE: 1" = 30.00M

SHEET NO. S1 07

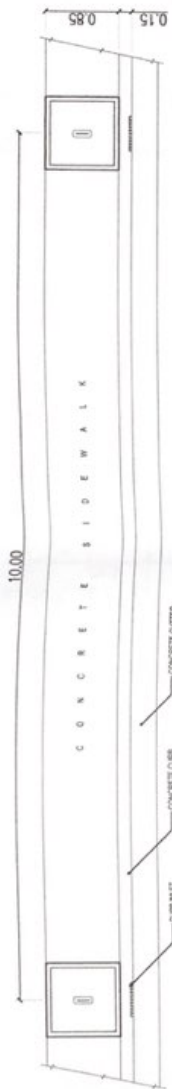

1 TYPICAL LAYOUT OF CONCRETE SIDEWALK AND MANHOLE WITH CONCRETE CURB  
SCALE: 1/8" = 1'-0"

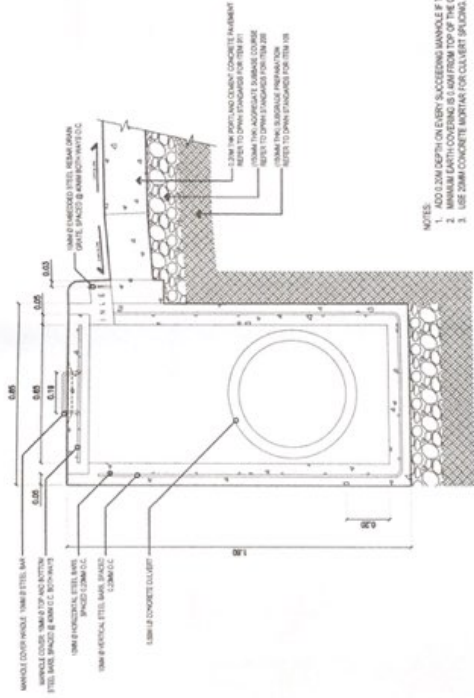

2 MANHOLE LONGITUDINAL SECTION  
SCALE: 1/8" = 1'-0"

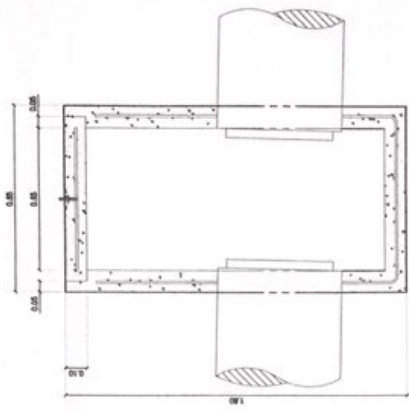

4 MANHOLE CROSS SECTION  
SCALE: 1/8" = 1'-0"

- NOTES:
1. ADD 1.0M DEPTH ON EVERY SUCCEEDING MANHOLE IF TERRAIN IS FLAT
  2. MANHOLE EARTH COVERING IS 0.5M FROM TOP OF THE CURB.
  3. USE 20MM CONCRETE FORTIAN FOR COLLECTOR BRICKS.

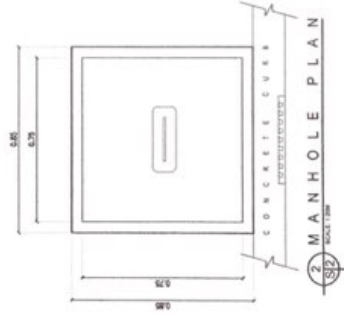

3 MANHOLE PLAN  
SCALE: 1/8" = 1'-0"

PREPARED BY ENGR. ANDRES C. NERA, JR. PROJECT NO. _____ TITLE: _____		PROJECT CONTENTS 1. PRINCIPAL LAYOUT OF CONCRETE SIDEWALK AND CONCRETE CURB 2. MANHOLE LONGITUDINAL SECTION 3. MANHOLE CROSS SECTION		DRAWN BY: GENE DATE: 10/20/2011 CHECKED BY: JACOB DATE: 10/20/2011 PROJECT NO. 10101 SCALE: 1/8" = 1'-0"	
RECOMMENDING APPROVAL (Signature) DATE: _____		RECOMMENDING APPROVAL (Signature) DATE: _____		APPROVED BY (Signature) DATE: _____	
PROJECT PROPOSED CONSTRUCTION OF ROAD RIGHT OF WAY AND GROUND PREPARATION FOR LANDSCAPE AREAS FOR COTI BUILDING		LOCATION CUBA STREET, PALMERA, LAGUNA, CAGAYAN DE ORO CITY		SHEET NO. <b>S2</b>	
OWNER UNIVERSITY OF SCIENCES & TECHNOLOGY OF SOULPHILIPPINES		DRAWN BY GENE		SHEET NO. <b>07</b>	



REPUBLIC OF THE PHILIPPINES  
 UNIVERSITY OF SCIENCES & TECHNOLOGY OF SOULPHILIPPINES  
 CAGAYAN DE ORO CITY 6000  
 TEL. NO. (0882) 76-6487 / 766-128-1211 / 766-6739  
 FAX NO. (088) 666-6666  
 WWW.USTIP.EDU.PH

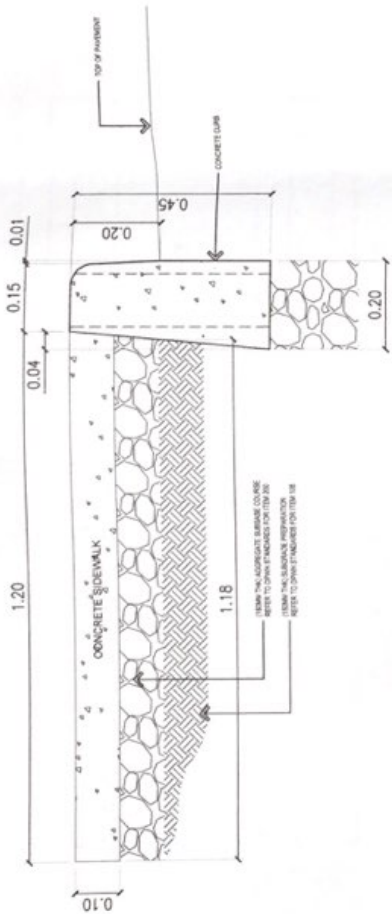

1 CONCRETE SIDEWALK WITH CURB DETAIL  
SCALE 1:100

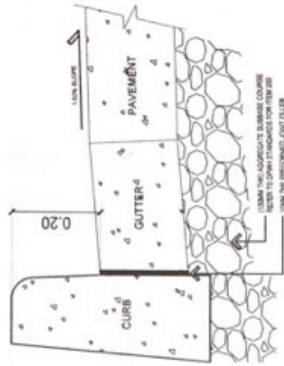

2 SECTION ADJOINING CURB AND CONCRETE PAVEMENT  
SCALE 1:100

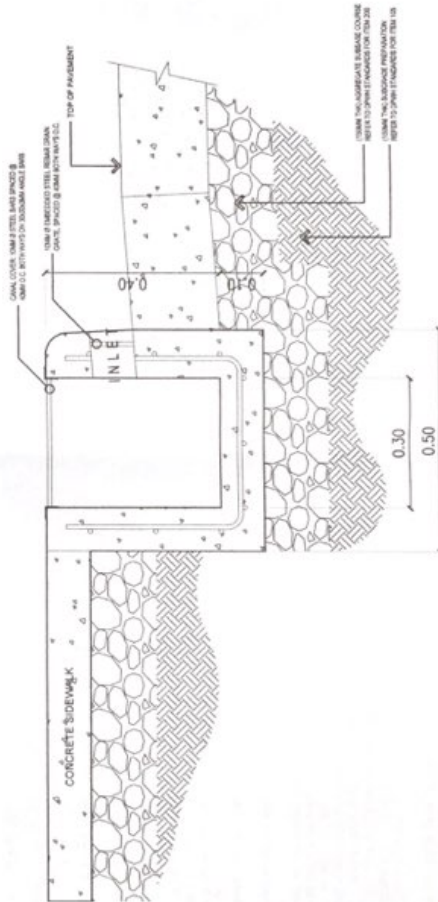

3 CONCRETE SIDEWALK WITH BOX CANAL DETAIL  
SCALE 1:100

	REPUBLIC OF THE PHILIPPINES UNIVERSITY OF SCIENCE & TECHNOLOGY OF SOUTHERN PHILIPPINES CAGAYAN DE ORO CITY 8000 P.O. BOX 10822 / TEL: (088) 858-1751 / FAX: (088) 858-1752 8000 CDO, 8000 CDO	PREPARED BY: ENGR. ANSELMO M. NERA, JR. PROJECT NO.: DRAWING NO.:	PROJECT: PROPOSED CONSTRUCTION OF ROAD RIGHT OF WAY AND GROUND PREPARATION FOR LANDSCAPE AREAS FOR COT BUILDING LOCATION: C.M. RECTO AVENUE, LAFAYETTE, CAGAYAN DE ORO CITY OWNER: UNIVERSITY OF SCIENCE & TECHNOLOGY OF SOUTHERN PHILIPPINES	RECOMMENDING APPROVAL: 	RECOMMENDING APPROVAL: 	SHEET CONTENTS: 1. CONCRETE SIDEWALK WITH CURB AND CONCRETE PAVEMENT 2. SECTION ADJOINING CURB AND CONCRETE PAVEMENT 3. CONCRETE SIDEWALK WITH BOX CANAL DETAIL	DRAWN BY: GOME DATE: 08/02/2011 CHECKED BY: ANSELMO M. NERA, JR. DATE: 08/02/2011 SCALE: 1:100mm	SHEET NO. <b>S3</b> 07
	APPROVED BY: 	APPROVED BY: 	ATT: JAMES O. ALBINA CIVIL ENGINEER, R.P. REG. NO. 101-107494	APPROVED BY: 				

